



PLASMA CENTRAL ADAPTORS



If you want to connect a TIG or Plasma torch quickly and safely, the only solution is the Trafimet central adaptor system, the best currently on the market:

- a plastic central body on which 9 different contacts can be mounted
- a brass pin for the passage of current/gas or air
- excellent insulation from high frequency current.

The Plasma central adaptor system - Trafimet patent - also guarantees compliance with the European standard and has unbeatable external dimensions.

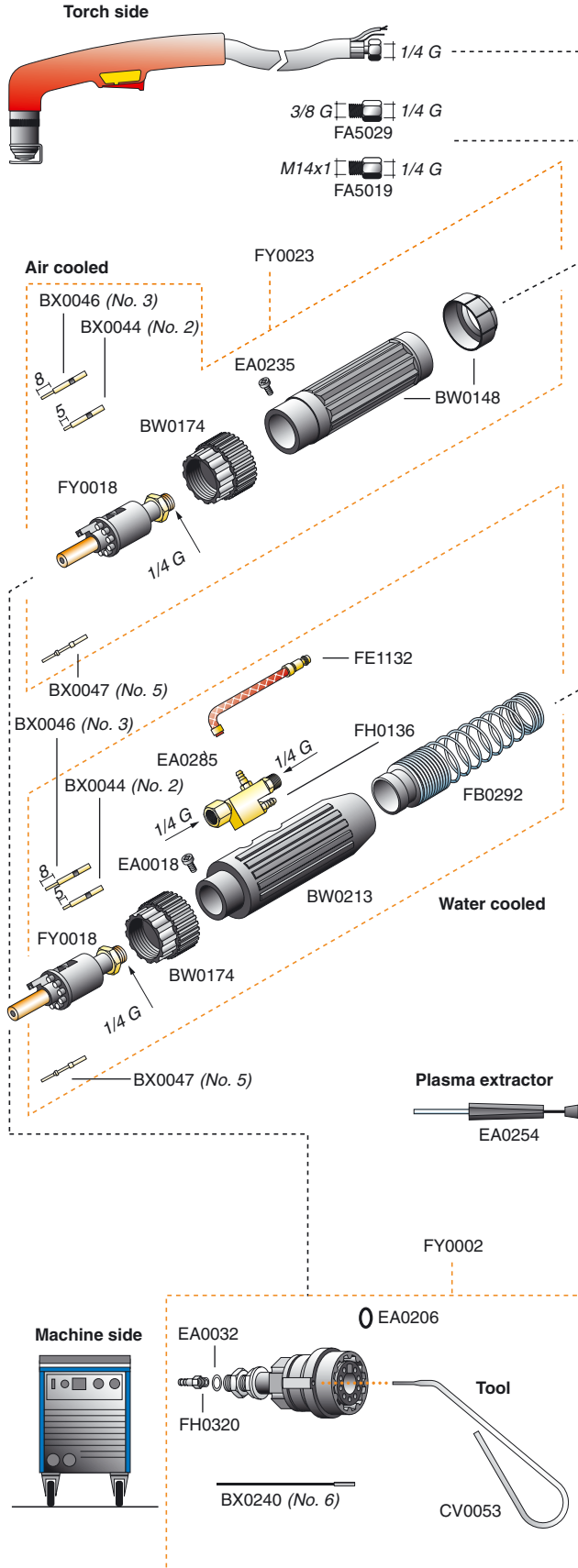

Pt. No.	Description	Pack	Euro	D
BW0148	Back box for central adaptor	1	7,80	B
BW0174	Plastic housing	1	4,20	B
BW0213	Back box	1	9,50	B
BX0044	Pin for central adaptor	10	1,60	A
BX0046	Pin for central adaptor	10	1,60	A
BX0047	Pin for central adaptor	10	1,30	A
BX0240	Female contact	10	1,40	B
CV0053	Electrode / tip wrench	1	6,50	A
EA0018	Screw	50	0,30	B
EA0032	Screw	50	0,55	B
EA0206	O-ring	10	0,45	A
EA0235	Screw	10	0,35	A
EA0254	Pins extractor	1	65,00	A
EA0285	Hose clamp Ø 10,5	10	1,10	A
FA5019	Reduction M14x1 - 1/4G	1	5,50	B
FA5029	Reduction 3/8G - 1/4G	1	5,50	B
FB0292	Support with spring	1	8,30	B
FE1132	Gas hose + quick connector	1	6,00	B
FH0136	Adaptor	1	34,00	B
FH0320	Insulator	10	2,00	B
FY0018	Male central adaptor 5 pins	1	20,50	A
FY0022	Female central adaptor	1	42,50	A
FY0023	Male central adaptor	1	26,50	A
PT0024	Plasma central adaptor PW 180	1	78,00	B

Plasma Range

trafimet®



Plasma torches with air striking, without high frequency.

Trafimet is proud to present the new range of compressed air plasma torches with striking of the pilot arc without high frequency.

Since 1990 Trafimet has always believed in these torches which have a patented striking system that offers considerable advantages such as:

Plasma Range



- Less electromagnetic disturbance, with consequent absence of problems for any electronic, radio, television, telephone and computer systems in the vicinity of the cutting positions

- Greater simplicity in the design and production of generators for plasma cutting

- Less electric stress on the torch - and on the respective connecting cables - due to the absence of the high voltage necessary for striking the arc

- Greater simplicity in comparison with other torches (without high frequency) on the market, with a consequent decrease of the risks of jamming in the mechanical-pneumatic movement for striking the arc

- A distinct improvement in the duration of the components subject to wear (electrodes, tips, nozzles, diffusers etc.), thanks to the better cooling of the torch obtained by reducing the insulating thicknesses (without endangering the safety parameters)

- A striking new design, together with an improved ergonomic handle, makes use of the torch easier and more relaxing

- A new mechanical safety device - in the operation of the trigger - together with the existing electrical safety device has made these torches some of the safest and most reliable on the market.



ERGO-CUT S 25K
ERGO-CUT S 25



ERGO-CUT S 45



ERGO-CUT S 75



ERGO-CUT S 105

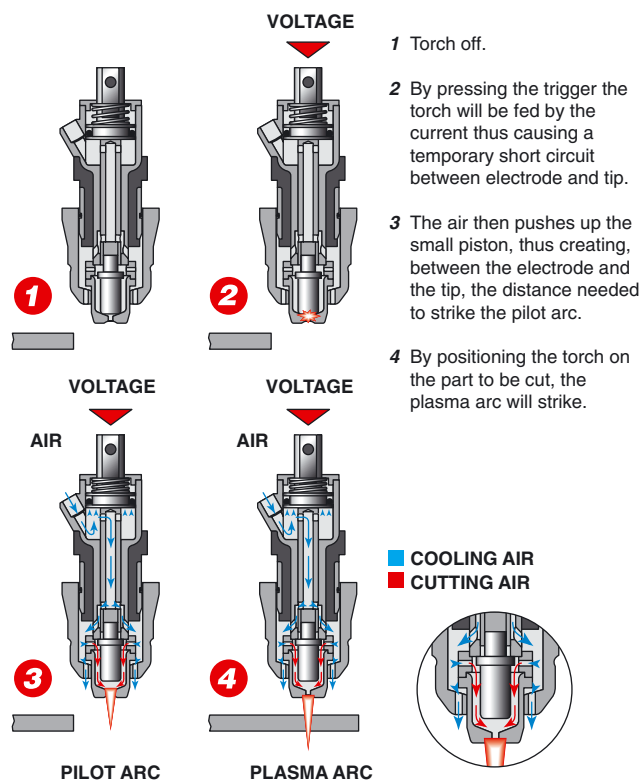



ERGOCUT S 25K - S 25

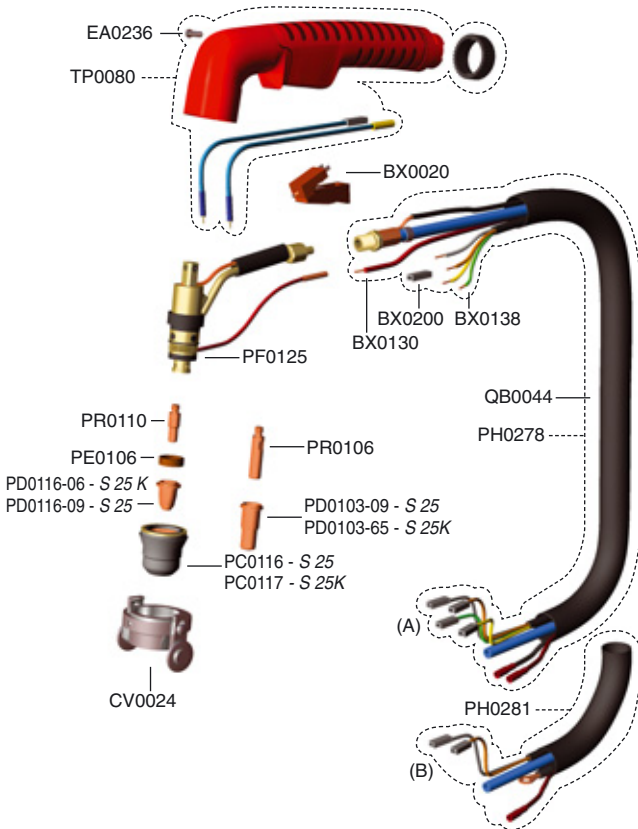

COMPLETE TORCH S 25K - S 25					
Pt. No.	Description	Pack	Euro	D	
PA0370	Plasma S 25K torch 4m (A) - FRM	1	185,00	A	
PA0375	Plasma S 25 torch 4m (B) - TL	1	200,00	B	
PA0376	Plasma S 25K torch 4m (B) - TL	1	200,00	B	

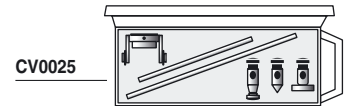

TECHNICAL DATA	S 25K	S 25
Voltage class	M	M
Standard length m	4	4
Air consumption	31 l/min	95 l/min
Air pressure	2 bar	5 bar
Duty cycle 35%	20 A	
Duty cycle 60%		25 A
Air pressure switch		≥ 3.5 bar

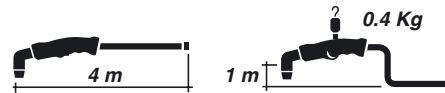

Pt. No.	Description	Pack	Euro	D
BX0020	Trigger	10	4,50	A
BX0130	Cable for pilot arc per meter		0,80	B
BX0138	Control cable per meter		2,50	B
BX0200	Female Trigger Wire Connector	10	1,00	B
CV0010	Stand off guide (743.0149/1394)	10	0,90	A
CV0024	Carriage S 30	1	22,50	A
CV0025	Circle cutting attachment S 30	1	58,00	A
EA0236	Screw	10	0,35	A
PC0116	Outside nozzle S 45	4	10,50	A
PC0117	Outside nozzle S 25K	4	11,00	
PD0103-09	Long Tip Ø 0,9	10	1,90	A
PD0103-65	Long Tip Ø 0,65	10	1,90	A
PD0116-06	Long Tip Ø 0,65 S 25 / S 45	10	1,85	A
PD0116-08	Long Tip Ø 0,8 S 25 / S 45	10	1,85	A
PE0106	Air diffuser S 45 / S 30 / S 54	2	9,50	A
PF0125	Torch head S 45	1	90,00	A
PH0278	Cable assembly 4m S 25K (A)	1	130,00	C
PH0281	Cable assembly 4m S 25 (B)	1	130,00	C
PR0106	Long Electrode S 54	10	2,00	A
PR0110	long electrode S 45	10	2,00	A
QB0044	Rubber Hose 14x16,5 per m		2,80	B
TP0080	Ergocut S 25 / S 45 handle	1	15,00	A

Ergocut S 25K is a low air consumption torch, specifically designed for generators with internal compressor.

The S25K is ideal for small carpentry and maintenance jobs, with cutting thicknesses up to 6mm.

Plasma Range

trafimet

ERGOCUT S 45



COMPLETE TORCH

Pt. No.	Description	Pack	Euro	D
PA0165	Plasma S 45 torch 6m 1/4G	1	185,00	A
PA0166	Plasma S 45 torch 6m central adaptor	1	210,00	A
PA0167	Plasma S 45 torch 4m 1/4G with separate voltage	1	185,00	B

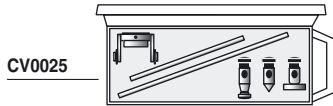

TECHNICAL DATA

Voltage class	M
Standard length m	4 • 6
Air consumption	115 l/min
Air pressure	5 bar
Duty cycle 60%	40 A
Air pressure switch	≥ 3.5 bar

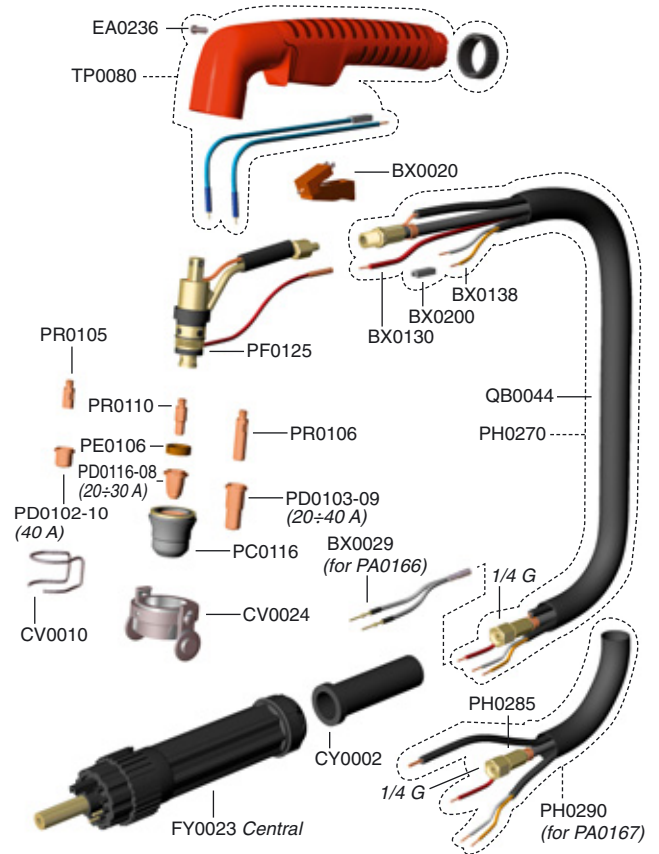
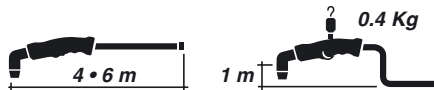

Pt. No.	Description	Pack	Euro	D
BX0020	Trigger	10	4,50	A
BX0029	Double plug for pilot arc S 45	1	8,50	
BX0130	Cable for pilot arc per meter		0,80	B
BX0138	Control cable per meter		2,50	B
BX0200	Female Trigger Wire Connector	10	1,00	B
CV0010	Stand off guide (743.0149/1394)	10	0,90	A
CV0024	Carriage S 30	1	22,50	A
CV0025	Circle cutting attachment S 30	1	58,00	A
CV0085	Flowmeter S45 / HY 40	1	4,50	A
CY0002	Cable Support	1	1,10	B
EA0236	Screw	10	0,35	A
FY0023	Male central adaptor	1	26,50	A
PC0116	Outside nozzle S 45	4	10,50	A
PD0103-09	Long Tip Ø 0,9	10	1,90	A
PD0103-65	Long Tip Ø 0,65	10	1,90	A
PD0116-06	Long Tip Ø 0,65 S 25 / S 45	10	1,85	A
PD0116-08	Long Tip Ø 0,8 S 25 / S 45	10	1,85	A
PD0116-09	Long Tip Ø 0,9 S 25 / S 45	10	1,85	A
PE0106	Air diffuser S 45 / S 30 / S 54	2	9,50	A
PF0125	Torch head S 45	1	90,00	A
PH0121	Air-power cable 6m 1/4	1	55,00	B
PH0270	Cable assembly 4m 1/4G S 30	1	130,00	B
PH0285	Air- current cable 4m 1/4G separate S 30	1	55,00	C
PH0290	Cable assembly 4m 1/4G separate S 30	1	130,00	C
PR0105	Electrode S 45	10	1,50	A
PR0106	Long Electrode S 54	10	2,00	A

Pt. No.	Description	Pack	Euro	D
PR0110	long electrode S 45	10	2,00	A
QB0044	Rubber Hose 14x16,5 per m		2,80	B
TP0080	Ergocut S 25 / S 45 handle	1	15,00	A

Plasma Range

trafimet



ERGO CUT S 75

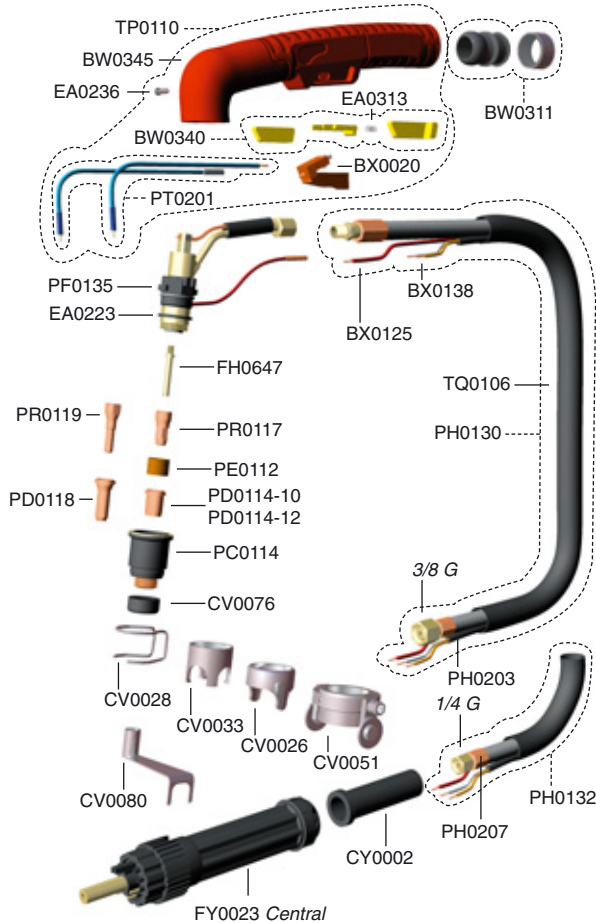

COMPLETE TORCH

Pt. No.	Description	Pack	Euro	D
PA1602	Plasma ERGO CUT Torch S 75 6m 3/8G	1	240,00	A
PA1604	Plasma ERGO CUT Torch S 75 6m central adaptor	1	270,00	A
PA1606	Plasma ERGO CUT Torch S 75 6m 1/4G	1	240,00	A

Patented spare parts

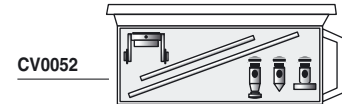

TECHNICAL DATA

Voltage class	M
Standard length m	6
Air consumption	150 l/min
Air pressure	5 bar
Duty cycle 60%	70 A
Duty cycle 100%	50 A

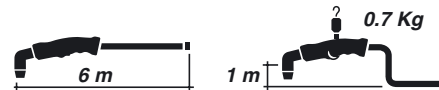

Pt. No.	Description	Pack	Euro	D
BW0311	Big joint with Ergotig / Ergocut ring	1	6,60	A
BW0340	Key safety trigger	1	10,00	A
BW0345	Ergocut handle	1	20,00	A
BX0020	Trigger	10	4,50	A
BX0125	Cable for pilot arc per meter		0,80	B
BX0138	Control cable per meter		2,50	B
CV0026	Two pin stand-off guide S 54 / A 80	2	6,50	A
CV0028	Stand off guide	10	1,00	A
CV0033	Four pins crown shield	2	6,50	A
CV0051	Carriage S 54 / S 75 / A 81	1	18,00	A
CV0052	Circle cutting attachment S 54 / S 75 / A 80	1	50,00	A
CV0076	Stand off guide	10	3,00	A
CV0080	Electrode / tip wrench	1	11,50	A
CV0086	Flowmeter S 75 / CB 70	1	4,50	A
CY0002	Cable Support	1	1,10	B
EA0223	O-ring	10	0,45	A
EA0236	Screw	10	0,35	A
EA0313	Spring	1	1,05	B
FH0647	Diffuser	10	3,20	B
FY0023	Male central adaptor	1	26,50	A
PC0114	Outside nozzle S 75	2	12,00	A
PD0114-10	Tip Ø 1,0 S 74-75	10	1,85	A
PD0114-12	Tip Ø 1,2 S 74-75	10	1,85	A
PD0118-10	Long Tip S 74-75	10	3,00	A
PE0112	Air diffuser S 75 / S 105	2	10,50	A
PF0135	Torch head ERGO CUT S 75	1	100,00	A

Pt. No.	Description	Pack	Euro	D
PH0130	Cable assembly 6m 3/8G	1	88,00	B
PH0132	Cable assembly 6m 1/4G	1	81,00	B
PH0203	Air-power cable 6m 3/8G	1	50,00	B
PH0207	Air-power cable 6m 1/4G	1	37,00	B
PR0117	Electrode S74-75-105	10	2,40	A
PR0119	Long electrode S 74-75	10	3,60	A
PT0201	ERGO CUT handle spring pins kit	1	7,50	A
TP0110	ERGO CUT S / A / CB kit handle	1	25,00	A
TQ0106	Outer cover 20x22 per m		1,60	B

Plasma Range

trafimet

AUTOCUT PS 105



COMPLETE TORCH

Pt. No.	Description	Pack	Euro	D
PA1682	Plasma ERGOCUT Torch PS 105 6m central adaptor	1	550,00	A
PA1684	Plasma ERGOCUT Torch PS 105 6m 1/4G	1	470,00	A

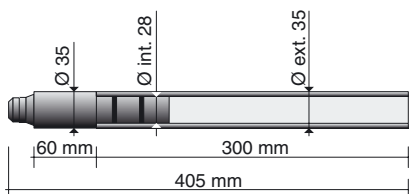

TECHNICAL DATA

Voltage class	M
Standard length m	6
Air consumption	180 l/min
Air pressure	5 bar
Duty cycle 60%	100 A
Duty cycle 100%	70 A

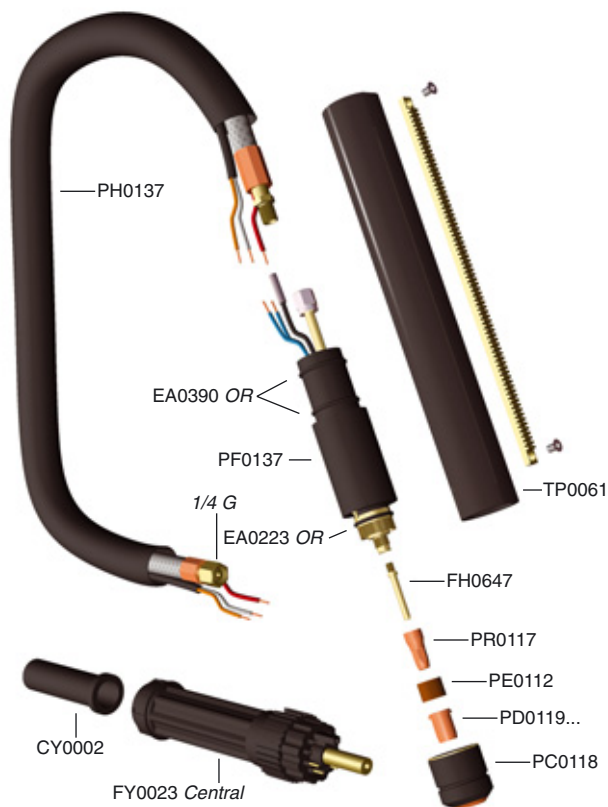
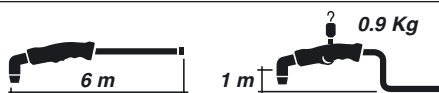

Pt. No.	Description	Pack	Euro	D
CY0002	Cable Support	1	1,10	B
EA0053	Screw	50	0,10	
EA0223	O-ring	10	0,45	A
EA0390	O-ring	10	0,50	
FH0647	Diffuser	10	3,20	B
FY0023	Male central adaptor	1	26,50	A
PC0118	Outside nozzle S 105	4	15,00	A
PD0119-10	Tip Ø 1,0 S 105	10	2,20	A
PD0119-12	Tip Ø 1,2 S 105	10	2,20	A
PD0119-14	Tip Ø 1,4 S 105	10	2,20	A
PE0112	Air diffuser S 75 / S 105	2	10,50	A
PF0137	Torch head ERGOCUT PS 105	1	160,00	
PH0137	Cable assembly 6m 1/4G PS105	1	81,00	B
PR0117	Electrode S74-75-105	10	2,40	A
TP0061	Handle	1	75,00	B

The first Trafimet automatic torch with air striking without high frequency.

As per the other torches of the "S" range, the striking without high frequency involves, as well as a series of remarkable advantages, less electromagnetic disturbance with consequent absence of problems for electronic control systems in automatic equipment.



ERGO CUT S 105

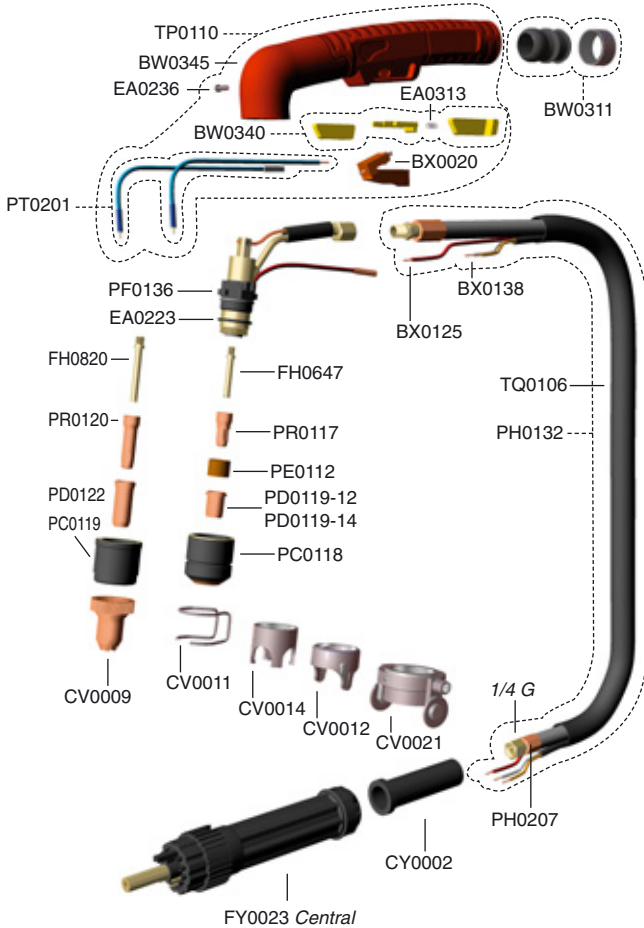
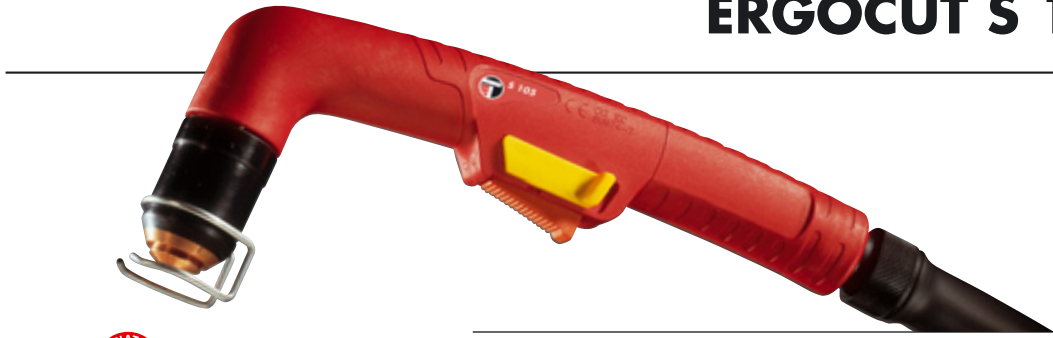

COMPLETE TORCH

Pt. No.	Description	Pack	Euro	D
PA1652	Plasma ERGO CUT Torch S 105 6m central adaptor	1	300,00	A
PA1654	Plasma ERGO CUT Torch S 105 6m 1/4G	1	270,00	A

Patented spare parts

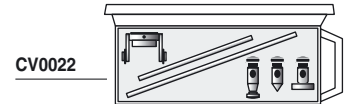

TECHNICAL DATA

Voltage class	M
Standard length m	6
Air consumption	180 l/min
Air pressure	5 bar
Duty cycle 60%	100 A
Duty cycle 100%	70 A

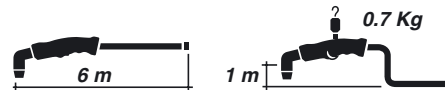

Pt. No.	Description	Pack	Euro	D
BW0311	Big joint with Ergotig / Ergocut ring	1	6,60	A
BW0340	Key safety trigger	1	10,00	A
BW0345	Ergocut handle	1	20,00	A
BX0020	Trigger	10	4,50	A
BX0125	Cable for pilot arc per meter		0,80	B
BX0138	Control cable per meter		2,50	B
CV0009	Long contact cutting attachment	10	9,50	A
CV0011	Stand off guide (1386)	10	0,95	A
CV0012	Two pins crown shield	2	7,00	A
CV0014	Four pins crown shield	2	6,50	A
CV0021	Carriage	1	22,50	A
CY0002	Cable Support	1	1,10	B
EA0223	O-ring	10	0,45	A
EA0313	Spring	1	1,05	B
FH0647	Diffuser	10	3,20	B
FH0820	Diffuser	10	6,40	B
FY0023	Male central adaptor	1	26,50	A
PC0118	Outside nozzle S 105	4	15,00	A
PD0119-12	Tip Ø 1,2 S 105	10	2,20	A
PD0119-14	Tip Ø 1,4 S 105	10	2,20	A
PD0122-12	Long Tip S 105	10	3,50	A
PE0112	Air diffuser S 75 / S 105	2	10,50	A
PF0136	Torch head ERGO CUT S 105	1	120,00	A
PH0132	Cable assembly 6m 1/4G A 81	1	81,00	B
PH0207	Air-power cable 6m 1/4G A 81	1	37,00	B
PR0117	Electrode S74-75-105	10	2,40	A

Pt. No.	Description	Pack	Euro	D
PR0120	Long electrode S 105	10	3,75	A
PT0201	ERGO CUT handle spring pins kit	1	7,50	A
TP0110	ERGO CUT S / A / CB kit handle	1	25,00	A
TQ0106	Outer cover 20x22 per m		1,60	B

Plasma Range

trafimct®



Plasma Torches with high frequency striking.

The ERGO CUT family, developed in 1998 with the aim of innovating the range of torches for plasma cutting, is enriched today with a new line of models that will cover the sector between 80 and 150 Amperes. The realisation of the project has been accompanied by the invaluable collaboration of some end users who, with their advice, have enabled us to focus our attention on the particular needs of those who really work with torches for plasma cutting.

The principal novelty of this line of torches is the integration of all the models - from 80 to 150 Amperes - in a single handle.

This has allowed us to standardise the components and optimise the use of the materials.

REPARABILITY

In the event of damage to the air guide pipe, during cutting or during operations for changing the spare parts, it is now possible to replace it without having to buy the complete torch head.

VERSATILITY

The introduction of the air guide pipe allows the operator to use different types of spare parts proposed by manufacturers, always guaranteeing the respect of the work conditions established by them. The ability to replace the air guide pipe in fact allows it to be adapted to the type of electrode used, whether it be of the normal or elongated type, and therefore to achieve, in any cutting configuration, the best possible cooling of the electrode with a distinct increase of its duration.

Plasma Range

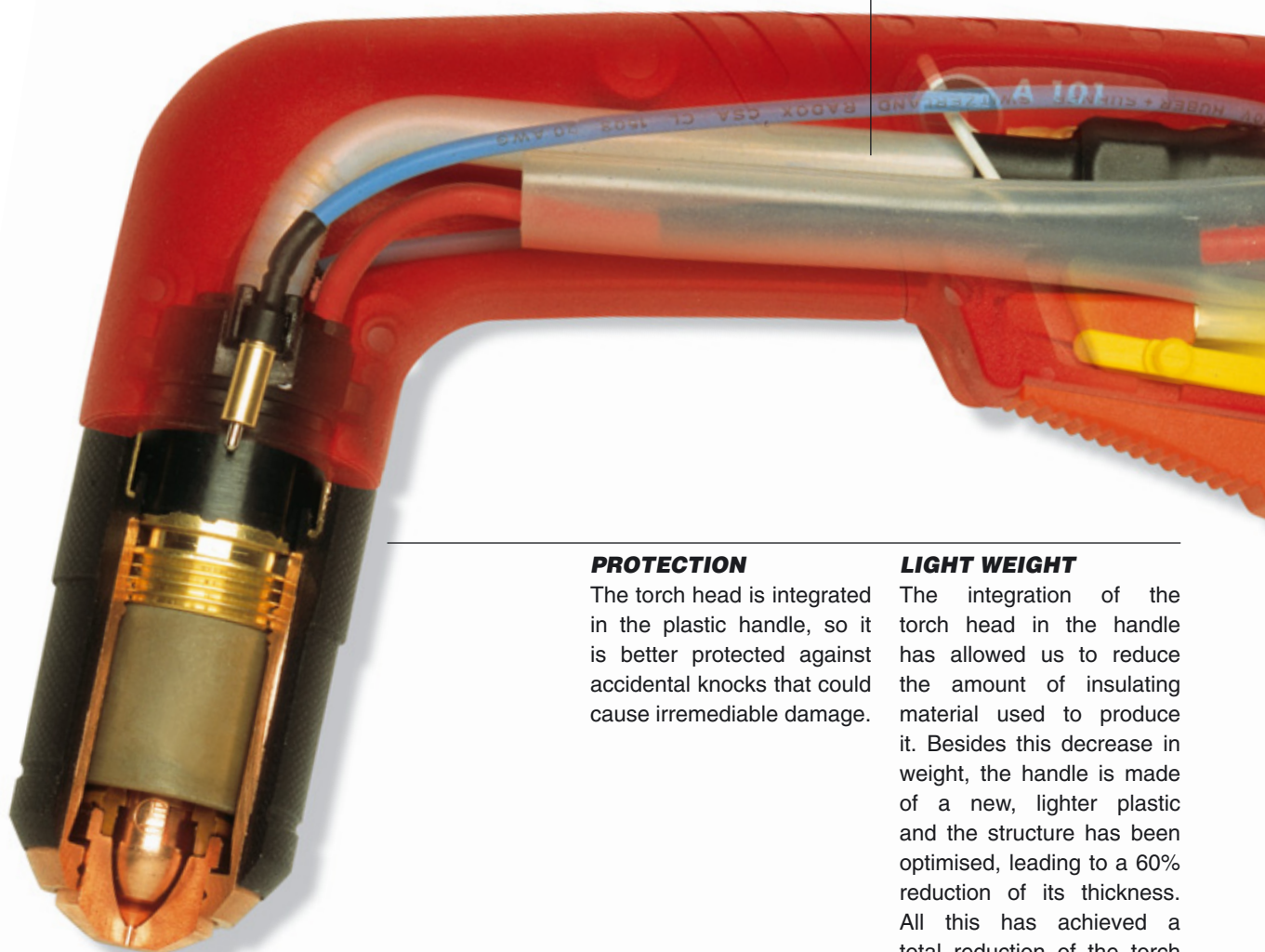

PROTECTION

The torch head is integrated in the plastic handle, so it is better protected against accidental knocks that could cause irremediable damage.

LIGHT WEIGHT

The integration of the torch head in the handle has allowed us to reduce the amount of insulating material used to produce it. Besides this decrease in weight, the handle is made of a new, lighter plastic and the structure has been optimised, leading to a 60% reduction of its thickness. All this has achieved a total reduction of the torch weight, which is between 20 and 40% less than the previous version.

Each torch body in the ERGO CUT family maintains complete interchangeability of the spare parts used on the previous version.



ERGO CUT series A



AIR COOLED

WATER COOLED

STANDARD

The trigger used in the handle is the same one widely used in MIG torches; the retaining screws and ball-and-socket joints are the same as in the ERGOTIG series.

SEAL

To provide an effective barrier against the entrance of cutting dust inside the handle, the seal of the couplings of the two shells has been increased with a longer labyrinth. An O-Ring fitted around the torch head prevents any dust from getting in at the front.

THE NEW HANDLE

The new ERGO CUT handle, made of two plastic shells, has been conceived with the aim of offering the operator a safer and more ergonomic work tool, while maintaining the proverbial sturdiness and reliability that have always characterised the TRAFIMET range of plasma torches.



ERGO CUT A 81



ERGO CUT A 101



ERGO CUT A 141



ERGO CUT A 151



ERGONOMICS

This handle model, already trialed with the first ERGO CUT models, has had its dimensions revised so as to be able to hold larger torch bodies. Particular attention has been dedicated to the study of the grip so as to allow any hand to find the best position for balancing the weight between the front (torch head + spares) and the rear (cable).

SAFETY

To reduce the amount of heat striking the hand of the operator and to protect it better against cutting splashes, the grip has been moved back a few centimetres, obtaining a considerable reduction of temperature in the area of the trigger.



ERGO CUT PW 180

The introduction of the ball-and-socket joint in the handle has considerably improved the ease of handling the torch which is less affected by the weight exerted by the power cable.



KEY SAFETY TRIGGER

Simple - immediate - reliable
- evident - ambidextrous > these are the characteristics of the new safety device installed by Trafimet on ERGOCUT torches for plasma cutting, considering the more pressing demands for safety in the place of work.

The Key Safety Trigger protects the operator against accidental or involuntary striking of the torch. Before pressing the trigger the operator must pull back the Key Safety Trigger and only in this way can he release the movement of the torch trigger. Once the job has been done, the Key Safety Trigger resets automatically.

There is not only one way for working the Key Safety Trigger... each operator can work it with the maximum freedom in whatever way suits him best, without necessarily being tied to a determined position or a specific movement.



ELECTRICAL SAFETY

The spring pins, which control electrical safety with the nozzle open, are no longer built into the torch body but inserted in the handle. So, to change a single pin, it is no longer necessary to replace the whole torch head. At this point, considering the ease with which repairs may be carried out and the minimum costs involved, there is no sense in tampering with the electrical circuit in order to save buying a complete torch head, all to the advantage of safety.



ERGOCUT torches updating Kit.

The updating kit allows the replacement of a damaged torch body of any torch with one of the ERGOCUT series with the same power (Amperes).

The Kit comprises:

- Torch head of the equivalent model
S 75 - S 105 - A 81 - A 101 - A 141 - A 151
- CB 100 - CB 150
- Handle (right and left shell)
- Rear ball-and-socket joint
- Safety spring pins cables
- Retaining screws
- Torch trigger
- Key Safety Trigger
- Assembly instructions.

ERGOCUT	Pt. No.	Description	Pack	Euro	D
ERGOCUT S 75	PT0180	S 74 complete kit	1	125,00	B
ERGOCUT S 105	PT0190	S 105 complete kit	1	150,00	B
ERGOCUT A 81	PT0200	A 80 complete kit	1	110,00	B
ERGOCUT A 101	PT0210	A 90 complete kit	1	135,00	B
ERGOCUT A 141	PT0220	A 140 complete kit	1	185,00	B
ERGOCUT A 151	PT0230	R 145 complete kit	1	230,00	B
ERGOCUT CB 100	PT0240	CB 100 complete kit	1	140,00	B
ERGOCUT CB 150	PT0250	CB 150 complete kit	1	150,00	B

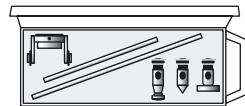

CIRCLE CUTTING ATTACHMENT

FLOWMETER

PLASMA TORCH	Pt. No.	Description	Euro	D	Pt. No.	Description	Euro	D
ERGOCUT S 45	CV0025	1	58,00	A	CV0085	1	4,50	A
ERGOCUT S 75	CV0052	1	50,00	A	CV0088	1	4,50	A
ERGOCUT S 105	CV0022	1	58,00	A	CV0088	1	4,50	A
ERGOCUT A 81	CV0052	1	50,00	A	CV0087	1	4,50	A
ERGOCUT A 101	CV0022	1	58,00	A	CV0088	1	4,50	A
ERGOCUT A 141	CV0022	1	58,00	A	CV0089	1	4,50	A
ERGOCUT A 151	CV0022	1	58,00	A	CV0090	1	4,50	A
ERGOCUT PW 180	CV0022	1	58,00	A	CV0091	1	4,50	A
ERGOCUT CB 50	CV0036	1	52,00	A	CV0092	1	4,50	A
ERGOCUT CB 70	CV0074	1	52,00	A	CV0086	1	4,50	A
ERGOCUT CB 100	CV0022	1	58,00	A	CV0094	1	4,50	A
ERGOCUT CB 150	CV0022	1	58,00	A	CV0094	1	4,50	A
CB 50	CV0036	1	52,00	A	CV0092	1	4,50	A
CB 70	CV0074	1	52,00	A	CV0086	1	4,50	A
CB 100	CV0022	1	58,00	A	CV0094	1	4,50	A
CB 150	CV0022	1	58,00	A	CV0094	1	4,50	A
HY 40	CV0060	1	55,00	B	CV0085	1	4,50	A
HY 100	CV0058	1	52,00	B	CV0088	1	4,50	A

Plasma Range

trafimct®

AUTOCUT P 81



COMPLETE TORCH

Pt. No.	Description	Pack	Euro	D
PA0180	Plasma P 81 machine torch 6m	1	250,00	A
PA0181	Plasma P 81 machine torch 6m	1	270,00	A

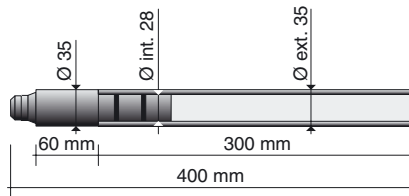

TECHNICAL DATA

Voltage class	M
Standard length m	6
Air consumption	155 l/min
Air pressure	5 bar
Duty cycle 60%	80 A
Duty cycle 100%	60 A

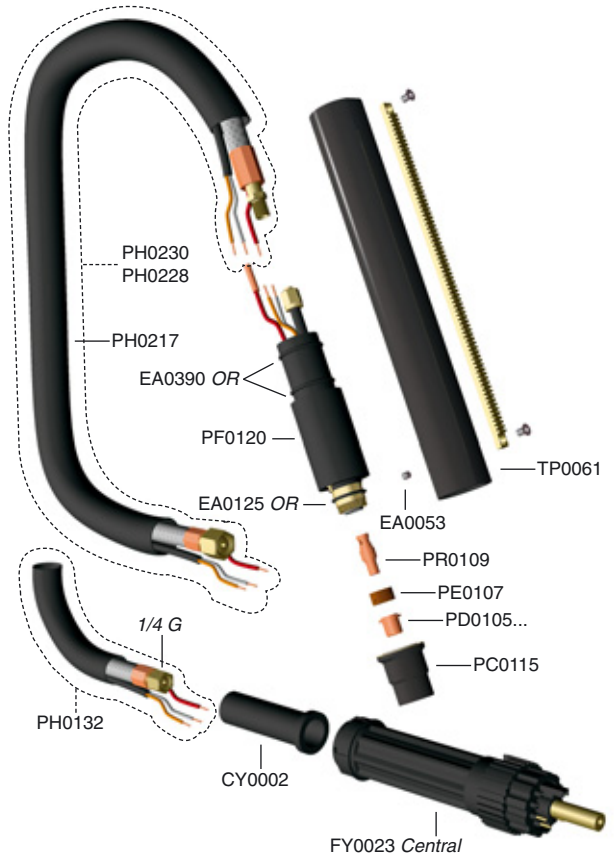
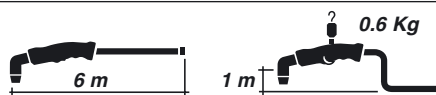

Pt. No.	Description	Pack	Euro	D
CY0002	Cable Support	1	1,10	B
EA0053	Screw	50	0,10	B
EA0125	O-ring	10	0,55	A
EA0390	O-ring	10	0,50	B
FY0023	Male central adaptor	1	26,50	A
PC0115	Outside nozzle S 54 / A 81	2	10,75	A
PD0105-10	Tip Ø 1,0 A 81	10	1,50	A
PD0105-12	Tip Ø 1,2 A 81	10	1,50	A
PE0107	Air diffuser A 81	2	10,50	A
PF0120	Torch head P 81	1	130,00	A
PH0132	Cable assembly 6m 1/4G A 81	1	81,00	B
PH0217	Outer cover 6m steel	1	155,00	C
PH0228	Cable assembly 6m 1/4G steel	1	260,00	C
PH0230	Cable assembly 6m 3/8G steel	1	260,00	C
PR0109	Long life electrode A 81	10	2,10	A
TP0061	Handle	1	75,00	B

The torch with high frequency switch-on for excellent performances.

Main characteristics:

- availability of short and extended parts
- a high performance long life electrode can be mounted - Trafimet patent -
- the design and realisation of the new "ERGO" handle, with more notable extras than previous ones:
 - a better - balanced grip and handle lightening, which makes it notably less tiring
 - improved ergonomics with a greater distance between the hand and the plasma arm, with consequent decreasing of exposure to heat
 - the ball joint - Trafimet patent - which gives excellent flexibility at the connection point between the cable and the handle
- DOUBLE ELECTRICAL AND MECHANICAL SAFETY.

Plasma Range

trafimet®



ERGOCUT A 81

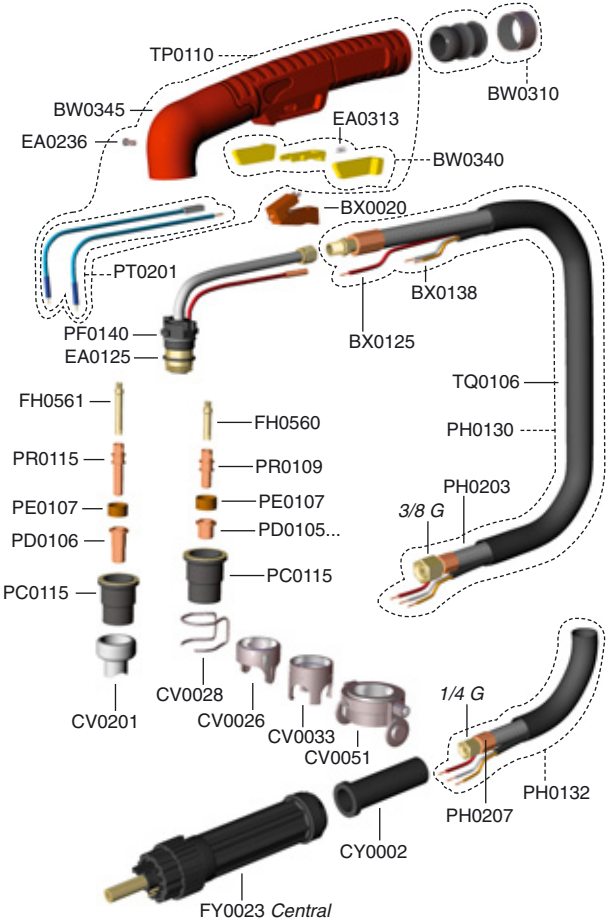

COMPLETE TORCH					
Pt. No.	Description	Pack	Euro	D	
PA1400	Plasma ERGOCUT Torch A 81 6m 3/8G	1	165,00	A	
PA1402	Plasma ERGOCUT Torch A 81 6m central adaptor	1	195,00	A	
PA1404	Plasma ERGOCUT Torch A 81 6m 1/4G	1	165,00	A	

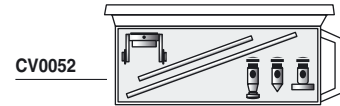

TECHNICAL DATA

Voltage class	M
Standard length m	6
Air consumption	155 l/min
Air pressure	5 bar
Duty cycle 60%	80 A
Duty cycle 100%	60 A

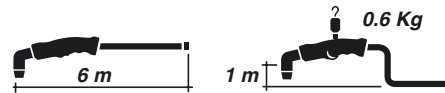

Pt. No.	Description	Pack	Euro	D
BW0310	Small joint with Ergotig / Ergocut ring	1	6,60	A
BW0340	Key safety trigger	1	10,00	A
BW0345	Ergocut handle	1	20,00	A
BX0020	Trigger	10	4,50	A
BX0125	Cable for pilot arc per meter		0,80	B
BX0138	Control cable per meter		2,50	B
CV0026	Two pin stand-off guide S 54 / A 80	2	6,50	A
CV0028	Stand off guide	10	1,00	A
CV0033	Four pins crown shield	2	6,50	A
CV0051	Carriage S 54 / S 75 / A 81	1	18,00	A
CV0052	Circle cutting attachment S 54 / S 75 / A 80	1	50,00	A
CV0087	Flowmeter A 81	1	4,50	A
CV0201	Long contact cutting attachment	1	4,00	A
CY0002	Cable Support	1	1,10	B
EA0125	O-ring	10	0,55	A
EA0236	Screw	10	0,35	A
EA0313	Spring	1	1,05	B
FH0560	Diffuser	1	2,50	A
FH0561	Long diffuser	1	3,00	A
FY0023	Male central adaptor	1	26,50	A
PC0115	Outside nozzle S 54 / A 81	2	10,75	A
PD0105-10	Tip Ø 1,0 A 81	10	1,50	A
PD0105-12	Tip Ø 1,2 A 81	10	1,50	A
PD0106	Long tip Ø 1,2 A 81	10	2,20	A
PE0107	Air diffuser A 81	2	10,50	A
PF0140	Torch head ERGOCUT A 81	1	90,00	A

Pt. No.	Description	Pack	Euro	D
PH0130	Cable assembly 6m 3/8G	1	88,00	B
PH0132	Cable assembly 6m 1/4G A 81	1	81,00	B
PH0203	Air-power cable 6m 3/8G	1	50,00	B
PH0207	Air-power cable 6m 1/4G A 81	1	37,00	B
PR0109	Long life electrode A 81	10	2,10	A
PR0115	Long Electrode A 81 long life	10	3,40	A
PT0201	ERGOCUT handle spring pins kit	1	7,50	A
TP0110	ERGOCUT S / A / CB kit handle	1	25,00	A
TQ0106	Outer cover 20x22 per m		1,60	B

Plasma Range

trafimct

AUTOCUT P 101



COMPLETE TORCH

Pt. No.	Description	Pack	Euro	D
PA0110	Plasma P 101 machine torch 6m	1	355,00	A
PA0111	Plasma P 101 machine torch 6m central adaptor	1	385,00	A

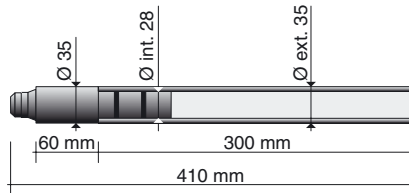

TECHNICAL DATA

Voltage class	M
Standard length m	6
Air consumption	180 l/min
Air pressure	5 bar
Duty cycle 60%	100 A
Duty cycle 100%	75 A

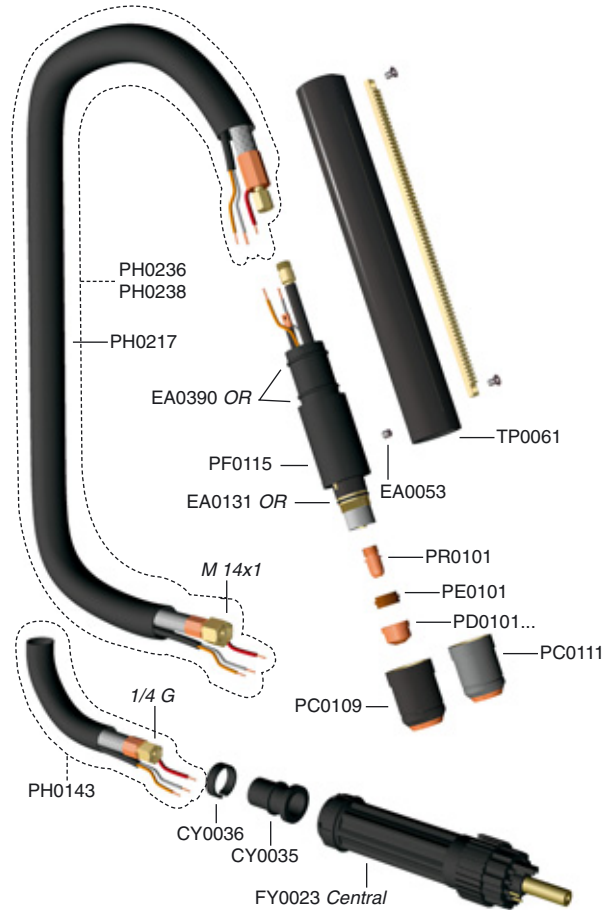
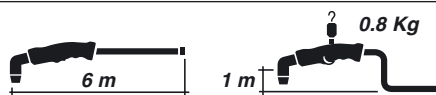

Pt. No.	Description	Pack	Euro	D
CY0002	Cable Support	1	1,10	B
EA0053	Screw	50	0,10	B
EA0131	O-ring	10	0,50	A
EA0390	O-ring	10	0,50	B
FY0023	Male central adaptor	1	26,50	A
PC0109	Outside nozzle A 101	2	15,00	A
PC0111	Heavy Duty nozzle A 101	2	19,00	A
PD0101-11	Tip Ø 1,1 A 101 / A 141	10	1,75	A
PD0101-14	Tip Ø 1,4 A 101 / A 141	10	1,75	A
PD0101-17	Tip Ø 1,7 A 101 / A 141	10	1,75	A
PD0101-19	Tip Ø 1,9 A 101 / A 141	10	1,75	A
PE0101	Air diffuser A 101 / A 141	2	10,00	A
PF0115	Torch head P 101	1	161,00	A
PH0143	Cable assembly 6m central adaptor	1	93,00	B
PH0217	Outer cover 6m steel	1	155,00	C
PH0236	Cable assembly 6m M 14x1 steel P 101	1	260,00	C
PH0238	Cable assembly 6m 1/4 G steel	1	260,00	C
PR0101	Electrode A 101 / A 141	10	1,85	A
TP0061	Handle	1	75,00	B

The evolution of the A 90, the most widespread Trafimet torch in the world.

Main characteristics:

- wide range of accessories
- the design and realisation of the new "ERGO" handle, with more notable extras than previous ones:
 - a better - balanced grip and handle lightening, which makes it notably less tiring
 - improved ergonomoy with a greater distance between the hand and the plasma arm, with consequent decreasing of exposure to heat
- the ball joint - Trafimet patent - which gives excellent flexibility at the connection point between the cable and the handle
- DOUBLE ELECTRICAL AND MECHANICAL SAFETY.

Plasma Range

trafimet®



ERGOCUT A 101

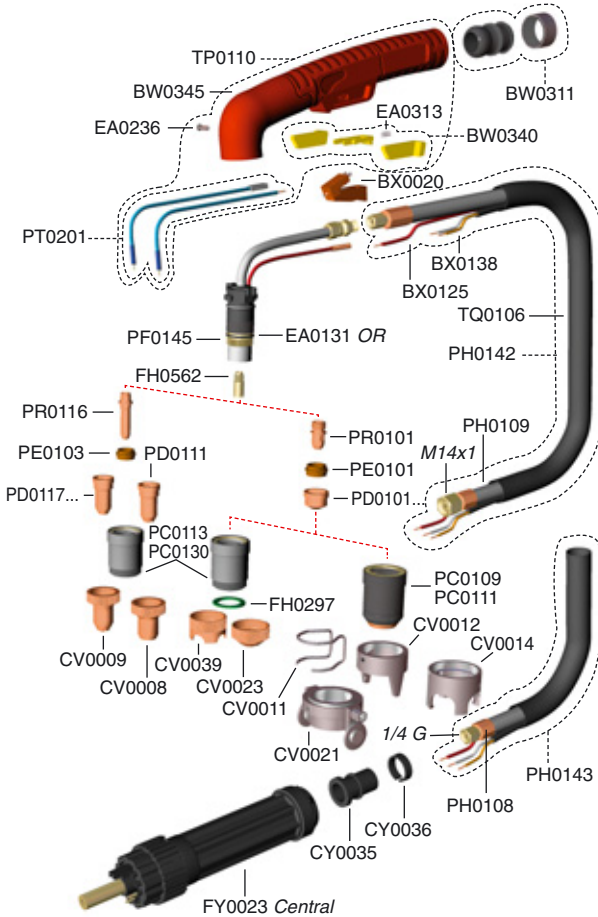

COMPLETE TORCH					
Pt. No.	Description	Pack	Euro	D	
PA1450	Plasma ERGOCUT Torch A 101 6m M14x1	1	250,00	A	
PA1452	Plasma ERGOCUT Torch A 101 6m central adaptor	1	280,00	A	
PA1454	Plasma ERGOCUT Torch A 101 6m 1/4G	1	250,00	A	

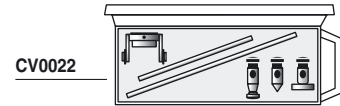

TECHNICAL DATA

Voltage class	M
Standard length m	6
Air consumption	180 l/min
Air pressure	5 bar
Duty cycle 60%	100 A
Duty cycle 100%	75 A

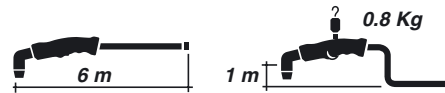

Pt. No.	Description	Pack	Euro	D
BW0311	Big joint with Ergotig / Ergocut ring	1	6,60	A
BW0340	Key safety trigger	1	10,00	A
BW0345	Ergocut handle	1	20,00	A
BX0020	Trigger	10	4,50	A
BX0125	Cable for pilot arc per meter		0,80	B
BX0138	Control cable per meter		2,50	B
CV0008	Contact cutting attachment	10	7,50	A
CV0009	Long contact cutting attachment	10	9,50	A
CV0011	Stand off guide (1386)	10	0,95	A
CV0012	TWO pins crown shield	2	7,00	A
CV0014	Four pins crown shield	2	6,50	A
CV0021	Carriage	1	22,50	A
CV0022	Circle cutting attachment	1	58,00	A
CV0023	Contact cutting attachment	10	7,90	A
CV0039	Four pins crown shield with insulator	2	8,50	A
CV0088	Flowmeter per A 101 / P101	1	4,50	A
CY0035	Cable Support	10	1,10	B
CY0036	Cable Support	10	0,80	B
EA0131	O-ring	10	0,50	A
EA0236	Screw	10	0,35	A
EA0313	Spring	1	1,05	B
FH0297	Insulator for Stand Off Guide CV0039	10	0,80	B
FH0562	Diffuser	1	2,50	A
FY0023	Male central adaptor	1	26,50	A
PC0109	Outside nozzle A 101	2	15,00	A
PC0111	Heavy Duty nozzle A 101	2	19,00	A

Pt. No.	Description	Pack	Euro	D
PC0113	Contact cutting nozzle A 101	2	12,00	A
PC0130	Contact cutting nozzle long life A 101	2	26,00	A
PD0101-11	Tip Ø 1,1 A 101 / A 141	10	1,75	A
PD0101-14	Tip Ø 1,4 A 101 / A 141	10	1,75	A
PD0101-17	Tip Ø 1,7 A 101 / A 141	10	1,75	A
PD0111	Long Tip A 101 / A 141	10	4,20	A
PD0117-14	Long Tip Ø 1,4 A 101 / A 141	10	3,95	A
PD0117-17	Long Tip Ø 1,7 A 101 / A 141	10	3,95	A
PD0117-19	Long Tip Ø 1,9 A 101 / A 141	10	3,95	A
PE0103	Air diffuser A 101 / A 141	2	10,00	A
PE0103	Air diffuser A 151	2	9,50	A
PF0145	Torch head ERGOCUT A 101	1	110,00	A
PH0108	Air-power cable 6m 1/4G	1	47,00	B
PH0109	Air-power cable 6m	1	47,00	B
PH0142	Cable assembly 6m M14x1	1	93,00	B
PH0143	Cable assembly 6m central adaptor	1	93,00	B
PR0101	Electrode A 101 / A 141	10	1,85	A
PR0116	Long Electrode A 141 / A 151	10	3,90	A
PT0201	ERGOCUT handle spring pins kit	1	7,50	A
TP0110	ERGOCUT S / A / CB kit handle	1	25,00	A
TQ0106	Outer cover 20x22 per m		1,60	B

Plasma Range

trafimct

AUTOCUT P 141



COMPLETE TORCH

Pt. No.	Description	Pack	Euro	D
PA0103	Plasma P 141 machine torch 6m	1	430,00	A
PA0104	Plasma P 141 machine torch 12m	1	520,00	C
PA0145	Plasma P 141 torch 6m central adaptor	1	470,00	A
PA0146	Plasma P 141 torch 12m central adaptor	1	550,00	C

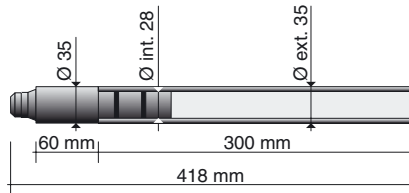

TECHNICAL DATA

Voltage class	M
Standard length m	6
Air consumption	210 l/min
Air pressure	5 bar
Duty cycle 60%	140 A
Duty cycle 100%	100 A

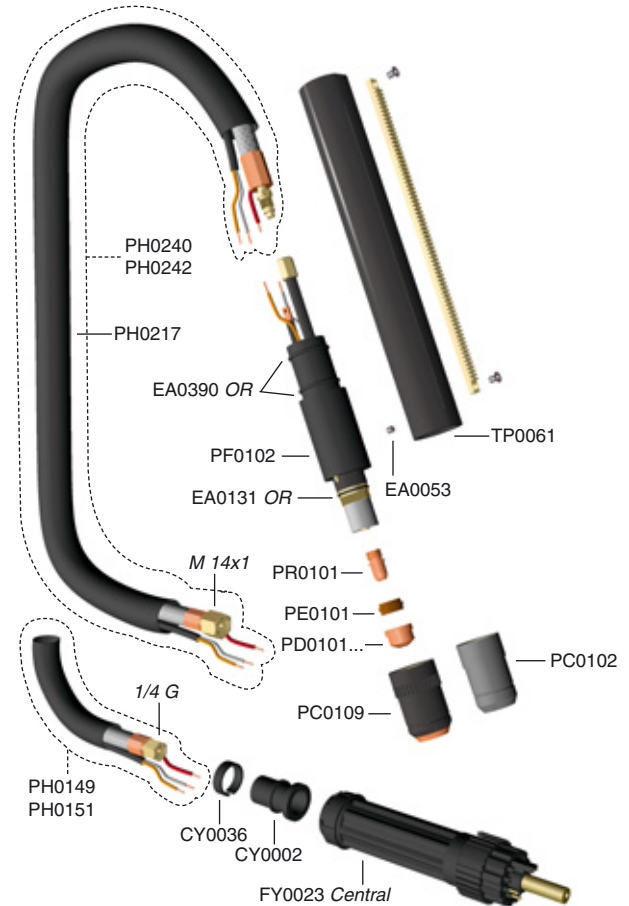
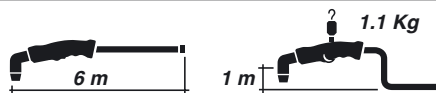

Pt. No.	Description	Pack	Euro	D
CY0035	Cable Support	10	1,10	B
CY0036	Cable Support	10	0,80	B
EA0053	Screw	50	0,10	B
EA0131	O-ring	10	0,50	A
EA0390	O-ring	10	0,50	B
FY0023	Male central adaptor	1	26,50	A
PC0101	Outside nozzle A 141	2	16,00	A
PC0102	Heavy Duty nozzle A 141	2	20,00	A
PD0101-11	Tip Ø 1,1 A 101 / A 141	10	1,75	A
PD0101-14	Tip Ø 1,4 A 101 / A 141	10	1,75	A
PD0101-17	Tip Ø 1,7 A 101 / A 141	10	1,75	A
PD0101-19	Tip Ø 1,9 A 101 / A 141	10	1,75	A
PE0101	Air diffuser A 101 / A 141	2	10,00	A
PF0102	Torch head P 141	1	212,00	A
PH0149	Cable assembly 6m central adaptor	1	104,00	B
PH0151	Cable assembly 12m central adaptor	1	181,00	C
PH0217	Outer cover 6m steel	1	155,00	C
PH0240	Cable assembly 6m M14x1 steel P 141	1	260,00	C
PH0242	Cable assembly 6m 1/4G steel	1	260,00	C
PR0101	Electrode A 101 / A 141	10	1,85	A
TP0061	Handle	1	75,00	B

The evolution of the A140, the best ratio between performance and price that is available on the market.

Main characteristics:

- wide range of accessories
- the design and realisation of the new "ERGO" handle, with more notable extras than previous ones:
 - a better - balanced grip and handle lightening, which makes it notably less tiring
 - improved ergonomics with a greater distance between the hand and the plasma arm, with consequent decreasing of exposure to heat
- the ball joint - Trafimet patent - which gives excellent flexibility at the connection point between the cable and the handle
- DOUBLE ELECTRICAL AND MECHANICAL SAFETY.

Plasma Range

trafimet®



ERGO CUT A 141

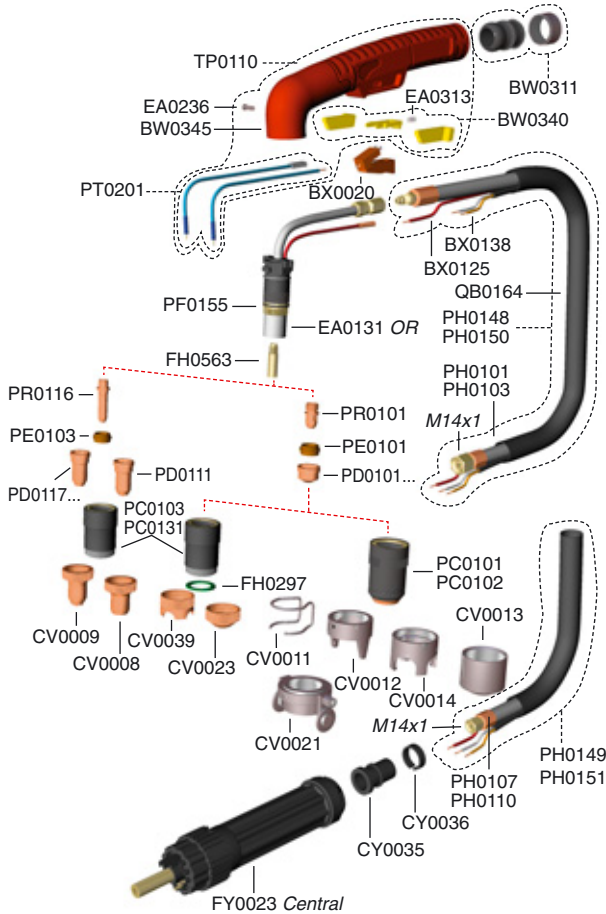

COMPLETE TORCH

Pt. No.	Description	Pack	Euro	D
PA1500	Plasma ERGO CUT Torch A 141 6m M14x1	1	280,00	A
PA1501	Plasma ERGO CUT Torch A 141 12m M14x1	1	350,00	A
PA1502	Plasma ERGO CUT Torch A 141 6m 1/4G	1	280,00	A
PA1504	Plasma ERGO CUT Torch A 141 6m central adaptor	1	310,00	A
PA1505	Plasma ERGO CUT Torch A 141 12m central adaptor	1	380,00	A

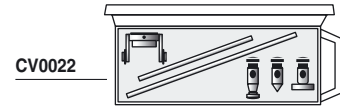

TECHNICAL DATA

Voltage class	M
Standard length m	6
Air consumption	210 l/min
Air pressure	5 bar
Duty cycle 60%	140 A
Duty cycle 100%	100 A

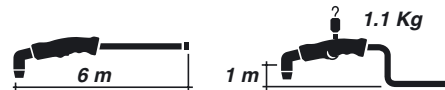

Pt. No.	Description	Pack	Euro	D
BW0311	Big joint with Ergotig / Ergocut ring	1	6,60	A
BW0340	Key safety trigger	1	10,00	A
BW0345	Ergocut handle	1	20,00	A
BX0125	Cable for pilot arc per meter		0,80	B
BX0138	Control cable per meter		2,50	B
CV0008	Contact cutting attachment	10	7,50	A
CV0009	Long contact cutting attachment	10	9,50	A
CV0011	Stand off guide (1386)	10	0,95	A
CV0012	TWO pins crown shield	2	7,00	A
CV0013	Gouging shield	2	6,50	A
CV0014	Four pins crown shield	2	6,50	A
CV0021	Carriage	1	22,50	A
CV0022	Circle cutting attachment	1	58,00	A
CV0023	Contact cutting attachment	10	7,90	A
CV0039	Four pins crown shield with insulator	2	8,50	A
CV0089	Flowmeter per A 141 / P 141	1	4,50	A
CY0035	Cable Support	10	1,10	B
CY0036	Cable Support	10	0,80	B
EA0131	O-ring	10	0,50	A
EA0236	Screw	10	0,35	A
EA0313	Spring	1	1,05	B
FH0297	Insulator for Stand Off Guide CV0039	10	0,80	B
FH0563	Diffuser	1	2,50	A
FY0023	Male central adaptor	1	26,50	A
PC0101	Outside nozzle A 141	2	16,00	A
PC0102	Heavy Duty nozzle A 141	2	20,00	A

Pt. No.	Description	Pack	Euro	D
PC0103	Contact cutting nozzle A 141	2	13,00	A
PC0131	Contact cutting nozzle long life A 141	2	29,00	A
PD0101-14	Tip Ø 1,4 A 101 / A 141	10	1,75	A
PD0101-17	Tip Ø 1,7 A 101 / A 141	10	1,75	A
PD0101-19	Tip Ø 1,9 A 101 / A 141	10	1,75	A
PD0101-30	Tip Ø 3,0 A 101 / A 141	10	1,75	A
PD0111	Long Tip A 101 / A 141	10	4,20	A
PD0117-14	Long Tip Ø 1,4 A 101 / A 141	10	3,95	A
PD0117-17	Long Tip Ø 1,7 A 101 / A 141	10	3,95	A
PD0117-19	Long Tip Ø 1,9 A 101 / A 141	10	3,95	A
PE0101	Air diffuser A 101 / A 141	2	10,00	A
PE0103	Air diffuser A 151	2	9,50	A
PF0155	Torch head ERGO CUT A 141	1	140,00	A
PH0101	Air-power cable 6m	1	50,00	B
PH0103	Air-power cable 12m M14x1	1	110,00	B
PH0107	Air-power cable 6m 1/4G	1	50,00	B
PH0110	Air-power cable 12m 1/4G	1	88,00	B
PH0148	Cable assembly 6m M14x1	1	104,00	B
PH0149	Cable assembly 6m central adaptor	1	104,00	B
PH0150	Cable assembly 12m M14x1	1	181,00	C
PH0151	Cable assembly 12m central adaptor	1	181,00	C
PR0101	Electrode A 101 / A 141	10	1,85	A
PR0116	Long Electrode A 141 / A 151	10	3,90	A
PT0201	ERGO CUT handle spring pins kit	1	7,50	A
QB0164	Outer protection liner A 140 per meter		4,20	B
TP0110	ERGO CUT S / A / CB kit handle	1	25,00	A

Plasma Range

trafimct

AUTOCUT P 151



COMPLETE TORCH

Pt. No.	Description	Pack	Euro	D
PA0127	Plasma P 151 machine torch 6m	1	470,00	A
PA0128	Plasma P 151 machine torch 12m	1	570,00	C

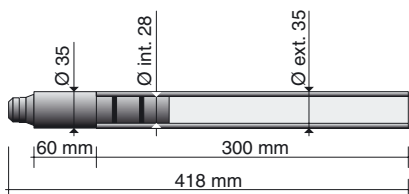

TECHNICAL DATA

Voltage class	M
Standard length m	6
Air consumption	230 l/min
Air pressure	5 bar
Duty cycle 60%	150 A
Duty cycle 100%	120 A

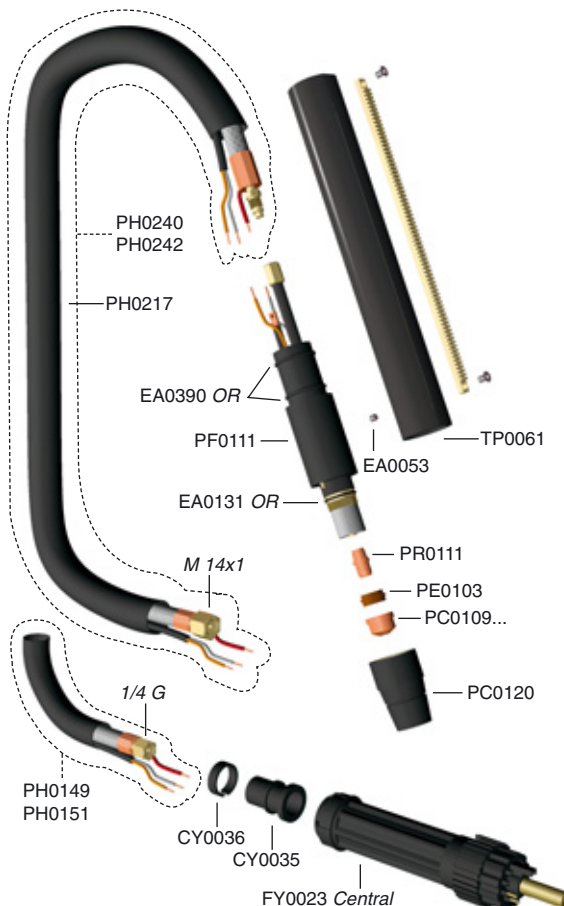
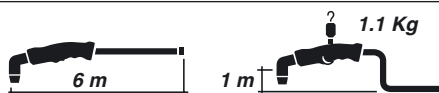

Pt. No.	Description	Pack	Euro	D
CY0035	Cable Support	10	1,10	B
CY0036	Cable Support	10	0,80	B
EA0053	Screw	50	0,10	B
EA0131	O-ring	10	0,50	A
EA0390	O-ring	10	0,50	B
FY0023	Male central adaptor	1	26,50	A
PC0120	Outside nozzle A 151	2	24,00	A
PD0109-14	Tip Ø 1,4	10	2,40	A
PD0109-16	Tip Ø 1,6	10	2,40	A
PD0109-18	Tip Ø 1,8	10	2,40	A
PE0103	Air diffuser A 151	2	9,50	A
PF0111	Torch head P 151	1	265,00	A
PH0149	Cable assembly 6m central adaptor	1	104,00	B
PH0151	Cable assembly 12m central adaptor	1	181,00	C
PH0217	Outer cover 6m steel	1	155,00	C
PH0240	Cable assembly 6m M14x1 steel P 141	1	260,00	C
PH0242	Cable assembly 6m 1/4G steel	1	260,00	C
PR0111	Electrode R145-A151	10	3,00	A
TP0061	Handle	1	75,00	B

The evolution of the R145, the air cooled plasma torch with maximum performance.

Main characteristics:

- wide range of accessories
- the design and realisation of the new "ERGO" handle, with more notable extras than previous ones:
 - a better - balanced grip and handle lightening, which makes it notably less tiring
 - improved ergonomics with a greater distance between the hand and the plasma arm, with consequent decreasing of exposure to heat
- the ball joint - Trafimet patent - which gives excellent flexibility at the connection point between the cable and the handle
- DOUBLE ELECTRICAL AND MECHANICAL SAFETY.

Plasma Range

trafimet®



ERGOCUT A 151

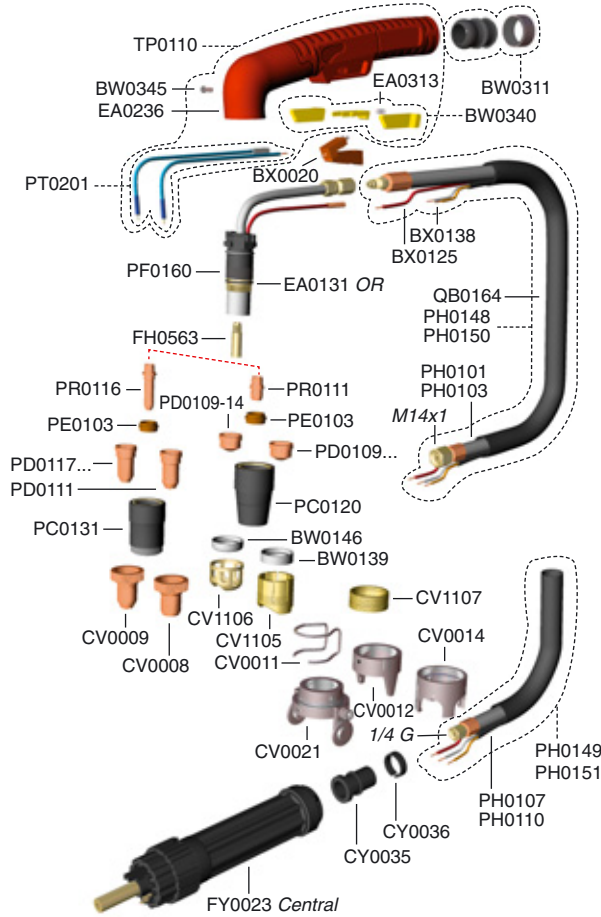

COMPLETE TORCH

Pt. No.	Description	Pack	Euro	D
PA1550	Plasma ERGOCUT Torch A 151 6m M14x1	1	300,00	A
PA1551	Plasma ERGOCUT Torch A 151 12m M14x1	1	370,00	A
PA1552	Plasma ERGOCUT Torch A 151 6m 1/4G	1	300,00	A
PA1554	Plasma ERGOCUT Torch A 151 6m central adaptor	1	330,00	A
PA1555	Plasma ERGOCUT Torch A 151 12m central adaptor	1	400,00	A

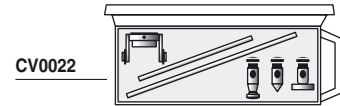

TECHNICAL DATA

Voltage class	M
Standard length m	6
Air consumption	230 l/min
Air pressure	5 bar
Duty cycle 60%	150 A
Duty cycle 100%	120 A

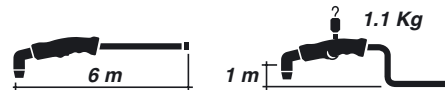

Pt. No.	Description	Pack	Euro	D
BW0139	Nozzle shield	10	2,50	B
BW0146	Nozzle Shield + Stand Off Guide	10	2,50	B
BW0311	Big joint with Ergotig / Ergocut ring	1	6,60	A
BW0340	Key safety trigger	1	10,00	A
BW0345	Ergocut handle	1	20,00	A
BX0125	Cable for pilot arc per meter		0,80	B
BX0138	Control cable per meter		2,50	B
CV0008	Contact cutting attachment	10	7,50	A
CV0009	Long contact cutting attachment	10	9,50	A
CV0011	Stand off guide (1386)	10	0,95	A
CV0012	TWO pins crown shield	2	7,00	A
CV0014	Four pins crown shield	2	6,50	A
CV0021	Carriage	1	22,50	A
CV0022	Circle cutting attachment	1	58,00	A
CV0090	Flowmeter A151	1	4,50	A
CV1105	Contact cutting attachment	10	8,50	B
CV1106	Stand off guide with tip	10	8,50	B
CV1107	Stand off guide	10	4,30	B
CY0035	Cable Support	10	1,10	B
CY0036	Cable Support	10	0,80	B
EA0131	O-ring	10	0,50	A
EA0236	Screw	10	0,35	A
EA0313	Spring	1	1,05	B
FH0563	Diffuser	1	2,50	A
FY0023	Male central adaptor	1	26,50	A
PC0120	Outside nozzle A 151	2	24,00	A

Pt. No.	Description	Pack	Euro	D
PC0131	Contact cutting nozzle long life A 141	2	29,00	A
PD0109-14	Tip Ø 1,4	10	2,40	A
PD0109-16	Tip Ø 1,6	10	2,40	A
PD0109-18	Tip Ø 1,8	10	2,40	A
PD0109-30	Tip Ø 3,0	10	2,40	A
PD0111	Long Tip A 101 / A 141	10	4,20	A
PD0117-14	Long Tip Ø 1,4 A 101 / A 141	10	3,95	A
PD0117-17	Long Tip Ø 1,7 A 101 / A 141	10	3,95	A
PD0117-19	Long Tip Ø 1,9 A 101 / A 141	10	3,95	A
PE0103	Air diffuser A 151	2	9,50	A
PF0160	Torch head ERGOCUT A 151	1	180,00	A
PH0101	Air-power cable 6m	1	50,00	B
PH0103	Air-power cable 12m M14x1	1	110,00	B
PH0107	Air-power cable 6m 1/4G	1	50,00	B
PH0110	Air-power cable 12m 1/4G	1	88,00	B
PH0148	Cable assembly 6m M14x1	1	104,00	B
PH0149	Cable assembly 6m central adaptor	1	104,00	B
PH0150	Cable assembly 12m M14x1	1	181,00	C
PH0151	Cable assembly 12m central adaptor	1	181,00	C
PR0111	Electrode R145-A151	10	3,00	A
PR0116	Long Electrode A 141 / A 151	10	3,90	A
PT0201	ERGOCUT handle spring pins kit	1	7,50	A
QB0164	Outer protection liner A 140 per meter		4,20	B
TP0110	ERGOCUT S / A / CB kit handle	1	25,00	A

Plasma Range

trafimct

PLASMA PW 180 P



COMPLETE TORCH

Pt. No.	Description	Pack	Euro	D
PB0005	Plasma PW 180P machine torch m6	1	1.150,00	A

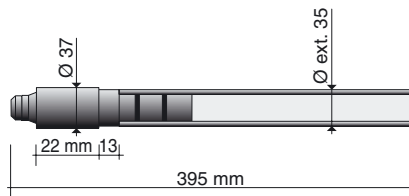

TECHNICAL DATA

Voltage class	M
Standard length m	6
Air consumption	38 l/min
Air pressure	4 bar
Duty cycle 100%	180 A
Air pressure switch	Water 1.4 l/min

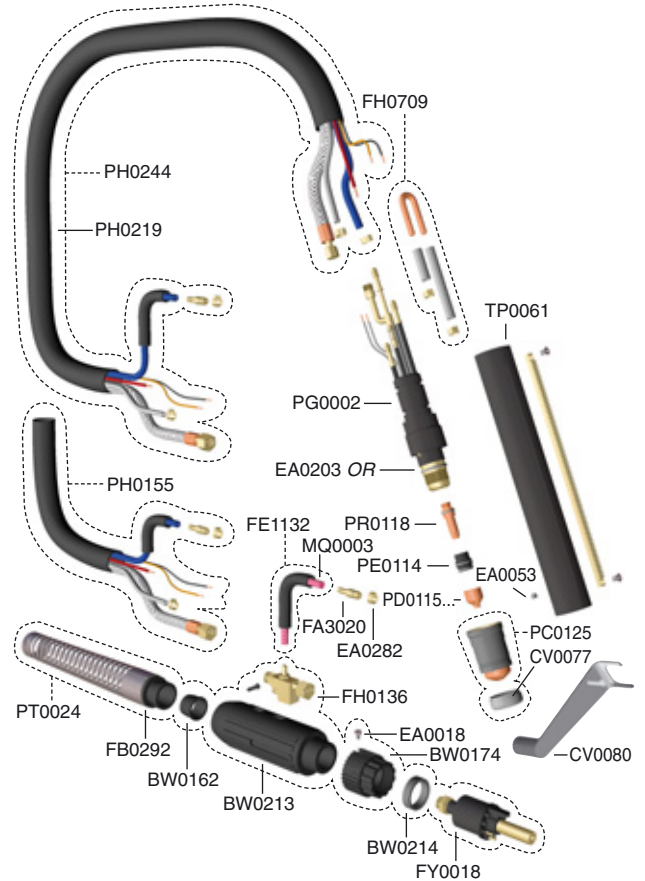
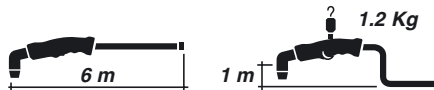

Pt. No.	Description	Pack	Euro	D
BW0162	Shield Bushing	10	2,10	B
BW0174	Plastic housing	1	4,20	B
BW0213	Back box	1	9,50	B
BW0214	Washer for stand-off guide	10	2,50	B
CV0077	Nozzle shield	10	5,00	A
CV0080	Electrode / tip wrench	1	11,50	A
EA0018	Screw	50	0,30	B
EA0053	Screw	50	0,10	B
EA0203	O-ring	10	0,45	A
EA0282	Double Hose Clamp Ø 9,5	10	1,10	A
FA3020	Quick connector water	10	1,50	B
FB0292	Support with spring	1	8,30	B
FE1132	Gas hose + quick connector	1	6,00	B
FH0136	Adaptor	1	34,00	B
FH0709	Water flowing Kit	1	13,00	B
FY0018	Male central adaptor 5 pins	1	20,50	A
MQ0003	Swan neck boot	10	1,00	B
PC0125	Outside nozzle PW 180	2	37,00	A
PD0115-12	Tip Ø 1,2 PW 180	10	4,50	A
PD0115-14	Tip Ø 1,4 PW 180	10	4,50	A
PD0115-16	Tip Ø 1,6 PW 180	10	4,50	A
PD0115-18	Tip Ø 1,8 PW 180	10	4,50	A
PD0115-20	Tip Ø 2,0 PW 180	10	4,50	A
PE0114	Air diffuser PW 180	2	45,00	A
PG0002	Torch head PW 180P	1	680,00	A
PH0155	Cable assembly 6m PW180	1	235,00	B

Pt. No.	Description	Pack	Euro	D
PH0219	Outer cover 6m steel PW 180P	1	155,00	C
PH0244	Cable assembly 6m steel PW 180P	1	310,00	C
PR0118	Electrode PW 180	10	6,20	A
PT0024	Plasma central adaptor PW 180	1	78,00	B
TP0061	Handle	1	75,00	B

PW180 - in the manual and automatic version - is a water cooled torch, suitable for heavy use which cannot be achieved with normal air cooled torches.

Because of the high temperatures reached in Plasma, this torch is the only alternative for continuous cutting, both manual and with automatic equipment, in a work cycle of 100% beyond 100 Amps.

Plasma Range

trafimet®



PLASMA PW 180



IEC 60974-7

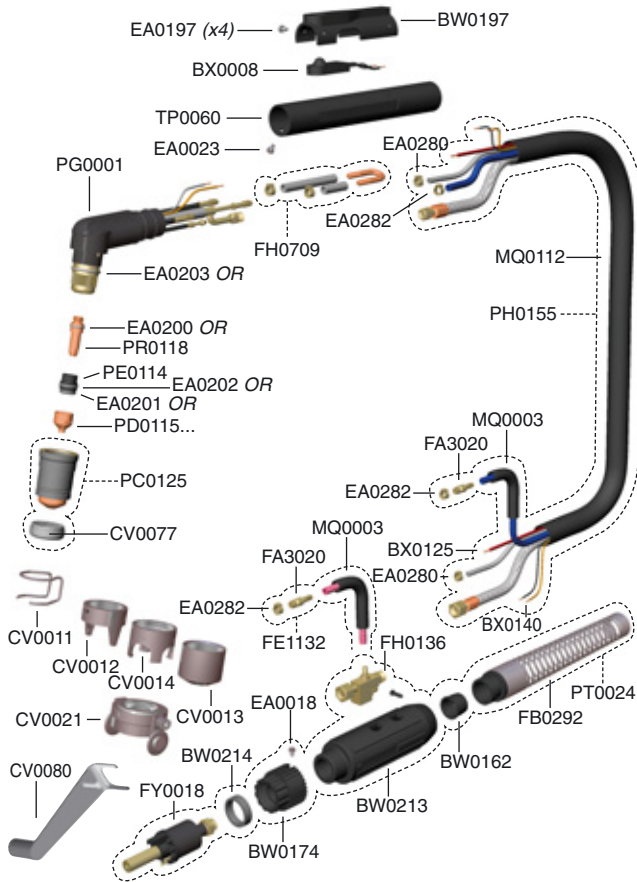

COMPLETE TORCH

Pt. No.	Description	Pack	Euro	D
PB0002	Plasma PW 180 torch m6	1	1.000,00	A

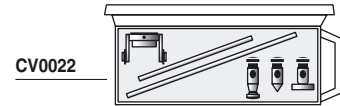

TECHNICAL DATA

Voltage class	M
Standard length m	6
Air consumption	38 l/min
Air pressure	4 bar
Duty cycle 100%	180 A
Air pressure switch	Water 1.4 l/min

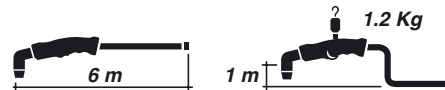

Pt. No.	Description	Pack	Euro	D
BW0162	Shield Bushing	10	2,10	B
BW0174	Plastic housing	1	4,20	B
BW0197	Trigger cover	1	16,00	B
BW0213	Back box	1	9,50	B
BW0214	Washer for stand-off guide	10	2,50	B
BX0008	Microswitch	10	18,00	A
BX0125	Cable for pilot arc per meter		0,80	B
BX0140	Double Cable 2,0x0,5 per m		1,20	B
CV0011	Stand off guide (1386)	10	0,95	A
CV0012	TWO pins crown shield	2	7,00	A
CV0013	Gouging shield	2	6,50	A
CV0014	Four pins crown shield	2	6,50	A
CV0021	Carriage	1	22,50	A
CV0022	Circle cutting attachment	1	58,00	A
CV0077	Nozzle shield	10	5,00	A
CV0080	Electrode / tip wrench	1	11,50	A
CV0091	Flowmeter PW 180	1	4,50	A
EA0018	Screw	50	0,30	B
EA0023	Screw	50	0,05	B
EA0197	Screw	10	0,80	A
EA0200	O-ring	10	0,15	A
EA0201	O-ring	10	0,50	A
EA0202	O-ring	10	0,25	A
EA0203	O-ring	10	0,45	A
EA0280	Double Hose Clamp Ø 8	10	1,10	A
EA0282	Double Hose Clamp Ø 9,5	10	1,10	A

Pt. No.	Description	Pack	Euro	D
FA3020	Quick connector water	10	1,50	B
FB0292	Support with spring	1	8,30	B
FE1132	Gas hose + quick connector	1	6,00	B
FH0136	Adaptor	1	34,00	B
FH0709	Water flowing Kit	1	13,00	B
FY0018	Male central adaptor 5 pins	1	20,50	A
MQ0003	Swan neck boot	10	1,00	B
MQ0112	Hose 28x30 per m		9,00	B
PC0125	Outside nozzle PW 180	2	37,00	A
PD0115-12	Tip Ø 1,2 PW 180	10	4,50	A
PD0115-14	Tip Ø 1,4 PW 180	10	4,50	A
PD0115-16	Tip Ø 1,6 PW 180	10	4,50	A
PD0115-18	Tip Ø 1,8 PW 180	10	4,50	A
PD0115-20	Tip Ø 2,0 PW 180	10	4,50	A
PD0115-30	Tip Ø 3,0 PW 180	10	4,50	A
PE0114	Air diffuser PW 180	2	45,00	A
PG0001	Torch head PW 180	1	520,00	A
PH0102	Air-power cable 6m 1/4G	1	55,00	B
PH0155	Cable assembly 6m PW180	1	235,00	B
PR0118	Electrode PW 180	10	6,20	A
PT0024	Plasma central adaptor PW 180	1	78,00	B
TP0060	Handle PW 180	1	75,00	B

Plasma Range

trafimct



ERGOCUT CB Plasma torches

ERGOCUT CB torches have fully earned their place in the second generation of Trafimet ERGOCUT torches: a range developed in collaboration with important Plasma Physics Institutes, with new performances, a new design and exceptionally compact dimensions. Also ERGOCUT CB torches, along with all the torches in the new series, are therefore distinguished for their innovative shape, ergonomic handle and the patented ball-and-socket joint to which is connected the patented external protective liner. They offer double safety: electrical safety on the outer nozzle and mechanical safety on the trigger, all patented by Trafimet.

A few special features of ERGOCUT CB torches:

- torch body protected by the outer handle
- highly flexible cables
- electrical safety devices built into the handle and easily replaceable, in the event of breakage, without having to change the whole torch body
- low cost of components
- dimensions and weight reduced up to 30% less than traditional torches
- option of fitting the Trafimet Central adaptor on all the torches.

Trafimet has also thought of users who already have a Trafimet torch: for each model, kits are available for transforming the old Trafimet torch into the new one, keeping the old cables.



CB 50



CB 100



CB 70



CB 150

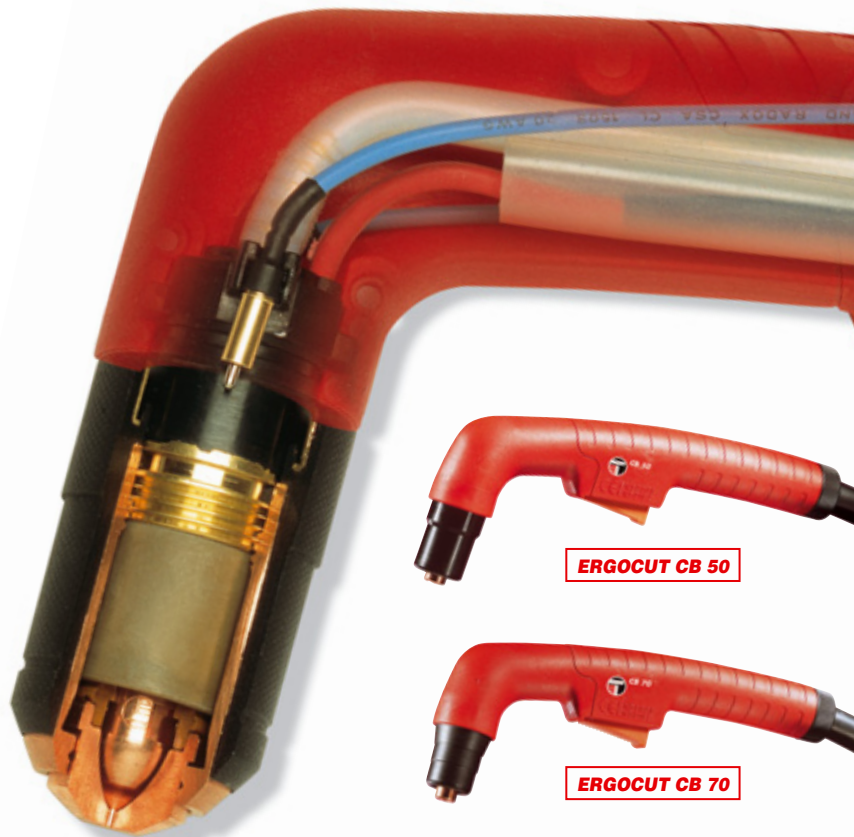

ERGOCUT CB 50



ERGOCUT CB 70



ERGOCUT CB 100



ERGOCUT CB 150

Plasma Range



ELECTRICAL SAFETY

The spring pins, which control electrical safety with the nozzle open, are no longer built into the torch body but inserted in the handle. So, to change a single pin, it is no longer necessary to replace the whole torch head. At this point, considering the ease with which repairs may be carried out and the minimum costs involved, there is no sense in tampering with the electrical circuit in order to save buying a complete torch head, all to the advantage of safety.



Plasma HY torches

These torches combine total interchangeability with Hypertherm® and the same quality level as the torches in the Trafimet range.

All HY torches can be equipped with the same optional accessories available for the Trafimet range:

- a complete series of long accessories for cutting in cavities and in narrow spaces
- different spacers for inclined cutting, etc.
- rulers and compasses for straight and circular cutting.

The whole range complies with CE-EN 60974-7 standard.

Hypertherm® is a registered trademark of Hypertherm Co.



KEY SAFETY TRIGGER

Simple - immediate - reliable
- evident - ambidextrous >
these are the characteristics of the new safety device installed by Trafimet on ERGOCUT torches for plasma cutting, considering the more pressing demands for safety in the place of work.

The Key Safety Trigger protects the operator against accidental or involuntary striking of the torch.

Before pressing the trigger the operator must pull back the Key Safety Trigger and only in this way can he release the movement of the torch trigger. Once the job has been done, the Key Safety Trigger resets automatically.



HY 40



HY 100

PLASMA CB 50 P



COMPLETE TORCH

Pt. No.	Description	Pack	Euro	D
PA1280	Plasma CB 50P machine torch 6m	1	260,00	B
PA1281	Plasma CB 50P machine torch 6m central adaptor	1	285,00	B

TECHNICAL DATA

Voltage class	M
Standard length m	6
Air consumption	165 l/min
Air pressure	5 bar
Duty cycle 60%	50 A
Duty cycle 100%	40 A

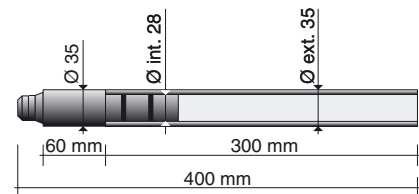
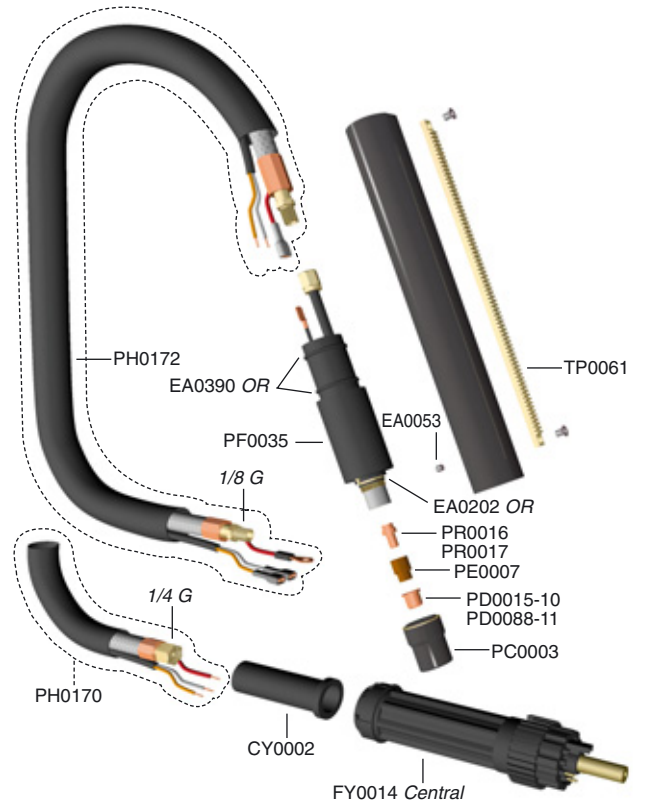
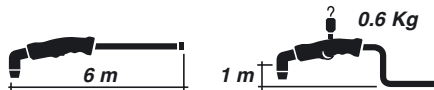

Pt. No.	Description	Pack	Euro	D
CY0002	Cable Support	1	1,10	B
EA0053	Screw	50	0,10	B
EA0212	O-ring	10	0,35	A
EA0390	O-ring	10	0,50	B
FY0014	Male central adaptor 7 pins	1	31,50	A
PC0003	Outside nozzle CB 50 (5710121)	4	6,00	A
PD0015-10	Tip CB 50 / HY 40 (020115 - 1304)	10	0,80	A
PD0088-10	Tip Ø 1,0 long life CB 50 / 70	10	0,85	A
PD0088-11	Tip Ø 1,1 long life CB 50 / 70	10	0,85	A
PD0088-12	Tip Ø 1,2 long life CB 50 / 70	10	0,85	A
PE0007	Air diffuser HY 40 / CB 50	2	7,50	A
PF0035	Torch head CB 50P	1	93,00	A
PH0170	Cable assembly 6m central adaptor	1	100,00	B
PH0172	Cable assembly 6m 1/8 G	1	80,00	B
PH0217	Outer cover 6m steel	1	155,00	C
PR0016	Electrode - Zr. (1521-Z)	10	0,95	A
PR0017	Electrode - Hf. CB 50 / HY 40 (020103 / 1521-H)	10	1,05	A
TP0061	Handle	1	75,00	B

Plasma Range

trafimet®



ERGOCUT CB 50



IEC 60974-7

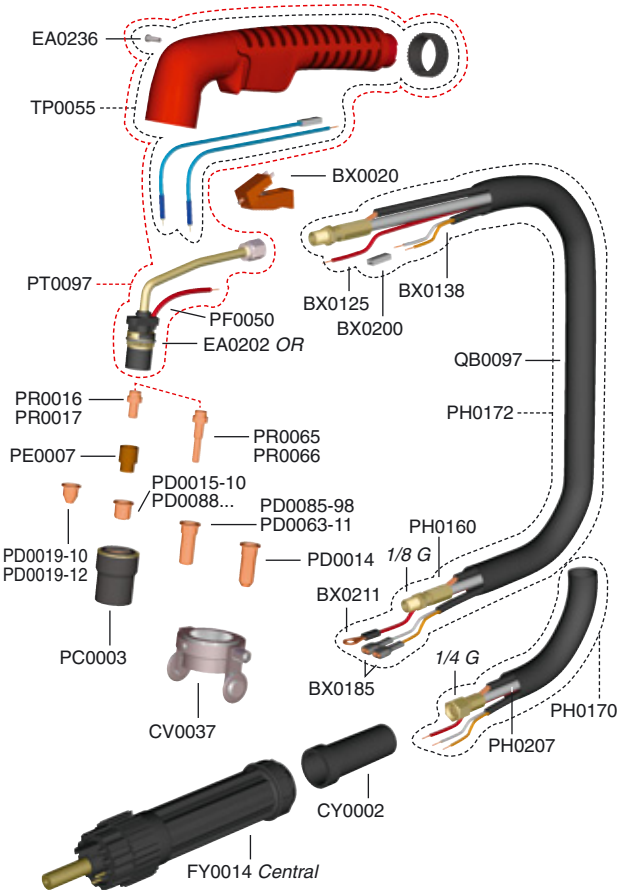

COMPLETE TORCH

Pt. No.	Description	Pack	Euro	D
PA1300	Plasma ERGOCUT CB 50 torch 6m 1/8G	1	140,00	A
PA1302	Plasma ERGOCUT CB 50 torch 6m central adaptor	1	165,00	A

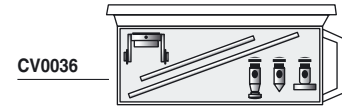

TECHNICAL DATA

Voltage class	M
Standard length m	6
Air consumption	165 l/min
Air pressure	5 bar
Duty cycle 60%	50 A
Duty cycle 100%	40 A

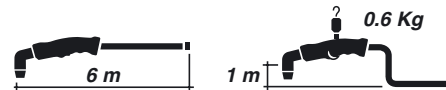

Pt. No.	Description	Pack	Euro	D
BX0020	Trigger	10	4,50	A
BX0125	Cable for pilot arc per meter		0,80	B
BX0138	Control cable per meter		2,50	B
BX0185	Female faston	10	0,60	B
BX0200	Female Trigger Wire Connector	10	1,00	B
BX0211	Nipple	50	0,30	B
CV0036	Circle cutting attachment CB 50	1	52,00	A
CV0037	Carriage CB 50	1	21,00	A
CV0092	Flowmeter CB 50	1	4,50	A
CY0002	Cable Support	1	1,10	B
EA0202	O-ring	10	0,25	A
EA0236	Screw	10	0,35	A
FY0014	Male central adaptor 7 pins	1	31,50	A
PC0003	Outside nozzle CB 50 (5710121)	4	6,00	A
PD0014	Long conical tip 1306	10	1,30	A
PD0015-10	Tip CB 50 / HY 40 (020115 - 1304)	10	0,80	A
PD0019-10	Tip Ø 1,0 (020131)	10	1,10	A
PD0019-12	Tip Ø 1,2	10	1,10	A
PD0063-11	Long tip Ø 1,1 long life CB 50 / 70	10	1,20	A
PD0085-98	Tip (1366)	10	1,20	A
PD0088-10	Tip Ø 1,0 long life CB 50 / 70	10	0,85	A
PD0088-11	Tip Ø 1,1 long life CB 50 / 70	10	0,85	A
PD0088-12	Tip Ø 1,2 long life CB 50 / 70	10	0,85	A
PE0007	Air diffuser HY 40 / CB 50	2	7,50	A
PF0050	Torch head ERGOCUT CB 50	1	60,00	A
PH0160	Air-power cable 6m 1/8G	1	47,00	B

Pt. No.	Description	Pack	Euro	D
PH0170	Cable assembly 6m central adaptor	1	100,00	B
PH0172	Cable assembly 6m 1/8G	1	80,00	B
PH0207	Air-power cable 6m 1/4G A 81	1	37,00	B
PR0016	Electrode - Zr. (1521-Z)	10	0,95	A
PR0017	Electrode - Hf. CB 50 / HY 40 (020103 / 1521-H)	10	1,05	A
PR0065	Long electrode - Hf. CB 50 (1518-H)	10	1,60	A
PR0066	Long electrode - Zr. CB 50 (1518-Z)	10	1,50	A
PT0097	Complete Handle ERGOCUT CB 50	1	62,00	B
QB0097	Rubber hose 20x22		4,20	B
TP0055	Ergocut CB 50 / 70 handle	1	26,00	A

Plasma Range

trafimct

PLASMA CB 70 P



COMPLETE TORCH

Pt. No.	Description	Pack	Euro	D
PA1290	Plasma CB 70P machine torch 6m	1	240,00	B
PA1291	Plasma CB 70P machine torch 6m central adaptor	1	270,00	B

TECHNICAL DATA

Voltage class	M
Standard length m	6
Air consumption	170 l/min
Air pressure	5 bar
Duty cycle 60%	70 A
Duty cycle 100%	50 A

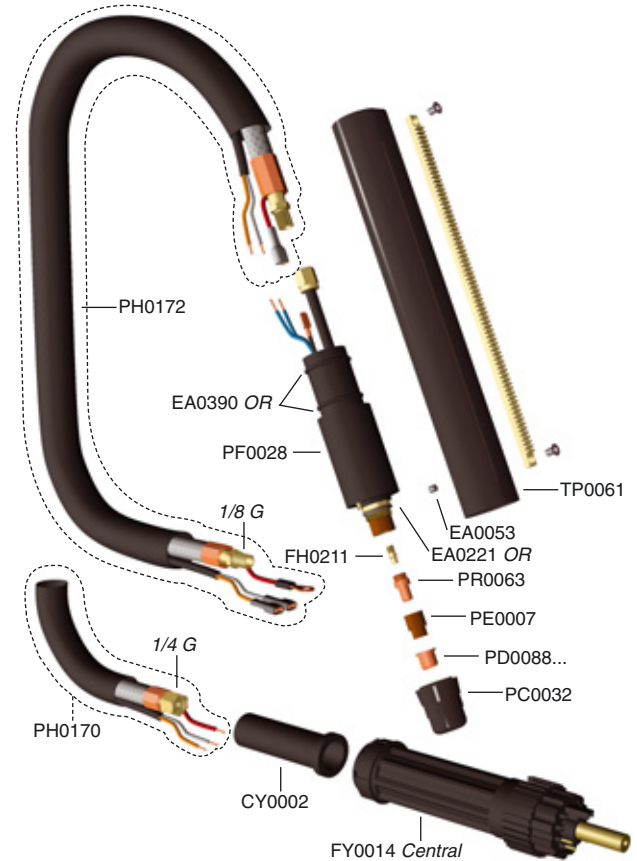
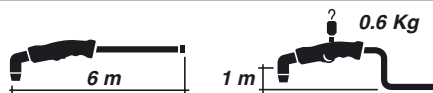

Pt. No.	Description	Pack	Euro	D
CY0002	Cable Support	1	1,10	B
EA0053	Screw	50	0,10	B
EA0221	O-ring	10	0,55	A
EA0390	O-ring	10	0,50	B
FH0211	Diffuser 3065204	1	2,50	B
FY0014	Male central adaptor 7 pins	1	31,50	A
PC0032	Outside nozzle (57110171)	2	6,00	A
PD0088-10	Tip Ø 1,0 long life CB 50 / 70	10	0,85	A
PD0088-11	Tip Ø 1,1 long life CB 50 / 70	10	0,85	A
PD0088-12	Tip Ø 1,2 long life CB 50 / 70	10	0,85	A
PE0007	Air diffuser HY 40 / CB 50	2	7,50	A
PF0028	Torch head CB 70P		105,00	A
PF0029	Torch head CB 70P (1349) Old Type	1	105,00	A
PH0170	Cable assembly 6m central adaptor	1	100,00	B
PH0172	Cable assembly 6m 1/8 G	1	80,00	B
PH0217	Outer cover 6m steel	1	155,00	C
PR0063	Electrode - Hf. CB 70 (1402)	10	1,20	A
TP0061	Handle	1	75,00	B

NEW

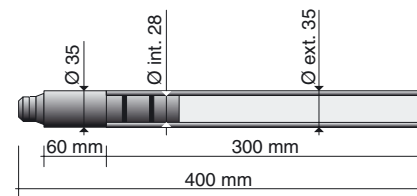

OLD

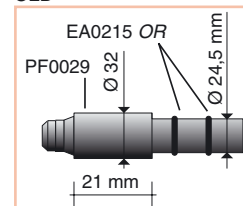

Plasma Range

trafimet®



ERGOCUT CB 70

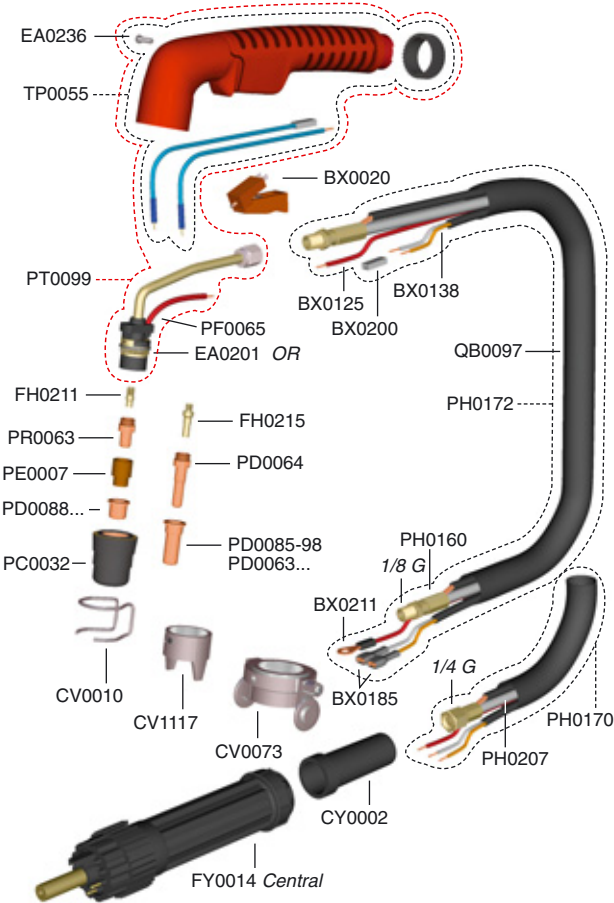

COMPLETE TORCH

Pt. No.	Description	Pack	Euro	D
PA1320	Plasma ERGOCUT CB 70 torch 6m 1/8G	1	170,00	A
PA1322	Plasma ERGOCUT CB 70 torch 6m central adaptor	1	200,00	A

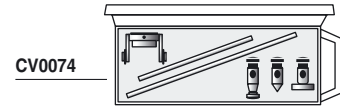

TECHNICAL DATA

Voltage class	M
Standard length m	6
Air consumption	170 l/min
Air pressure	5 bar
Duty cycle 60%	70 A
Duty cycle 100%	50 A

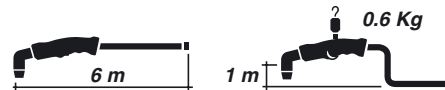

Pt. No.	Description	Pack	Euro	D
BX0020	Trigger	10	4,50	A
BX0125	Cable for pilot arc per meter		0,80	B
BX0138	Control cable per meter		2,50	B
BX0185	Female faston	10	0,60	B
BX0200	Female Trigger Wire Connector	10	1,00	B
BX0211	Nipple	50	0,30	B
CV0010	Stand off guide (743.0149/1394)	10	0,90	A
CV0073	Carriage	1	21,00	A
CV0074	Circle cutting attachment	1	52,00	A
CV0086	Flowmeter S 75 / CB 70	1	4,50	A
CV1117	TWO pins crown shield (1405)	2	6,00	B
CY0002	Cable Support	1	1,10	B
EA0201	O-ring	10	0,50	A
EA0236	Screw	10	0,35	A
FH0211	Diffuser 3065204	1	2,50	B
FH0215	Air tube long	1	4,00	B
FY0014	Male central adaptor 7 pins	1	31,50	A
PC0032	Outside nozzle (57110171)	2	6,00	A
PD0063-10	Long tip Ø 1,0 long life CB 50 / 70	10	1,20	A
PD0063-11	Long tip Ø 1,1 long life CB 50 / 70	10	1,20	A
PD0063-12	Long tip Ø 1,2 long life CB 50 / 70	10	1,20	A
PD0085-98	Tip (1366)	10	1,20	A
PD0088-10	Tip Ø 1,0 long life CB 50 / 70	10	0,85	A
PD0088-11	Tip Ø 1,1 long life CB 50 / 70	10	0,85	A
PD0088-12	Tip Ø 1,2 long life CB 50 / 70	10	0,85	A
PE0007	Air diffuser HY 40 / CB 50	2	7,50	A

Pt. No.	Description	Pack	Euro	D
PF0065	Torch head ERGOCUT CB 70	1	65,00	A
PH0160	Air-power cable 6m 1/8G	1	47,00	B
PH0170	Cable assembly 6m central adaptor	1	100,00	B
PH0172	Cable assembly 6m 1/8G	1	80,00	B
PH0207	Air-power cable 6m 1/4G A 81	1	37,00	B
PR0063	Electrode - Hf. CB 70 (1402)	10	1,20	A
PR0064	Long electrode - Hf. CB 70 (1403)	10	1,60	A
PT0099	Complete Handle ERGOCUT CB 70	1	68,00	B
QB0097	Rubber hose 20x22		4,20	B
TP0055	Ergocut CB 50 / 70 handle	1	26,00	A

Plasma Range

trafimct

PLASMA CB 100 P



COMPLETE TORCH

Pt. No.	Description	Pack	Euro	D
PA1216	Plasma CB 100P torch 6m 1/8G	1	315,00	B
PA1219	Plasma CB 100P torch 6m central adaptor	1	345,00	B

TECHNICAL DATA

Voltage class	M
Standard length m	6
Air consumption	180 l/min
Air pressure	5 bar
Duty cycle 60%	100 A
Duty cycle 100%	70 A

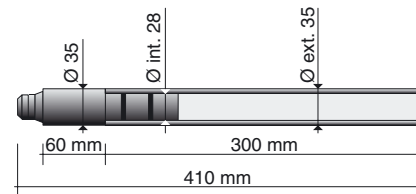
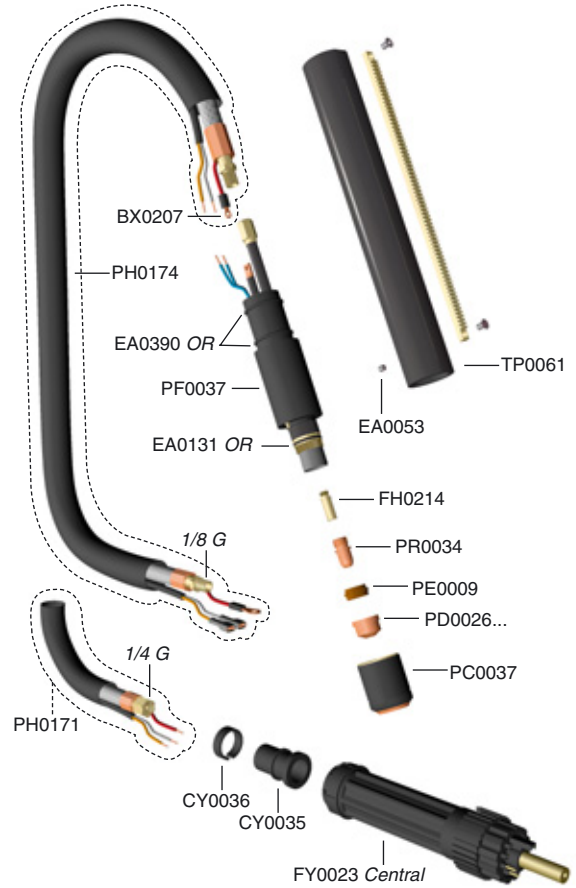
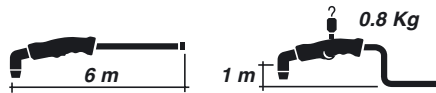

Pt. No.	Description	Pack	Euro	D
BX0207	Nipple	50	0,20	B
CY0035	Cable Support	10	1,10	B
CY0036	Cable Support	10	0,80	B
EA0053	Screw	50	0,10	B
EA0131	O-ring	10	0,50	A
EA0390	O-ring	10	0,50	B
FH0214	Air cable	1	1,90	B
FY0023	Male central adaptor	1	26,50	A
PC0037	Outside nozzle CB 100	2	20,00	A
PD0026-11	Tip Ø 1,1 (1371)	10	1,30	A
PD0026-13	Tip Ø 1,3 (1372)	10	1,30	A
PD0026-16	Tip Ø 1,6 (1373)	10	1,30	A
PD0026-18	Tip Ø 1,8 (1374)	10	1,30	A
PE0009	Air diffuser CB 100 / 150 (1377)	2	8,30	A
PF0037	Automatic torch head CB 100P	1	175,00	A
PH0171	Cable assembly 6m central adaptor	1	105,00	B
PH0174	Cable assembly 6m 1/8 G	1	105,00	B
PH0217	Outer cover 6m steel	1	155,00	C
PR0034	Electrode - Hf. (1376)	10	1,60	A
TP0061	Handle	1	75,00	B

Plasma Range

trafimet®



ERGOCUT CB 100



IEC 60974-7

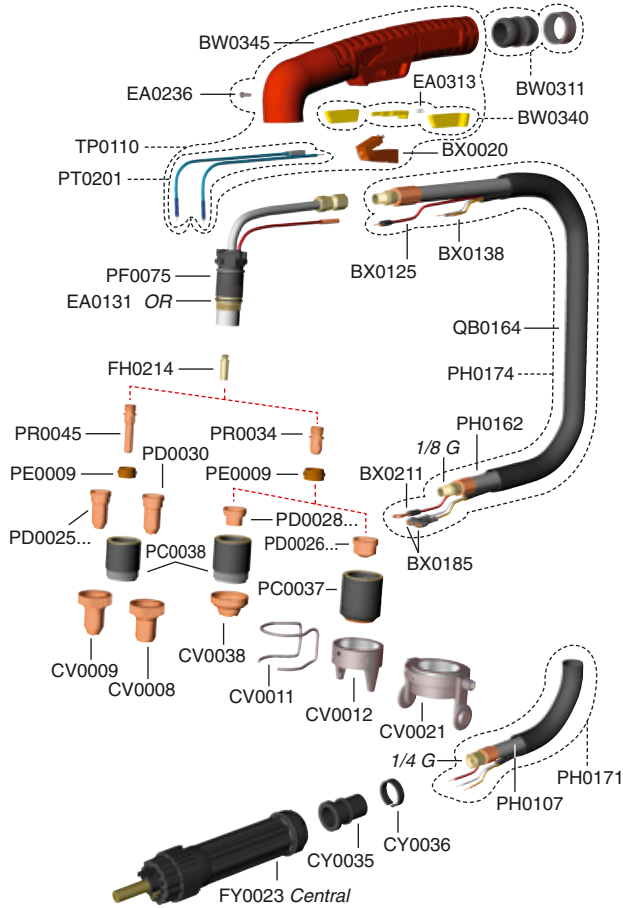

COMPLETE TORCH

Pt. No.	Description	Pack	Euro	D
PA1350	Plasma ERGOCUT Torch CB 100 6m 1/8G	1	250,00	A
PA1352	Plasma ERGOCUT Torch CB 100 6m central adaptor	1	280,00	A

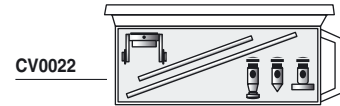

TECHNICAL DATA

Voltage class	M
Standard length m	6
Air consumption	180 l/min
Air pressure	5 bar
Duty cycle 60%	100 A
Duty cycle 100%	70 A

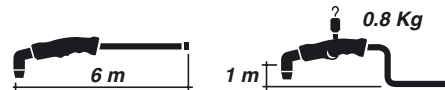

Pt. No.	Description	Pack	Euro	D
BW0311	Big joint with Ergotig / Ergocut ring	1	6,60	A
BW0340	Key safety trigger	1	10,00	A
BW0345	Ergocut handle	1	20,00	A
BX0020	Trigger	10	4,50	A
BX0125	Cable for pilot arc per meter		0,80	B
BX0138	Control cable per meter		2,50	B
BX0185	Female faston	10	0,60	B
BX0211	Nipple	50	0,30	B
CV0008	Contact cutting attachment	10	7,50	A
CV0009	Long contact cutting attachment	10	9,50	A
CV0011	Stand off guide (1386)	10	0,95	A
CV0012	TWO pins crown shield	2	7,00	A
CV0021	Carriage	1	22,50	A
CV0022	Circle cutting attachment	1	58,00	A
CV0038	Contact cutting attachment	10	8,00	A
CV0094	Flowmeter CB 150 / HY 100	1	4,50	A
CY0035	Cable Support	10	1,10	B
CY0036	Cable Support	10	0,80	B
EA0131	O-ring	10	0,50	A
EA0236	Screw	10	0,35	A
EA0313	Spring	1	1,05	B
FH0214	Air cable	1	1,90	B
FY0023	Male central adaptor	1	26,50	A
PC0037	Outside nozzle CB 100	2	20,00	A
PC0038	Contact cutting nozzle long life CB 100	2	28,00	A
PD0025-14	Long Tip Ø 1,4 CB 100 / 150	10	3,70	A

Pt. No.	Description	Pack	Euro	D
PD0025-16	Long Tip Ø 1,6 CB 100 / 150	10	3,70	A
PD0025-18	Long Tip Ø 1,8 CB 100 / 150	10	3,70	A
PD0026-11	Tip Ø 1,1 (1371)	10	1,30	A
PD0026-13	Tip Ø 1,3 (1372)	10	1,30	A
PD0026-16	Tip Ø 1,6 (1373)	10	1,30	A
PD0026-18	Tip Ø 1,8 (1374)	10	1,30	A
PD0028-13	Contact cutting tip Ø 1,35	10	1,50	A
PD0028-16	Contact cutting tip Ø 1,6	10	1,50	A
PD0028-18	Contact cutting tip Ø 1,8	10	1,50	A
PD0030-11	Long Tip (1369)	10	4,00	A
PE0009	Air diffuser CB 100 / 150 (1377)	2	8,30	A
PF0075	Torch head ERGOCUT CB 100	1	110,00	A
PH0107	Air-power cable 6m 1/4G	1	50,00	B
PH0162	Air-power cable 6m 1/8G	1	50,00	B
PH0171	Cable assembly 6m central adaptor	1	105,00	B
PH0174	Cable assembly 6m 1/8 G	1	105,00	B
PR0034	Electrode - Hf. (1376)	10	1,60	A
PR0045	Long electrode - Hf. CB 100 / 150 (1517)	10	3,40	A
PT0201	ERGOCUT handle spring pins kit	1	7,50	A
QB0164	Outer protection liner A 140 per meter		4,20	B
TP0110	ERGOCUT S / A / CB kit handle	1	25,00	A

Plasma Range

trafimet

PLASMA CB 150 P



COMPLETE TORCH

Pt. No.	Description	Pack	Euro	D
PA1284	Plasma CB 150P machine torch 6m	1	335,00	B
PA1285	Plasma CB 150P machine torch 6m central adaptor	1	365,00	B

TECHNICAL DATA

Voltage class	M
Standard length m	6
Air consumption	200 l/min
Air pressure	5 bar
Duty cycle 60%	150 A
Duty cycle 100%	110 A

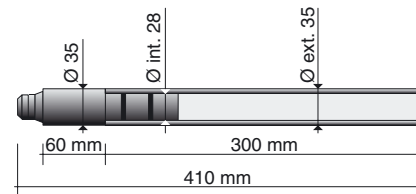
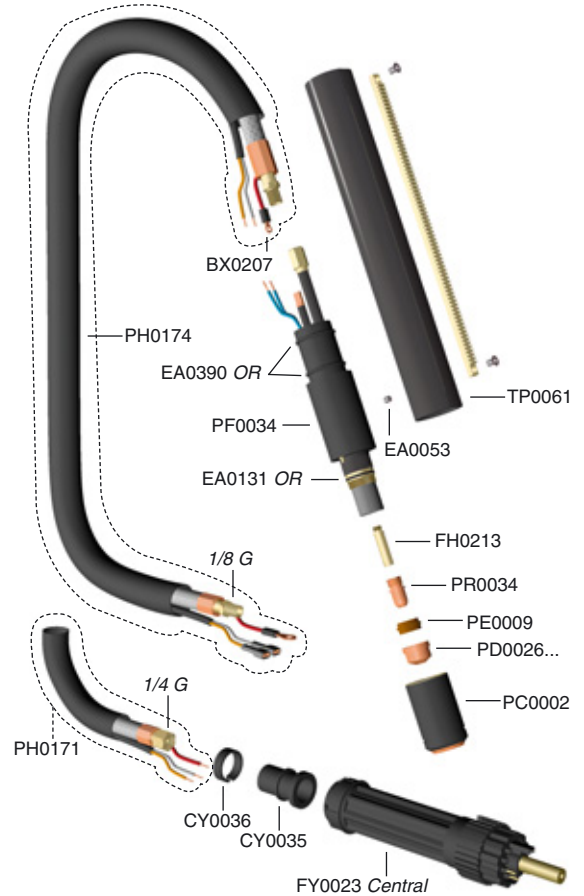
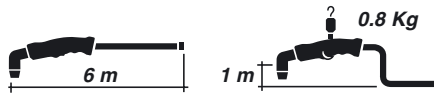

Pt. No.	Description	Pack	Euro	D
BX0207	Nipple	50	0,20	B
CY0035	Cable Support	10	1,10	B
CY0036	Cable Support	10	0,80	B
EA0053	Screw	50	0,10	
EA0131	O-ring	10	0,50	A
EA0390	O-ring	10	0,50	
FH0213	Diffuser 1378	1	1,75	B
FY0023	Male central adaptor	1	26,50	A
PC0002	Outside nozzle CB 150 (1389)	2	18,00	A
PD0026-11	Tip Ø 1,1 (1371)	10	1,30	A
PD0026-13	Tip Ø 1,3 (1372)	10	1,30	A
PD0026-16	Tip Ø 1,6 (1373)	10	1,30	A
PD0026-18	Tip Ø 1,8 (1374)	10	1,30	A
PE0009	Air diffuser CB 100 / 150 (1377)	2	8,30	A
PF0034	Torch head CB150P	1	171,00	A
PH0171	Cable assembly 6m central adaptor	1	105,00	B
PH0174	Cable assembly 6m 1/8 G	1	105,00	B
PH0217	Outer cover 6m steel	1	155,00	C
PR0034	Electrode - Hf. (1376)	10	1,60	A
TP0061	Handle	1	75,00	B

Plasma Range

trafimet®



ERGOCUT CB 150



IEC 60974-7

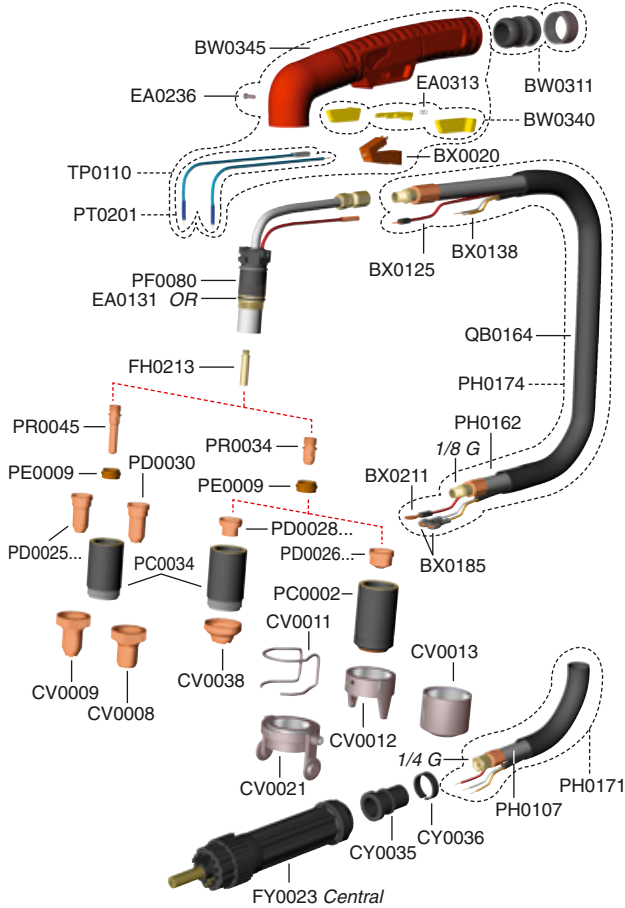

COMPLETE TORCH

Pt. No.	Description	Pack	Euro	D
PA1370	Plasma ERGOCUT Torch CB 150 6m 1/8G	1	270,00	A
PA1372	Plasma ERGOCUT Torch CB 150 6m central adaptor	1	300,00	A

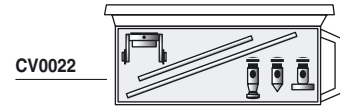

TECHNICAL DATA

Voltage class	M
Standard length m	6
Air consumption	200 l/min
Air pressure	5 bar
Duty cycle 60%	150 A
Duty cycle 100%	110 A

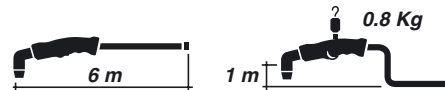

Pt. No.	Description	Pack	Euro	D
BW0311	Big joint with Ergotig / Ergocut ring	1	6,60	A
BW0340	Key safety trigger	1	10,00	A
BW0345	Ergocut handle	1	20,00	A
BX0020	Trigger	10	4,50	A
BX0125	Cable for pilot arc per meter		0,80	B
BX0138	Control cable per meter		2,50	B
BX0185	Female faston	10	0,60	B
BX0211	Nipple	50	0,30	B
CV0008	Contact cutting attachment	10	7,50	A
CV0009	Long contact cutting attachment	10	9,50	A
CV0011	Stand off guide (1386)	10	0,95	A
CV0012	TWO pins crown shield	2	7,00	A
CV0013	Gouging shield	2	6,50	A
CV0021	Carriage	1	22,50	A
CV0022	Circle cutting attachment	1	58,00	A
CV0038	Contact cutting attachment	10	8,00	A
CV0094	Flowmeter CB 150 / HY 100	1	4,50	A
CY0035	Cable Support	10	1,10	B
CY0036	Cable Support	10	0,80	B
EA0131	O-ring	10	0,50	A
EA0236	Screw	10	0,35	A
EA0313	Spring	1	1,05	B
FH0213	Diffuser 1378	1	1,75	B
FY0023	Male central adaptor	1	26,50	A
PC0002	Outside nozzle CB 150 (1389)	2	18,00	A
PC0034	Contact cutting nozzle long life CB 150	2	30,00	A

Pt. No.	Description	Pack	Euro	D
PD0025-14	Long Tip Ø 1,4 CB 100 / 150	10	3,70	A
PD0025-16	Long Tip Ø 1,6 CB 100 / 150	10	3,70	A
PD0025-18	Long Tip Ø 1,8 CB 100 / 150	10	3,70	A
PD0026-11	Tip Ø 1,1 (1371)	10	1,30	A
PD0026-13	Tip Ø 1,3 (1372)	10	1,30	A
PD0026-16	Tip Ø 1,6 (1373)	10	1,30	A
PD0026-18	Tip Ø 1,8 (1374)	10	1,30	A
PD0026-30	Tip Ø 3,0 (1375)	10	1,30	A
PD0028-13	Contact cutting tip Ø 1,35	10	1,50	A
PD0028-16	Contact cutting tip Ø 1,6	10	1,50	A
PD0028-18	Contact cutting tip Ø 1,8	10	1,50	A
PD0030-11	Long Tip (1369)	10	4,00	A
PE0009	Air diffuser CB 100 / 150 (1377)	2	8,30	A
PF0080	Torch head ERGOCUT CB 150	1	120,00	A
PH0107	Air-power cable 6m 1/4G	1	50,00	B
PH0162	Air-power cable 6m 1/8G	1	50,00	B
PH0171	Cable assembly 6m central adaptor	1	105,00	B
PH0174	Cable assembly 6m 1/8 G	1	105,00	B
PR0034	Electrode - Hf. (1376)	10	1,60	A
PR0045	Long electrode - Hf. CB 100 / 150 (1517)	10	3,40	A
PT0201	ERGOCUT handle spring pins kit	1	7,50	A
QB0164	Outer protection liner A 140 per meter		4,20	B
TP0110	ERGOCUT S / A / CB kit handle	1	25,00	A

Plasma Range

trafimct

PLASMA CB 50



COMPLETE TORCH

Pt. No.	Description	Pack	Euro	D
PA1240	Plasma CB 50 torch 6m	1	185,00	B
PA1242	Plasma CB 50 torch 6m central adaptor	1	218,00	B

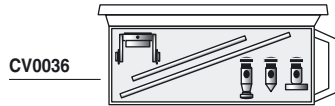

TECHNICAL DATA

Voltage class	M
Standard length m	6
Air consumption	165 l/min
Air pressure	5 bar
Duty cycle 60%	50 A
Duty cycle 100%	40 A

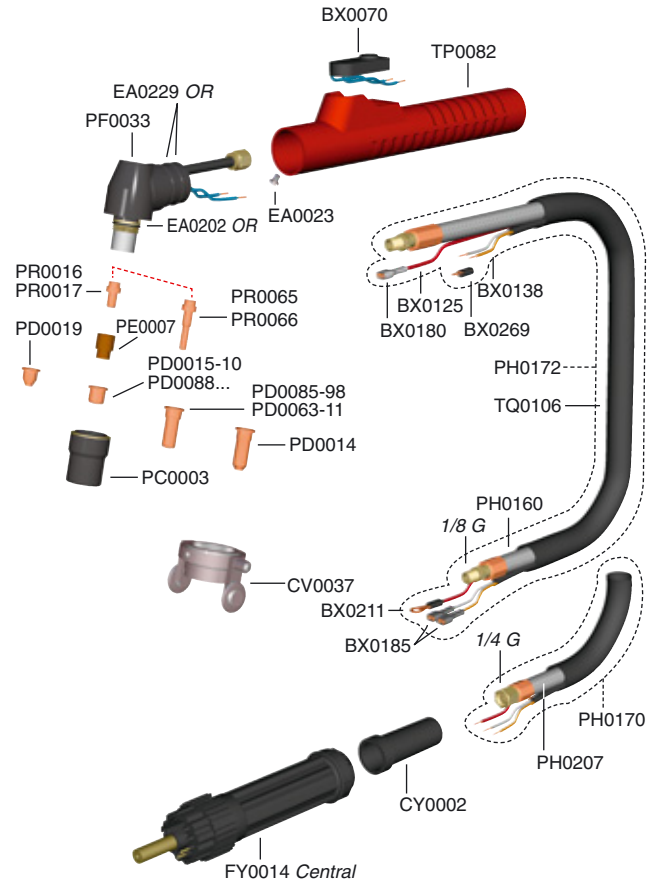
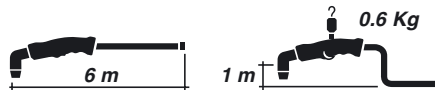

Pt. No.	Description	Pack	Euro	D
BX0070	Microswitch	10	9,50	B
BX0125	Cable for pilot arc per meter		0,80	B
BX0138	Control cable per meter		2,50	B
BX0180	Female faston	10	0,50	B
BX0185	Female faston	10	0,60	B
BX0211	Nipple	50	0,30	B
BX0269	Flat contact tip	10	0,40	B
CV0036	Circle cutting attachment CB 50	1	52,00	A
CV0037	Carriage CB 50	1	21,00	A
CV0092	Flowmeter CB 50	1	4,50	A
CY0002	Cable Support	1	1,10	B
EA0023	Screw	50	0,05	B
EA0132	O-ring	10	0,55	A
EA0202	O-ring	10	0,25	A
EA0229	O-ring	10	0,35	A
FY0014	Male central adaptor 7 pins	1	31,50	A
PC0003	Outside nozzle CB 50 (5710121)	4	6,00	A
PD0014	Long conical tip (1306)	10	1,30	A
PD0015-10	Tip CB 50 / HY 40 (020115 - 1304)	10	0,80	A
PD0063-10	Long tip Ø 1,0 long life CB 50 / 70	10	1,20	A
PD0063-11	Long tip Ø 1,1 long life CB 50 / 70	10	1,20	A
PD0063-12	Long tip Ø 1,2 long life CB 50 / 70	10	1,20	A
PD0085-98	Tip (1366)	10	1,20	A
PD0088-10	Tip Ø 1,0 long life CB 50 / 70	10	0,85	A
PD0088-11	Tip Ø 1,1 long life CB 50 / 70	10	0,85	A
PD0088-12	Tip Ø 1,2 long life CB 50 / 70	10	0,85	A

Pt. No.	Description	Pack	Euro	D
PE0007	Air diffuser HY 40 / CB 50	2	7,50	A
PF0033	Torch head CB 50 1352	1	75,00	A
PH0160	Air-power cable 6m 1/8G	1	47,00	B
PH0170	Cable assembly 6m central adaptor	1	100,00	B
PH0172	Cable assembly 6m	1	80,00	B
PH0207	Air-power cable 6m 1/4G A 81	1	37,00	B
PR0016	Electrode - Zr. (1521-Z)	10	0,95	A
PR0017	Electrode - Hf. CB 50 / HY 40 (020103 / 1521-H)	10	1,05	A
PR0065	Long electrode - Hf. CB 50 (1518-H)	10	1,60	A
PR0066	Long electrode - Zr. CB 50 (1518-Z)	10	1,50	A
TP0082	Handle red Ø 28,5	1	18,00	A
TQ0106	Outer cover 20x22 per m		1,60	B

Plasma Range

trafimet®



PLASMA CB 70



IEC 60974-7

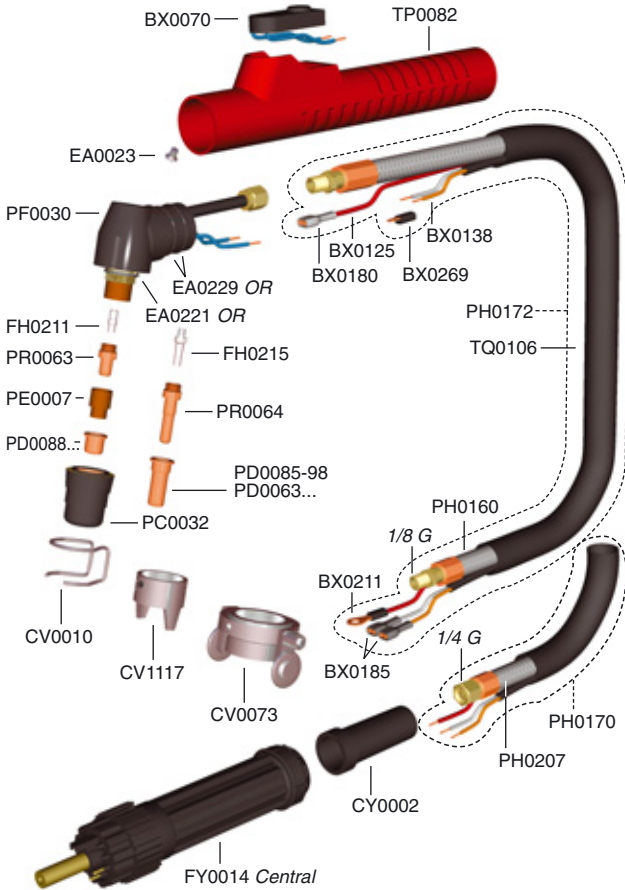

COMPLETE TORCH

Pt. No.	Description	Pack	Euro	D
PA1270	Plasma CB 70 torch 6m	1	200,00	B
PA1272	Plasma CB 70 torch 6m central adaptor	1	230,00	B

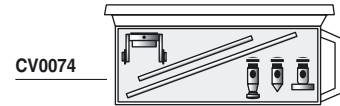

TECHNICAL DATA

Voltage class	M
Standard length m	6
Air consumption	170 l/min
Air pressure	5 bar
Duty cycle 60%	70 A
Duty cycle 100%	50 A

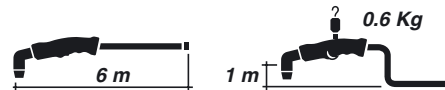

Pt. No.	Description	Pack	Euro	D
BX0070	Microswitch	10	9,50	B
BX0125	Cable for pilot arc per meter		0,80	B
BX0138	Control cable per meter		2,50	B
BX0180	Female faston	10	0,50	B
BX0185	Female faston	10	0,60	B
BX0211	Nipple	50	0,30	B
BX0269	Flat contact tip	10	0,40	B
CV0010	Stand off guide (743.0149/1394)	10	0,90	A
CV0073	Carriage	1	21,00	A
CV0074	Circle cutting attachment	1	52,00	A
CV0086	Flowmeter S 75 / CB 70	1	4,50	A
CV1117	Two pins crown shield (1405)	2	6,00	B
CY0002	Cable Support	1	1,10	B
EA0023	Screw	50	0,05	B
EA0221	O-ring	10	0,55	A
EA0229	O-ring	10	0,35	A
FH0211	Diffuser 3065204	1	2,50	B
FH0215	Air tube long	1	4,00	B
FY0014	Male central adaptor 7 pins	1	31,50	A
PC0032	Outside nozzle (57110171)	2	6,00	A
PD0063-10	Long tip Ø 1,0 long life CB 50 / 70	10	1,20	A
PD0063-11	Long tip Ø 1,1 long life CB 50 / 70	10	1,20	A
PD0063-12	Long tip Ø 1,2 long life CB 50 / 70	10	1,20	A
PD0085-98	Tip (1366)	10	1,20	A
PD0088-10	Tip Ø 1,0 long life CB 50 / 70	10	0,85	A
PD0088-11	Tip Ø 1,1 long life CB 50 / 70	10	0,85	A

Pt. No.	Description	Pack	Euro	D
PD0088-12	Tip Ø 1,2 long life CB 50 / 70	10	0,85	A
PE0007	Air diffuser HY 40 / CB 50	2	7,50	A
PF0030	Torch head CB 70 1351	1	78,00	A
PH0160	Air-power cable 6m 1/8G	1	47,00	B
PH0170	Cable assembly 6m central adaptor	1	100,00	B
PH0172	Cable assembly 6m	1	80,00	B
PH0207	Air-power cable 6m 1/4G A 81	1	37,00	B
PR0063	Electrode - Hf. CB 70 (1402)	10	1,20	A
PR0064	Long electrode - Hf. CB 70 (1403)	10	1,60	A
TP0082	Handle red Ø 28,5	1	18,00	A
TQ0106	Outer cover 20x22 per m		1,60	B

Plasma Range

trafimct

PLASMA CB 100



COMPLETE TORCH

Pt. No.	Description	Pack	Euro	D
PA1230	Plasma CB 100 torch 6m 1/8G	1	275,00	B
PA1232	Plasma CB 100 torch 6m central adaptor	1	305,00	B

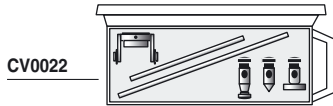

CV0022

TECHNICAL DATA

Voltage class	M
Standard length m	6
Air consumption	180 l/min
Air pressure	5 bar
Duty cycle 60%	100 A
Duty cycle 100%	70 A

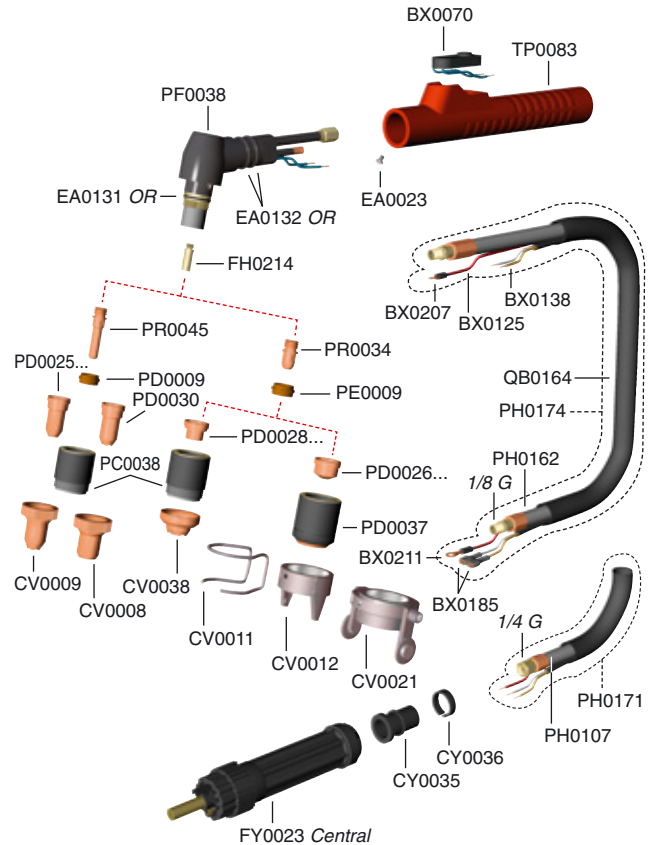
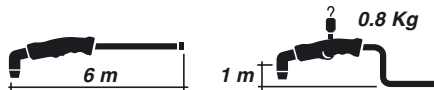

Pt. No.	Description	Pack	Euro	D
BX0070	Microswitch	10	9,50	B
BX0125	Cable for pilot arc per meter		0,80	B
BX0138	Control cable per meter		2,50	B
BX0185	Female faston	10	0,60	B
BX0207	Nipple	50	0,20	B
BX0211	Nipple	50	0,30	B
CV0008	Contact cutting attachment	10	7,50	A
CV0009	Long contact cutting attachment	10	9,50	A
CV0011	Stand off guide (1386)	10	0,95	A
CV0012	TWO pins crown shield	2	7,00	A
CV0021	Carriage	1	22,50	A
CV0022	Circle cutting attachment	1	58,00	A
CV0038	Contact cutting attachment	10	8,00	A
CV0094	Flowmeter CB 150 / HY 100	1	4,50	A
CY0035	Cable Support	10	1,10	B
CY0036	Cable Support	10	0,80	B
EA0023	Screw	50	0,05	B
EA0131	O-ring	10	0,50	A
EA0132	O-ring	10	0,55	A
FH0214	Air cable	1	1,90	B
FY0023	Male central adaptor	1	26,50	A
PC0037	Outside nozzle CB 100	2	20,00	A
PC0038	Contact cutting nozzle long life CB 100	2	28,00	A
PD0025-14	Long Tip Ø 1,4 CB 100 / 150	10	3,70	A
PD0025-16	Long Tip Ø 1,6 CB 100 / 150	10	3,70	A
PD0025-18	Long Tip Ø 1,8 CB 100 / 150	10	3,70	A

Pt. No.	Description	Pack	Euro	D
PD0026-11	Tip Ø 1,1 (1371)	10	1,30	A
PD0026-13	Tip Ø 1,3 (1372)	10	1,30	A
PD0026-16	Tip Ø 1,6 (1373)	10	1,30	A
PD0026-18	Tip Ø 1,8 (1374)	10	1,30	A
PD0028-13	Contact cutting tip Ø 1,35	10	1,50	A
PD0028-16	Contact cutting tip Ø 1,6	10	1,50	A
PD0028-18	Contact cutting tip Ø 1,8	10	1,50	A
PD0030-11	Long Tip (1369)	10	4,00	A
PE0009	Air diffuser CB 100 / 150 (1377)	2	8,30	A
PF0038	Torch head CB 100	1	140,00	A
PH0107	Air-power cable 6m 1/4G	1	50,00	B
PH0162	Air-power cable 6m 1/8G	1	50,00	B
PH0171	Cable assembly 6m	1	105,00	B
PH0174	Cable assembly 6m	1	105,00	B
PR0034	Electrode - Hf. (1376)	10	1,60	A
PR0045	Long electrode - Hf. CB 100 / 150 (1517)	10	3,40	A
QB0164	Outer protection liner A 140 per meter		4,20	B
TP0083	Handle red Ø 24,5	1	18,00	A

Plasma Range

trafimet®



PLASMA CB 150



IEC 60974-7

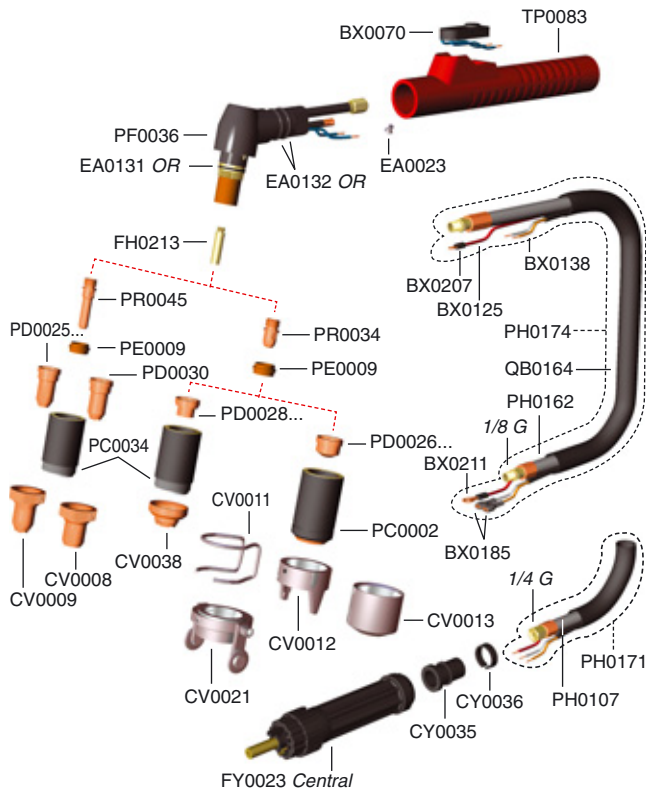

COMPLETE TORCH

Pt. No.	Description	Pack	Euro	D
PA1245	Plasma CB 150 torch 6m	1	300,00	B
PA1247	Plasma CB 150 torch 6m central adaptor	1	325,00	B

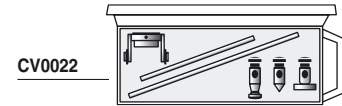

TECHNICAL DATA

Voltage class	M
Standard length m	6
Air consumption	200 l/min
Air pressure	5 bar
Duty cycle 60%	150 A
Duty cycle 100%	110 A

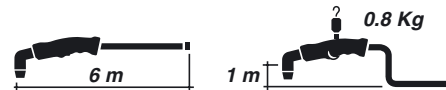

Pt. No.	Description	Pack	Euro	D
BX0070	Microswitch	10	9,50	B
BX0125	Cable for pilot arc per meter		0,80	B
BX0138	Control cable per meter		2,50	B
BX0185	Female faston	10	0,60	B
BX0207	Nipple	50	0,20	B
BX0211	Nipple	50	0,30	B
CV0008	Contact cutting attachment	10	7,50	A
CV0009	Long contact cutting attachment	10	9,50	A
CV0011	Stand off guide (1386)	10	0,95	A
CV0012	Two pins crown shield	2	7,00	A
CV0013	Gouging shield	2	6,50	A
CV0021	Carriage	1	22,50	A
CV0022	Circle cutting attachment	1	58,00	A
CV0038	Contact cutting attachment	10	8,00	A
CV0094	Flowmeter CB 150 / HY 100	1	4,50	A
CY0035	Cable Support	10	1,10	B
CY0036	Cable Support	10	0,80	B
EA0023	Screw	50	0,05	B
EA0131	O-ring	10	0,50	A
EA0132	O-ring	10	0,55	A
EA0313	Spring	1	1,05	B
FH0213	Diffuser 1378	1	1,75	B
FY0023	Male central adaptor	1	26,50	A
PC0002	Outside nozzle CB 150 (1389)	2	18,00	A
PC0034	Contact cutting nozzle long life CB 150	2	30,00	A
PD0025-14	Long Tip Ø 1,4 CB 100 / 150	10	3,70	A

Pt. No.	Description	Pack	Euro	D
PD0025-16	Long Tip Ø 1,6 CB 100 / 150	10	3,70	A
PD0025-18	Long Tip Ø 1,8 CB 100 / 150	10	3,70	A
PD0026-11	Tip Ø 1,1 (1371)	10	1,30	A
PD0026-13	Tip Ø 1,3 (1372)	10	1,30	A
PD0026-16	Tip Ø 1,6 (1373)	10	1,30	A
PD0026-18	Tip Ø 1,8 (1374)	10	1,30	A
PD0026-30	Tip Ø 3,0 (1375)	10	1,30	A
PD0028-13	Contact cutting tip Ø 1,35	10	1,50	A
PD0028-16	Contact cutting tip Ø 1,6	10	1,50	A
PD0028-18	Contact cutting tip Ø 1,8	10	1,50	A
PD0030-11	Long Tip (1369)	10	4,00	A
PE0009	Air diffuser CB 100 / 150 (1377)	2	8,30	A
PF0031	Torch head CB 150 1353	1	145,00	A
PF0036	Torch head CB 150	1	145,00	A
PH0107	Air-power cable 6m 1/4G	1	50,00	B
PH0162	Air-power cable 6m 1/8G	1	50,00	B
PH0171	Cable assembly 6m	1	105,00	B
PH0174	Cable assembly 6m	1	105,00	B
PR0034	Electrode - Hf. (1376)	10	1,60	A
PR0045	Long electrode - Hf. CB 100 / 150 (1517)	10	3,40	A
QB0164	Outer protection liner A 140 per meter		4,20	B
TP0083	Handle red Ø 24,5	1	18,00	A

Plasma Range

trafimct

PLASMA HY 40 P

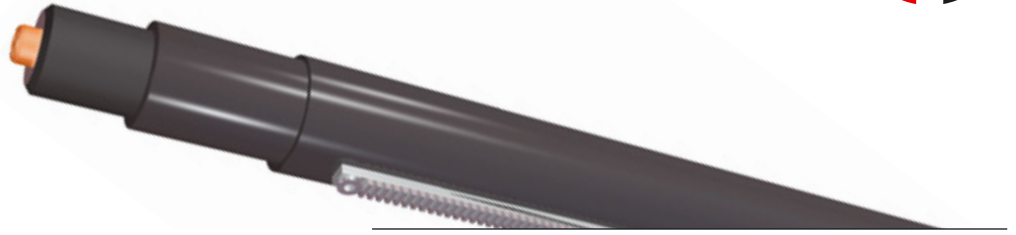

COMPLETE TORCH

Pt. No.	Description	Pack	Euro	D
PA0432	Plasma HY 40P torch 6m	1	280,00	B

TECHNICAL DATA

Voltage class	M
Standard length m	6
Air consumption	127 l/min
Air pressure	4.1 bar
Duty cycle 60%	40 A
Duty cycle 100%	30 A

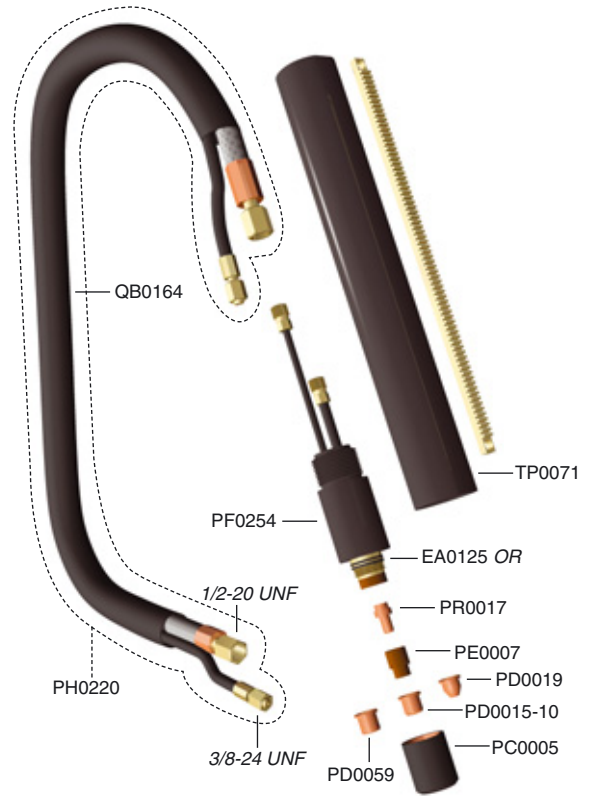
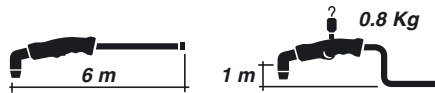

Pt. No.	Description	Pack	Euro	D
EA0125	O-ring	10	0,55	A
PC0005	Outside nozzle HY 40 (020104)	4	8,00	A
PD0015-10	Tip CB 50 / HY 40 (020115 - 1304)	10	0,80	A
PD0019-10	Tip Ø 1,0 (020131)	10	1,10	A
PD0059	Flat tip HY 40 (020102)	10	1,10	A
PE0007	Air diffuser HY 40 / CB 50	2	7,50	A
PF0254	Torch head HY 40P	1	130,00	A
PH0220	Cable assembly 6m	1	155,00	B
PR0017	Electrode - Hf. CB 50 / HY 40 (020103 / 1521-H)	10	1,05	A
QB0164	Outer protection liner A 140 per meter		4,20	B
TP0071	Handle HY 40P	1	83,00	B



PLASMA HY 40



IEC 60974-7

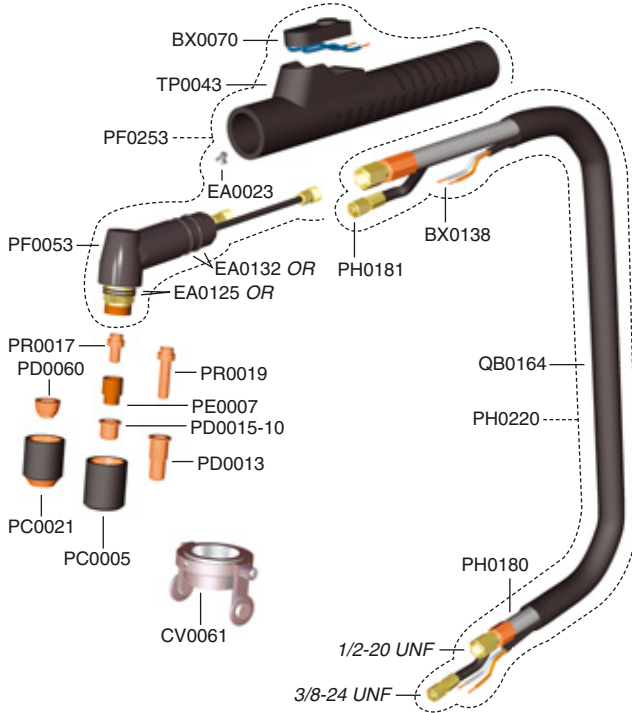

COMPLETE TORCH

Pt. No.	Description	Pack	Euro	D
PA0430	Plasma HY 40 torch 6m	1	270,00	B

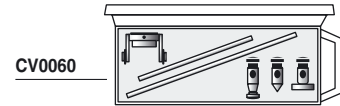

TECHNICAL DATA

Voltage class	M
Standard length m	6
Air consumption	127 l/min
Air pressure	4.1 bar
Duty cycle 60%	40 A
Duty cycle 100%	30 A

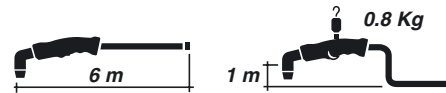

Pt. No.	Description	Pack	Euro	D
BX0070	Microswitch	10	9,50	B
BX0138	Control cable per meter		2,50	B
CV0060	Circle cutting attachment	1	55,00	B
CV0061	Carriage	1	21,00	B
CV0085	Flowmeter S45 / HY 40	1	4,50	A
EA0023	Screw	50	0,05	B
EA0125	O-ring	10	0,55	A
EA0132	O-ring	10	0,55	A
PC0005	Outside nozzle HY 40 (020104)	4	8,00	A
PC0021	Outside nozzle (020200)	4	7,20	A
PD0013	Long tip (020466 - 1370)	10	1,20	A
PD0015-10	Tip CB 50 / HY 40 (020115 - 1304)	10	0,80	A
PD0060	Tapered tip (020197) HY 40	10	1,85	A
PE0007	Air diffuser HY 40 / CB 50	2	7,50	A
PF0053	Torch head HY 40	1	104,00	A
PF0253	Torch head HY 40 with handle	1	130,00	A
PH0180	Air-power cable 6m HY 40	1	58,00	B
PH0181	Pilot-arc cable 6m HY 40	1	37,00	B
PH0220	Cable assembly 6m	1	155,00	B
PR0017	Electrode - Hf. CB 50 / HY 40 (020103 / 1521-H)	10	1,05	A
PR0019	Long electrode - Hf. (020647)	10	1,60	A
QB0164	Outer protection liner A 140 per meter		4,20	B
TP0043	Handle black Ø 24,5	1	13,00	B

Plasma Range

trafimet

PLASMA HY 100 P



COMPLETE TORCH

Pt. No.	Description	Pack	Euro	D
PA0452	Plasma HY 100P torch 6m	1	360,00	B

TECHNICAL DATA

Voltage class	M
Standard length m	6
Air consumption	200 l/min
Air pressure	4.5 bar
Duty cycle 60%	100 A
Duty cycle 100%	80 A

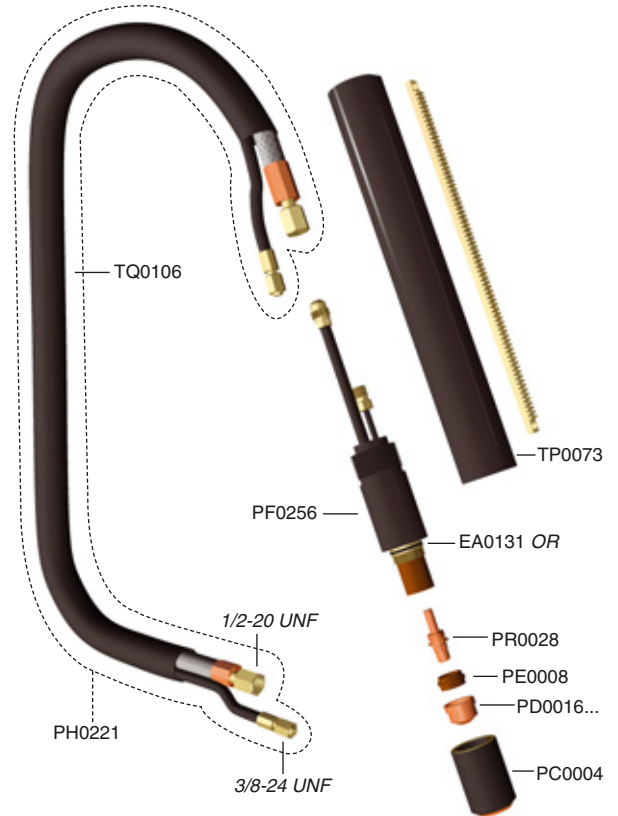
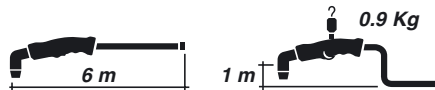

Pt. No.	Description	Pack	Euro	D
EA0131	O-ring	10	0,50	A
PC0004	Outside Nozzle HY 100 (020184)	2	15,00	A
PD0016-10	Tip Ø 1,0 - 40A - .038 HY 100 (020203)	10	1,40	A
PD0016-13	Tip Ø 1,3 - 80A - .052 HY 100 (020345)	10	1,40	A
PD0016-15	Tip Ø 1,5 - 100A - .059 HY 100 (020195)	10	1,40	A
PE0008	Air diffuser HY 100 (020194)	2	8,50	A
PF0256	Torch head HY 100	1	160,00	A
PH0221	Cable assembly 6m	1	200,00	B
PR0028	Electrode - Hf. HY 100(020191)	10	1,70	A
TP0073	Handle HY 100P	1	83,00	B
TQ0106	Outer cover 20x22 per m		1,60	B

Plasma Range



PLASMA HY 100

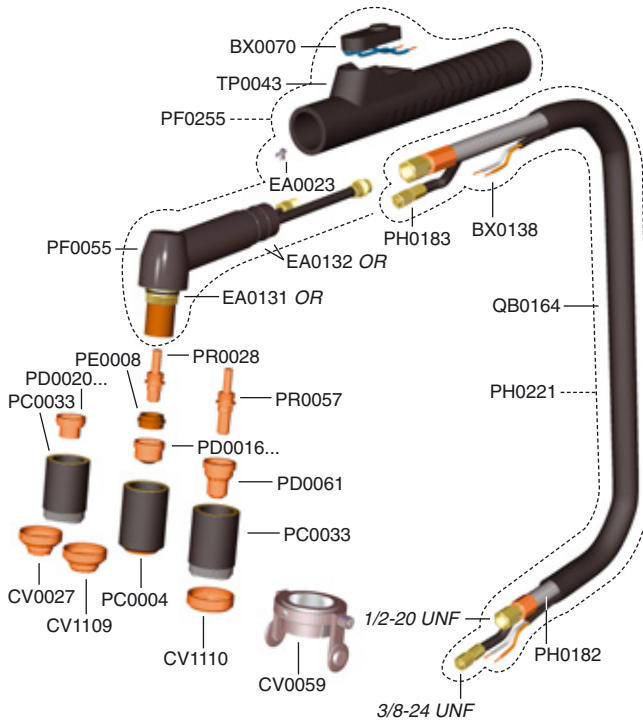

CV0058

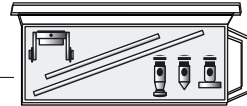

COMPLETE TORCH

Pt. No.	Description	Pack	Euro	D
PA0450	Plasma HY 100 torch 6m	1	340,00	B

TECHNICAL DATA

Voltage class	M
Standard lenght m	6
Air consumption	200 l/min
Air pressure	4.5 bar
Duty cycle 60%	100 A
Duty cycle 100%	80 A

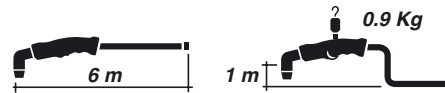

Pt. No.	Description	Pack	Euro	D
BX0070	Microswitch	10	9,50	B
BX0138	Control cable per meter		2,50	B
CV0027	Contact cutting attachment	10	7,80	A
CV0058	Circle cutting attachment HY 100	1	52,00	B
CV0059	Carriage HY 100	1	22,00	B
CV0094	Flowmeter CB 150 / HY 100	1	4,50	A
CV1109	Contact cutting attachment (020334)	10	9,00	B
CV1110	Contact cutting attachment (020333)	10	9,00	B
EA0023	Screw	50	0,05	B
EA0131	O-ring	10	0,50	A
EA0132	O-ring	10	0,55	A
PC0004	Outside Nozzle HY 100 (020184)	2	15,00	A
PC0033	Contact cutting nozzle long life HY 100	2	28,00	A
PD0016-10	Tip Ø 1,0 - 40A - .038 HY 100 (020203)	10	1,40	A
PD0016-13	Tip Ø 1,3 - 80A - .052 HY 100 (020345)	10	1,40	A
PD0016-15	Tip Ø 1,5 - 100A - .059 HY 100 (020195)	10	1,40	A
PD0020-13	Tip Ø 1,3 - 80A - .052 (020397)	10	1,40	A
PD0020-15	Tip Ø 1,5 - 100A - .059 (020337)	10	1,40	A
PD0061	Long tip HY 100 (020563)	10	3,10	A
PE0008	Air diffuser HY 100 (020194)	2	8,50	A
PF0055	Torch head HY 100	1	135,00	A
PF0255	Torch head HY 100 with handle	1	160,00	A
PH0182	Air-power cable 6m	1	50,00	B
PH0183	Pilot-arc cable 6m HY 100	1	37,00	B
PH0221	Cable assembly 6m	1	200,00	B
PR0028	Electrode - Hf. HY 100(020191)	10	1,70	A

Pt. No.	Description	Pack	Euro	D
PR0057	Long electrode - Hf. HY 100 (020564)	10	3,80	A
TP0043	Handle black Ø 24,5	1	13,00	B
TQ0106	Outer cover 20x22 per m		1,60	B





Plasma Range

TRAFIMET offers a wide range of PLASMA spare parts that can be used with the principal models of cutting torches to be found on the market.

The working process for these articles is exactly the same as for all original TRAFIMET products; this means:

maximum attention to the selection of raw materials ...

the same high quality levels in all production stages ...

strict and meticulous controls by the Quality Control Department ...

... this is why these components exactly meet the quality standards of original TRAFIMET parts.

Furthermore, together with high production quality, the perfect interchangeability of these parts ensures a long working life and optimum cutting characteristics. With Trafimet you can be sure!





SPARE PARTS



Plasma Range

trafimct



CB 30/35

CB/CP 90



Plasma Range

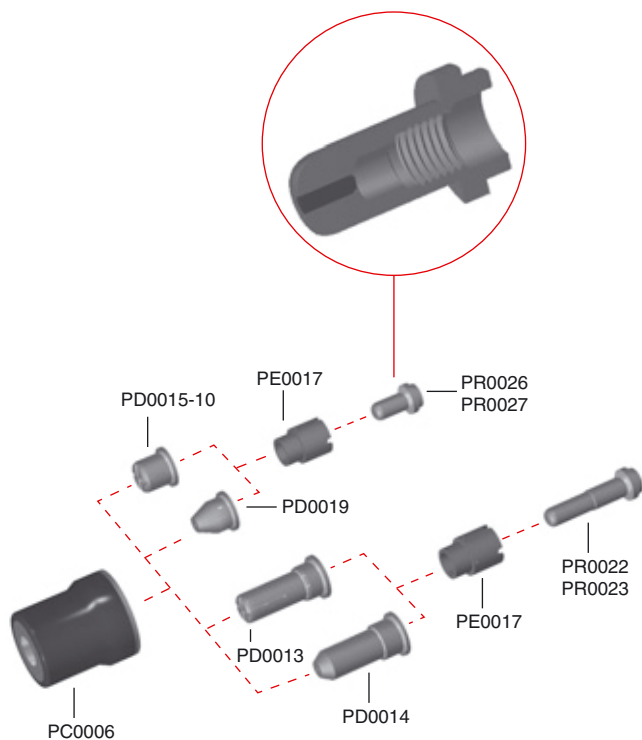

Pt. No.	Description	Pack	Euro	D
PC0006	Outside nozzle (5710121)	4	6,00	A
PD0013	Long tip (020466 - 1370)	10	1,20	A
PD0014	Long conical tip 1306)	10	1,30	A
PD0015-10	Tip CB 50 / HY 40 (020115 - 1304)	10	0,80	A
PE0017	Air diffuser (1510)	2	8,00	A
PR0022	Long electrode - Zr. (1519-Z)	10	1,80	A
PR0023	Long electrode - Hf. (1519-H)	10	2,10	A
PR0026	Electrode - Zr. (1520-Z)	10	1,40	A
PR0027	Electrode - Hf. (1520-H)	10	1,60	A

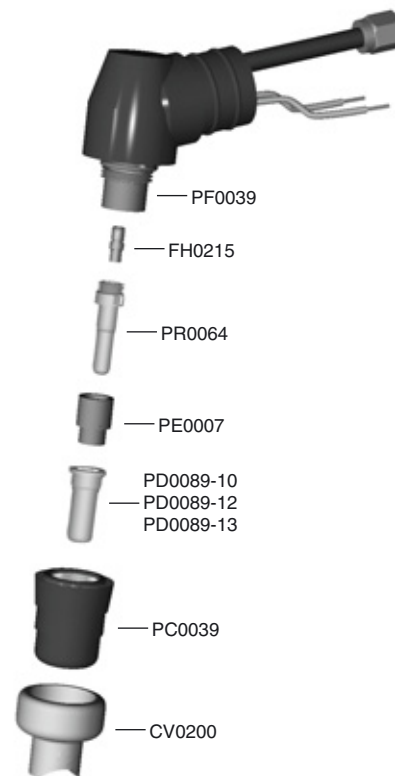

Pt. No.	Description	Pack	Euro	D
CV0200	Long contact cutting attachment	1	6,00	B
FH0215	Air tube long	1	4,00	B
PC0039	Outside nozzle CB CP 90	2	8,00	B
PD0089-10	Tip Ø 1,0 long life CB CP 90	10	1,55	B
PD0089-12	Tip Ø 1,2 long life CB CP 90	10	1,55	B
PD0089-13	Tip Ø 1,3 long life CB CP 90	10	1,55	B
PE0007	Air diffuser HY 40 / CB 50	2	7,50	A
PF0039	Torch head CB CP 90	1	100,00	A
PR0064	Long electrode - Hf. CB 70 (1403)	10	1,60	A



HY 20

HY 40CS/42/43

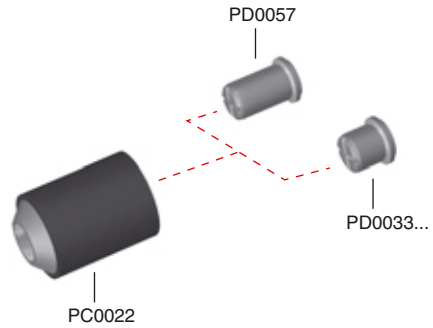
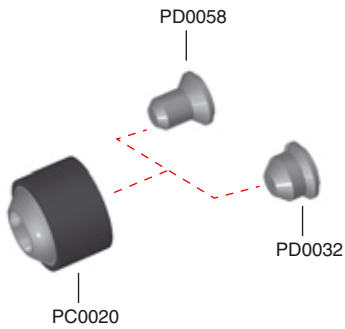

Pt. No.	Description	Pack	Euro	D
PC0020	Outside nozzle (020218)	4	6,60	A
PD0032-08	Tip 0,73 mm - .029 (020299)	10	1,60	A
PD0058	Long tip (020381) HY 20	10	1,80	A

Pt. No.	Description	Pack	Euro	D
CV0061	Carriage	1	21,00	B
PC0022	Outside nozzle (020364)	4	7,20	A
PD0033-09	Tip Ø 0,96 - .038 (020350)	10	1,50	A
PD0033-10	Tip Ø 1,06 - .042 (020395)	10	1,50	A
PD0057	Long tip Ø 0,96 - .038 (020546) HY 42	10	1,90	A



HYPERTHERM® is a registered trademark of Hypertherm Co.
 All consumables relevant to HYPERTHERM® are not original and are manufactured and sold by Trafimet Spa as interchangeable parts for a.m. manufacturers.
 All references and part numbers are for your convenience only.



BINZEL 30

BINZEL 31



Plasma Range

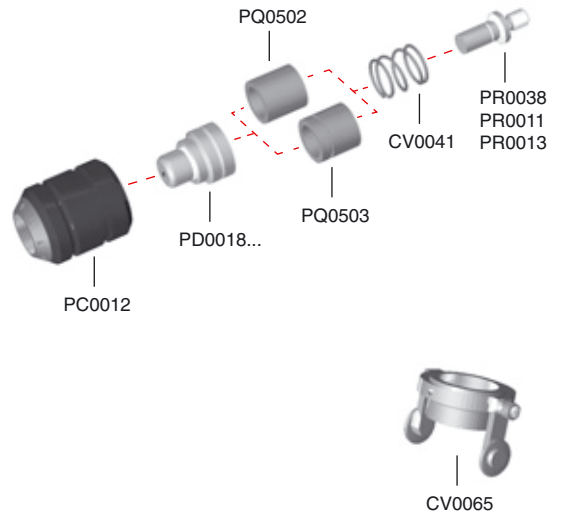
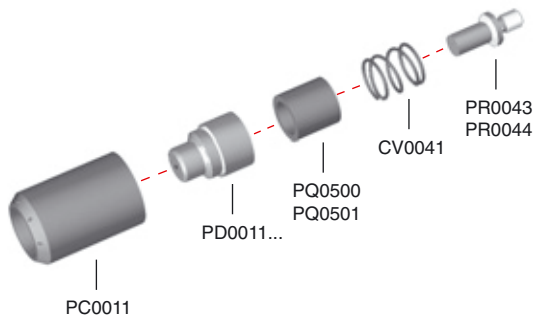

Pt. No.	Description	Pack	Euro	D
CV0041	Spring (744.0024)	10	0,70	A
PC0011	Outside nozzle (744.0011)	10	4,75	A
PD0011-10	Tip Ø 1,0 (744.0010)	10	1,30	A
PD0011-12	Tip Ø 1,2 (744.0061)	10	1,30	A
PQ0500	Insulator (744.0023)	10	2,60	A
PQ0501	Insulator (744.0076)	10	2,80	A
PR0043	Electrode - Zr. (744.0014)	10	1,30	A
PR0044	Electrode - Zr. (744.0013)	10	1,30	A

Pt. No.	Description	Pack	Euro	D
CV0041	Spring (744.0024)	10	0,70	A
CV0065	Carriage until STOCK SOLD OUT	1	17,50	B
PC0012	Outside nozzle (742.0004)	10	7,60	A
PD0018-10	Tip Ø 1,0 (742.0011)	10	1,40	A
PD0018-12	Tip Ø 1,2 (742.0026)	10	1,40	A
PQ0502	Insulator (744.0025)	10	2,80	A
PQ0503	Insulator (744.0038)	10	2,80	A
PR0011	Electrode - Zr. (742.0017)	10	1,30	A
PR0013	Electrode - Zr. (742.0018)	10	1,30	A
PR0038	Electrode - Zr. (742.0016)	10	1,30	A

trafimet®

BINZEL® is a registered trademark of Alexander Binzel GmbH. + Co.Kg.

All consumables relevant to BINZEL® are not original and are manufactured and sold by Trafimet Spa as interchangeable parts for a.m. manufacturers.

All references and part numbers are for your convenience only.



BINZEL 60/80/121

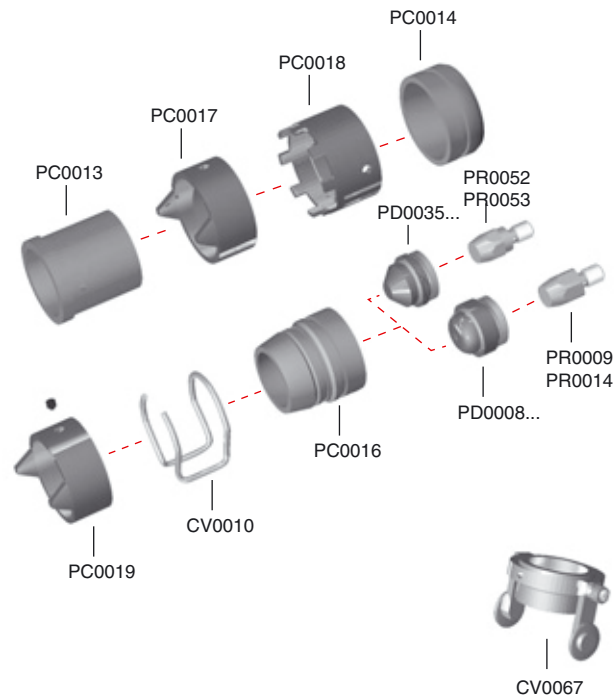

Pt. No.	Description	Pack	Euro	D
CV0010	Stand off guide (743.0149/1394)	10	0,90	A
CV0066	Circle cutting attachment	1	57,00	B
CV0067	Carriage	1	21,00	B
PC0013	Distance nozzle support (743.0126)	10	3,10	A
PC0014	Insulating ring (743.0125)	10	2,40	A
PC0016	Outside nozzle (743.0131)	10	3,30	A
PC0017	Two pins crown shield (743.0168)	10	4,00	A
PC0018	Eight pins crown shield (743.0127)	10	4,00	A
PC0019	Two pins crown shield (743.0267)	10	4,50	A
PD0008-10	Tip Ø 1,0 (743.0122)	10	1,10	A
PD0008-13	Tip Ø 1,3 (743.0142)	10	1,10	A
PD0008-15	Tip Ø 1,5 (743.0132)	10	1,10	A
PD0008-18	Tip Ø 1,8 (743.0209)	10	1,10	A
PD0008-20	Tip Ø 2,0 (743.0355)	10	1,10	A
PD0035-10	Tip Ø 1,0 - 30° (743.0202)	10	1,50	A
PD0035-13	Tip Ø 1,3 - 30° (743.0261)	10	1,50	A
PD0035-15	Tip Ø 1,5 - 30° (743.0203)	10	1,50	A
PD0035-18	Tip Ø 1,8 - 30° (743.0262)	10	1,50	A
PR0009	Electrode - Zr. (743.0077)	10	1,15	A
PR0014	Electrode - Hf. (743.0067)	10	1,30	A

Pt. No.	Description	Pack	Euro	D
PR0052	Electrode - Zr. B 60 / 80 / 121 (743.0425ZR)	10	1,40	A
PR0053	Electrode - Hf. B 60 / 80 / 121 (743.0425HF)	10	1,60	A





SAF CP 40/CP 100

SAF OCP 150



Plasma Range

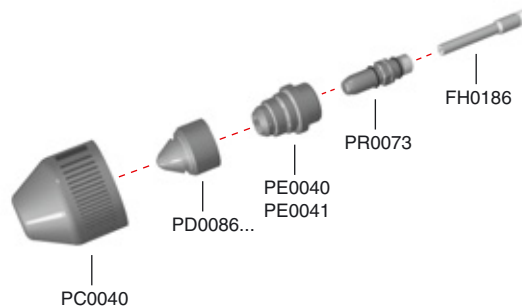

Pt. No.	Description	Pack	Euro	D
CV0010	Stand off guide (743.0149/1394)	10	0,90	A
PC0090	Outside nozzle Saf (0408-2268)	1	14,00	A
PC0091	Outside nozzle Saf (0408-2405)	1	14,00	A
PD0010-10	Tip Ø 1,0 (0408-2261)	10	1,30	A
PD0010-12	Tip Ø 1,2 (0408-2262)	10	1,30	A
PD0010-16	Tip Ø 1,6 (0408-2385)	10	1,30	A
PR0020	Electrode - Zr. (0408-2051)	10	1,10	A
PR0021	Electrode - Hf. (0408-2404)	10	1,30	A

Pt. No.	Description	Pack	Euro	D
FH0186	Air tube SF OCP 150	1	27,00	B
PC0040	Outside nozzle SF OCP 150	2	30,00	B
PD0086-08	Tip Ø 0,8 SAF (2594114)	10	11,00	A
PD0086-10	Tip Ø 1,0 SAF (2594116)	10	11,00	A
PD0086-12	Tip Ø 1,2 SAF (2594138)	10	11,00	A
PD0086-16	Tip Ø 1,6 SAF (2594140)	10	11,00	A
PE0040	Air diffuser SF OCP 150 60A	2	28,50	B
PE0041	Air diffuser SF OCP 150 90-120A	2	28,50	B
PR0073	Electrode Saf OCP 150	10	15,50	B



WTC - WHITNEY SPARE PARTS

WTC

WHITNEY

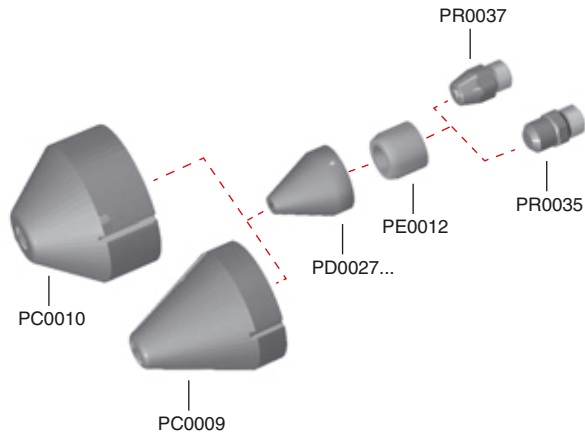
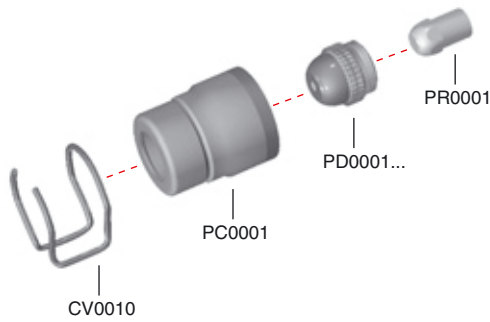

Pt. No.	Description	Pack	Euro	D
CV0010	Stand off guide (743.0149/1394)	10	0,90	A
PC0001	Outside nozzle WTC (0268)	2	6,00	A
PD0001-10	Tip Ø 1,0 (0702)	10	1,40	A
PD0001-12	Tip Ø 1,2 (0703)	10	1,40	A
PD0001-14	Tip Ø 1,4 (0704)	10	1,40	A
PD0001-17	Tip Ø 1,7 (0705)	10	1,40	A
PD0001-20	Tip Ø 2,0 (0706)	10	1,40	A
PR0001	Electrode - Hf. (0189-H)	10	1,55	A

Pt. No.	Description	Pack	Euro	D
PC0009	Conical nozzle 38 mm	2	13,00	A
PC0010	Conical nozzle Ø 48 mm (025.1042)	2	12,00	A
PD0027-16	Tip Ø 1,6 (025.1045)	10	3,70	A
PD0027-24	Tip Ø 2,4 (025.1041)	10	3,70	A
PE0012	Air diffuser (025.1040)	2	29,00	A
PR0035	Electrode Whitney - Hf. (025.1039)	10	3,40	B
PR0037	Electrode Whitney Hf. (025.1044)	10	3,40	B



WTC® is a registered trademark of Welding Torch Company.

WHITNEY® is a registered trademark of Whitney.

All consumables relevant to WTC® and WHITNEY® are not original and are manufactured and sold by Trafimet Spa as interchangeable parts for a.m. manufacturers.

All references and part numbers are for your convenience only.



PANASONIC

KOMATSU



Plasma Range

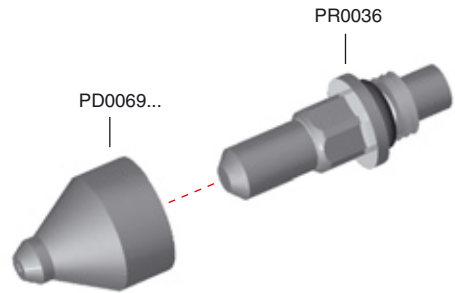
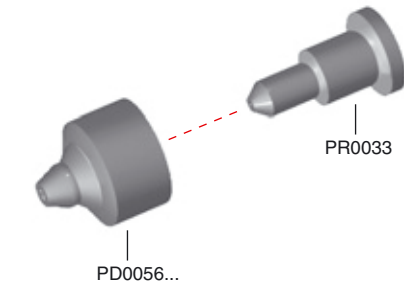
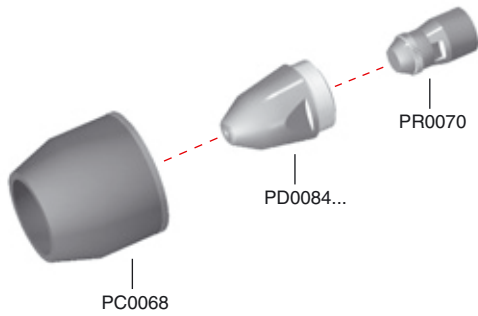

Pt. No.	Description	Pack	Euro	D
PC0009	Conical nozzle 38 mm	2	13,00	A
PC0010	Conical nozzle Ø 48 mm (025.1042)	2	12,00	A
PD0027-16	Tip Ø 1,6 (025.1045)	10	3,70	A
PD0027-24	Tip Ø 2,4 (025.1041)	10	3,70	A
PE0012	Air diffuser (025.1040)	2	29,00	A
PR0035	Electrode Whitney - Hf. (025.1039)	10	3,40	B
PR0037	Electrode Whitney Hf. (025.1044)	10	3,40	B

Pt. No.	Description	Pack	Euro	D
PD0056-04	Tip Komatsu G940 Ø 0,4	10	3,30	A
PD0056-05	Tip Komatsu G940 Ø 0,5	10	3,30	A
PD0056-06	Tip Komatsu G940 Ø 0,6	10	3,30	A
PD0056-07	Tip Komatsu G940 Ø 0,7	10	3,30	A
PD0069-08	Tip Ø 0,8 Komatsu G990	10	4,20	A
PD0069-10	Tip Ø 1,0 Komatsu G990	10	4,20	A
PR0033	Electrode Komatsu G940	10	3,60	B
PR0036	Electrode Komatsu G990	10	5,70	B

PANASONIC® is a registered trademark of Panasonic.

KOMATSU® is a registered trademark of Komatsu.

All consumables relevant to PANASONIC® and KOMATSU® are not original and are manufactured and sold by Trafimet Spa as interchangeable parts for a.m. manufacturers.

All references and part numbers are for your convenience only.



MG - L-TEC - UNION-CARBIDE SPARE PARTS

MG PCH60

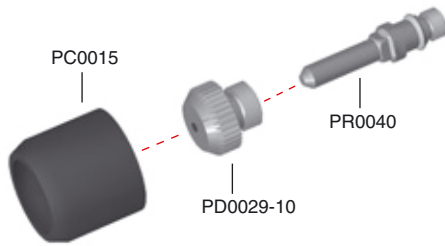

Pt. No.	Description	Pack	Euro	D
PC0015	Outside nozzle MG 60 (753.03314)	4	7,80	B
PD0029-10	Tip Ø 1,0 (753.03311)	10	1,85	A
PR0040	Electrode - Hf. (753.03293)	10	2,90	A

L-TEC

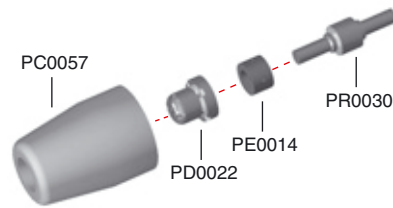

Pt. No.	Description	Pack	Euro	D
PC0057	Outside nozzle (18204)	10	3,50	A
PD0022	Tip (18866)	10	1,30	A
PE0014	Air diffuser (18785)	2	3,00	A
PR0030	Electrode L-Tec31 - Zr. (18205)	10	1,90	A

MG PCH100 - PCM250

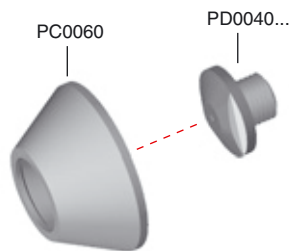

Pt. No.	Description	Pack	Euro	D
PC0060	Ceramic nozzle MG 100 / 250 (445.278)	5	6,00	A
PD0040-10	Tip Ø 1,0 (445.292)	10	1,60	A
PD0040-14	Tip Ø 1,4 (445.291)	10	1,60	A
PD0040-16	Tip Ø 1,6	10	1,60	A
PD0040-20	Tip Ø 2,0 (445.261)	10	1,60	A
PD0040-25	Tip Ø 2,5 (445.327)	10	1,60	A

UNION CARBIDE



Pt. No.	Description	Pack	Euro	D
PD0042-14	Tip Ø 1,4 (1340343)	10	2,00	A
PD0042-16	Tip Ø 1,6 (1340369)	10	2,00	A
PD0042-20	Tip Ø 2,0 (1340370)	10	2,00	A

MESSER GRIESHEIM® is a registered trademark of Messer Griesheim.

L-TEC® is a registered trademark of L-Tec.

UNION-CARBIDE® is a registered trademark of Union-Carbide.

All consumables relevant to MESSER GRIESHEIM®, UNION-CARBIDE® and L-TEC® are not original and are manufactured and sold by Trafimet Spa as interchangeable parts for a.m. manufacturers.

All references and part numbers are for your convenience only.

Plasma Range

trafimet®



TD PCH 20

TD PCH 25



Plasma Range

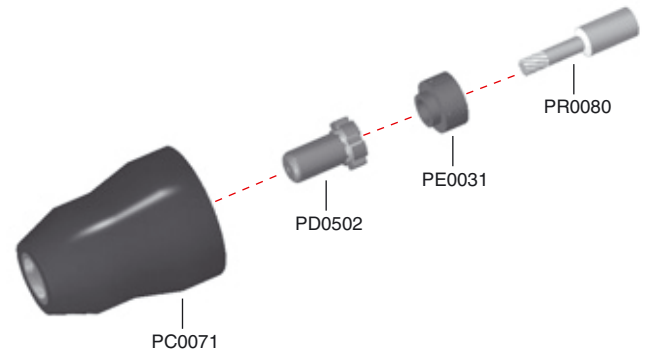
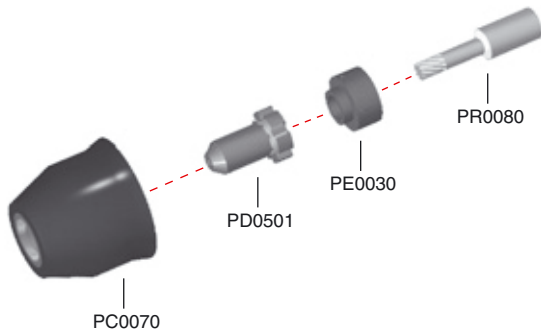

COMPLETE TORCH

Pt. No.	Description	Pack	Euro	D
PA0500	Plasma TD PCH 25 torch 4m	1	235,00	B
PA0501	Plasma TD PCH 35 torch 7,5m	1	260,00	B

Pt. No.	Description	Pack	Euro	D
PC0070	Outside nozzle TD 20 (8-3214)	2	8,60	A
PD0501	Tip TD 20 8-3218	10	1,40	A
PE0030	Air diffuser TD 20 8-3233	2	3,60	A
PF0047	Torch head TD PCH 20 8-3320	1	180,00	B
PR0080	Electrode TD PCH 20 / 25 / 35 9-6006	10	2,40	A

Pt. No.	Description	Pack	Euro	D
PC0071	Outside nozzle TD 25/26/28/38/40 (9-6003)	2	8,60	A
PD0502	Tip TD 25	10	1,40	A
PE0031	Air diffuser TD 25 / 35 9-6007	2	10,00	A
PF0042	Torch head TD PCH 25/28/35	1	108,00	B
PH0025	Cable assembly 4m	1	88,00	B
PH0026	Cable assembly 7,5m	1	140,00	B
PR0080	Electrode TD PCH 20 / 25 / 35 9-6006	10	2,40	A

THERMAL DYNAMICS® is a registered trademark of Thermal Dynamics Co.

All consumables relevant to THERMAL DYNAMICS® are not original and are manufactured and sold by Trafimet Spa as interchangeable parts for a.m. manufacturers.

All references and part numbers are for your convenience only.



TD PCH 35

TD PCH 51



COMPLETE TORCH

Pt. No.	Description	Pack	Euro	D
PA0505	Plasma TD PCH 35 torch 7,5m	1	300,00	B

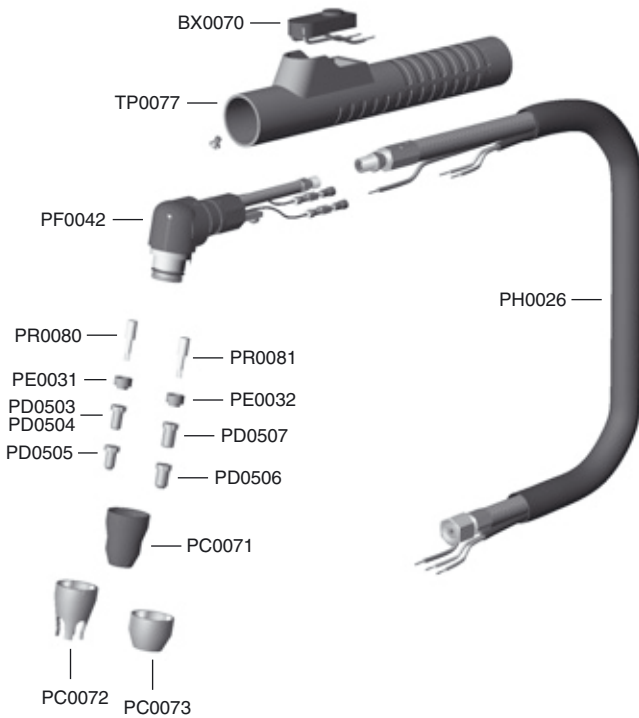

COMPLETE TORCH

Pt. No.	Description	Pack	Euro	D
PA0510	Plasma TD PCH 51 torch 7,5m	1	355,00	B

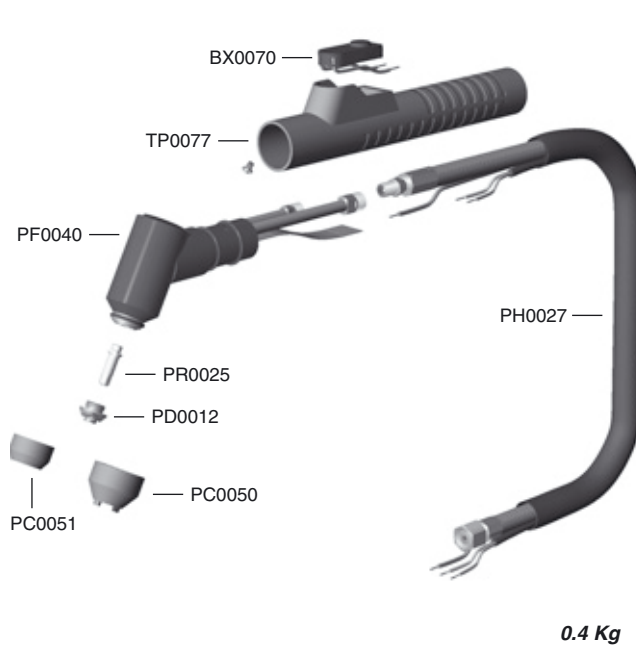

Pt. No.	Description	Pack	Euro	D
PC0071	Outside nozzle TD 25/26/28/38/40 (9-6003)	2	8,60	A
PC0072	Stand-off guide TD 35 (9-6004)	2	7,75	A
PC0073	Stand-off guide TD 35 (9-6503)	2	6,66	A
PD0503	Tip TD 35 9-6000	10	1,40	A
PD0504	Tip TD 35 9-6002	10	1,40	A
PD0505	Tip TD 35 9-6001	10	1,40	A
PD0506	Tip TD 35 9-6501	10	1,40	A
PD0507	Tip TD 35 9-6500	10	1,40	A
PE0031	Air diffuser TD 25 / 35 9-6007	2	10,00	A
PE0032	Air diffuser TD 35 9-6507	2	10,00	A
PF0042	Torch head TD PCH 25/28/35	1	108,00	B
PH0026	Cable assembly 7,5m	1	140,00	B
PR0080	Electrode TD PCH 20 / 25 / 35 9-6006	10	2,40	A
PR0081	Electrode TD PCH 35 9-6506	10	2,50	A

Pt. No.	Description	Pack	Euro	D
PC0050	Crown nozzle (8-5526)	5	4,00	A
PC0051	Outside nozzle (9-5630)	10	2,85	A
PD0012-09	Tip Ø 0,96 - .038 (9-5718)	10	1,15	A
PD0012-11	Tip Ø 1,1 - .043 (9-5631)	10	1,10	A
PD0012-12	Tip Ø 1,2 - .047 (98-3321)	10	1,15	A
PD0012-20	Tip Ø 2,0 - .079 (9-5724)	10	1,15	A
PF0040	Torch head TD PCH 51	1	55,00	B
PH0027	Cable assembly 7,5m	1	150,00	B
PR0025	Electrode TD 51 - Hf. (9-5633)	10	1,30	A





TD PCH 52

TD PCH 60



Plasma Range

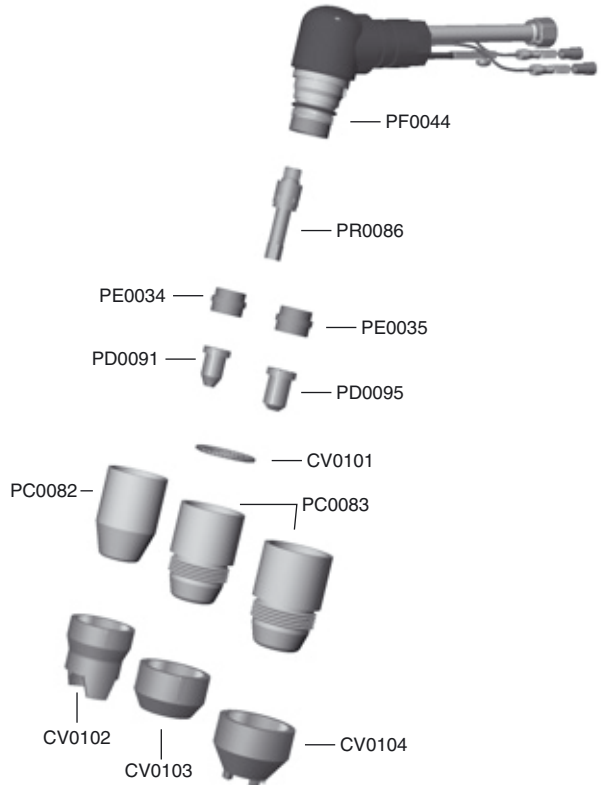
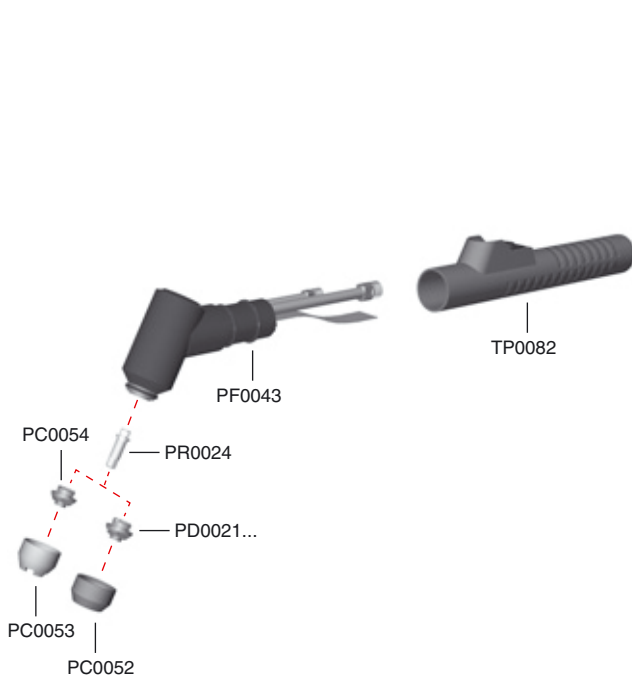

Pt. No.	Description	Pack	Euro	D
PC0052	Outside nozzle (9-5617)	10	2,85	A
PC0053	Crown nozzle (9-5694)	10	4,00	A
PD0021-08	Tip Ø 0,8 - .031 (9-5702)	10	1,30	A
PD0021-11	Tip Ø 1,1 - .043 (9-5618)	10	1,30	A
PD0021-12	Tip Ø 1,2 - .047 (9-5707)	10	1,30	A
PD0021-15	Tip Ø 1,5 - .059 (9-5708)	10	1,30	A
PD0054-20	Tip Ø 2,0 9-5709	10	2,50	A
PD0054-24	Tip Ø 2,4 9-5710	10	2,50	A
PF0043	Torch head TD PCH 52	1	260,00	B
PR0024	Electrode TD 52 - Hf. (9-5619)	10	1,60	A
TP0082	Handle red Ø 28,5	1	18,00	A

Pt. No.	Description	Pack	Euro	D
CV0101	Coil spring TD PCH 60-75-76-80	10	1,00	A
CV0102	Double pointed spacer	2	14,00	B
CV0103	Shield cup PCH 60-75-76-80	2	15,00	B
CV0104	Shield cup PCH 60-75-76-80	2	12,00	B
PC0082	Outside nozzle TD PCH 60-75-76-80-100XL 8-7500	2	21,50	B
PC0083	Outside nozzle TD PCH 60-75-76-80-100XL 8-7498	2	18,75	B
PD0091-10	Tip Ø 1,0 TD PCH 60-75-76-80	10	1,55	B
PD0091-12	Tip Ø 1,2 TD PCH 60-75-80	10	1,60	B
PD0095-19	Gouging tip Ø 1,9 TD PCH 60-75-76-80	10	1,55	B
PE0034	Air diffuser TD PCH 60-75-76-80 8-7501	2	10,50	B
PE0035	Gouging air diffuser TD PCH 60-75-76-80 8-7508	2	10,75	B
PF0044	Torch head TD PCH 60-80 9-8075	1	210,00	B
PR0086	Electrode TD PCH 60-75-76-80 8-7502	10	4,00	A

THERMAL DYNAMICS® is a registered trademark of Thermal Dynamics Co.

All consumables relevant to THERMAL DYNAMICS® are not original and are manufactured and sold by Trafimet Spa as interchangeable parts for a.m. manufacturers.

All references and part numbers are for your convenience only.



TD PCH 70

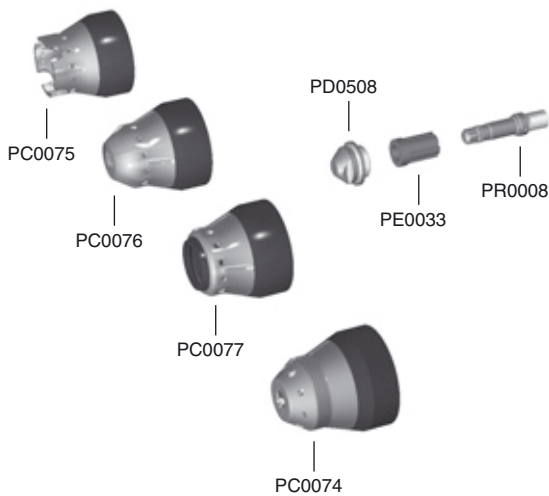

Pt. No.	Description	Pack	Euro	D
PC0074	Outside nozzle TD 70 (9-6024)	2	30,00	B
PC0075	Outside nozzle TD 70 (9-6017)	2	20,00	A
PC0076	Outside nozzle TD 70 (9-6016)	2	20,00	A
PC0077	Outside nozzle TD 70 (9-6018)	2	17,00	A
PD0508-09	Tip TD 70 9-6008	10	1,90	A
PD0508-12	Tip TD 70 9-6009	10	1,90	A
PE0033	Air diffuser TD 70 9-6022	2	22,50	B
PR0008	Electrode TD 70 9-6019	10	4,30	A

TD PCH 75

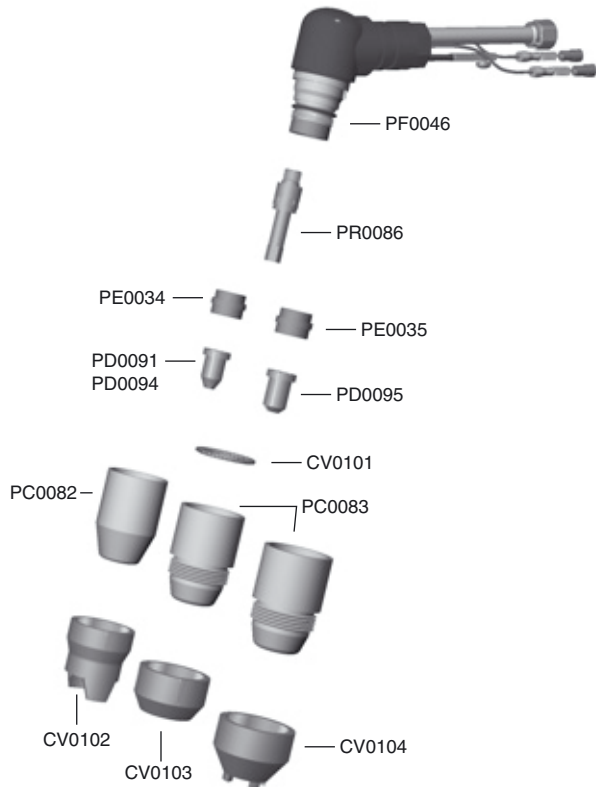

Pt. No.	Description	Pack	Euro	D
CV0101	Coil spring TD PCH 60-75-76-80	10	1,00	A
CV0102	Double pointed spacer	2	14,00	B
CV0103	Shield cup PCH 60-75-76-80	2	15,00	B
CV0104	Shield cup PCH 60-75-76-80	2	12,00	B
PC0082	Outside nozzle TD PCH 60-75-76-80-100XL 8-7500	2	21,50	B
PC0083	Outside nozzle TD PCH 60-75-76-80-100XL 8-7498	2	18,75	B
PD0091-10	Tip Ø 1,0 TD PCH 60-75-76-80	10	1,55	B
PD0091-12	Tip Ø 1,2 TD PCH 60-75-80	10	1,60	B
PD0094-12	Tip Ø 1,2 TD PCH 75	10	1,55	B
PD0095-19	Gouging tip Ø 1,9 TD PCH 60-75-76-80	10	1,55	B
PE0034	Air diffuser TD PCH 60-75-76-80 8-7501	2	10,50	B
PE0035	Gouging air diffuser TD PCH 60-75-76-80 8-7508	2	10,75	B
PF0046	Torch head TD PCH 75-76 8-7510	1	180,00	B
PR0086	Electrode TD PCH 60-75-76-80 8-7502	10	4,00	A





TD PCH 76

TD PCH 80



Plasma Range

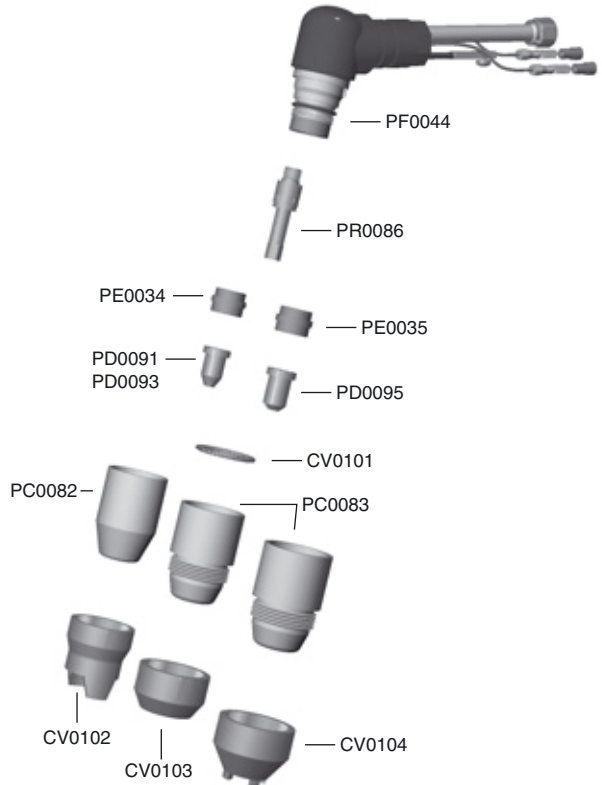
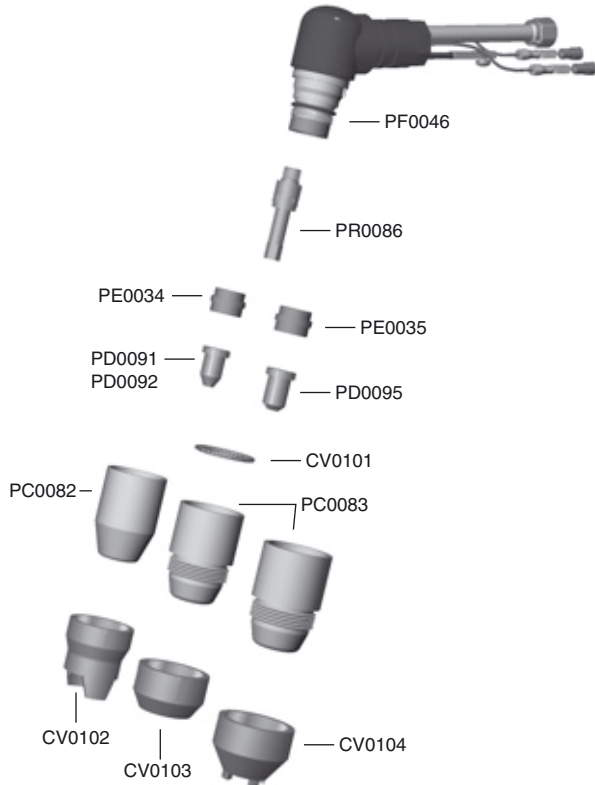

Pt. No.	Description	Pack	Euro	D
CV0101	Coil spring TD PCH 60-75-76-80	10	1,00	A
CV0102	Double pointed spacer	2	14,00	B
CV0103	Shield cup PCH 60-75-76-80	2	15,00	B
CV0104	Shield cup PCH 60-75-76-80	2	12,00	B
PC0082	Outside nozzle TD PCH 60-75-76-80-100XL 8-7500	2	21,50	B
PC0083	Outside nozzle TD PCH 60-75-76-80-100XL 8-7498	2	18,75	B
PD0091-10	Tip Ø 1,0 TD PCH 60-75-76-80	10	1,55	B
PD0092-13	Tip Ø 1,3 TD PCH 76	10	1,55	B
PD0095-19	Gouging tip Ø 1,9 TD PCH 60-75-76-80	10	1,55	B
PE0034	Air diffuser TD PCH 60-75-76-80 8-7501	2	10,50	B
PE0035	Gouging air diffuser TD PCH 60-75-76-80 8-7508	2	10,75	B
PF0046	Torch head TD PCH 75-76 8-7510	1	180,00	B
PR0086	Electrode TD PCH 60-75-76-80 8-7502	10	4,00	A

Pt. No.	Description	Pack	Euro	D
CV0101	Coil spring TD PCH 60-75-76-80	10	1,00	A
CV0102	Double pointed spacer	2	14,00	B
CV0103	Shield cup PCH 60-75-76-80	2	15,00	B
CV0104	Shield cup PCH 60-75-76-80	2	12,00	B
PC0082	Outside nozzle TD PCH 60-75-76-80-100XL 8-7500	2	21,50	B
PC0083	Outside nozzle TD PCH 60-75-76-80-100XL 8-7498	2	18,75	B
PD0091-10	Tip Ø 1,0 TD PCH 60-75-76-80	10	1,55	B
PD0091-12	Tip Ø 1,2 TD PCH 60-75-80	10	1,60	B
PD0093-14	Tip Ø 1,4 TD PCH 80	10	1,60	B
PD0095-19	Gouging tip Ø 1,9 TD PCH 60-75-76-80	10	1,55	B
PE0034	Air diffuser TD PCH 60-75-76-80 8-7501	2	10,50	B
PE0035	Gouging air diffuser TD PCH 60-75-76-80 8-7508	2	10,75	B
PF0044	Torch head TD PCH 60-80 9-8075	1	210,00	B
PR0086	Electrode TD PCH 60-75-76-80 8-7502	10	4,00	A

Thermal Dynamics® is a registered trademark of Thermal Dynamics Co.

All consumables relevant to Thermal Dynamics® are not original and are manufactured and sold by Trafimet Spa as interchangeable parts for a.m. manufacturers.

All references and part numbers are for your convenience only.



TD PCH 100

TD PCH 150

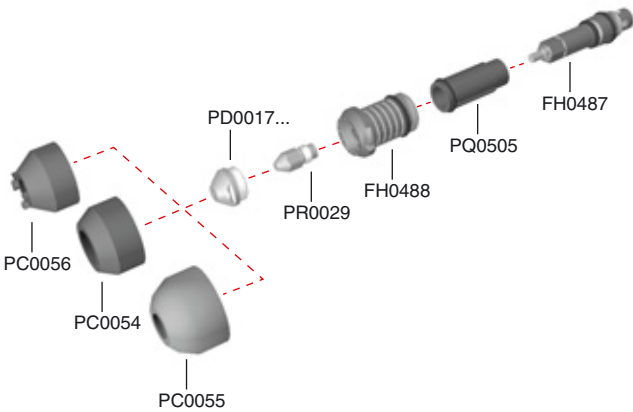

Pt. No.	Description	Pack	Euro	D
FH0487	Electrode holder PCH 100 8-1108	1	43,00	B
FH0488	Tip holder PCH 100 8-1106	1	42,00	B
PC0054	Outside nozzle (9-4345)	10	4,50	A
PC0055	Crown nozzle (8-1100)	10	4,50	A
PC0056	Crown nozzle (8-1101)	10	5,00	A
PD0017-10	Tip Ø 1,0 (9-4343)	10	1,80	A
PD0017-13	Tip Ø 1,3 (9-4342)	10	1,80	A
PD0017-15	Tip Ø 1,5 (9-4341)	10	1,80	A
PQ0505	Gas distributor PCH 100 9-4339	1	55,00	A
PR0029	Electrode TD 100 - Hf. (9-4340)	10	1,70	A

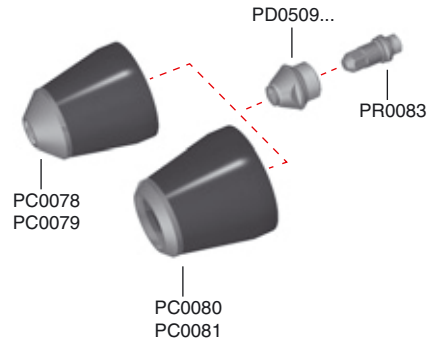

Pt. No.	Description	Pack	Euro	D
PC0078	Outside nozzle TD 150 (9-5750)	2	12,39	A
PC0079	Outside nozzle TD 150 (9-5790)	2	24,02	A
PC0080	Outside nozzle TD 150 (9-5774)	2	14,62	A
PC0081	Outside nozzle TD 150 (9-5778)	2	12,39	A
PD0509-11	Tip TD 150 9-5748	10	3,10	A
PD0509-14	Tip TD 150 9-5747	10	3,10	A
PD0509-18	Tip TD 150 9-5746	10	3,10	A
PR0083	Electrode TD PCH 150 9-5749	10	3,90	A

