

Hypertherm®

MAX200 Machine torch parts

MAX200 consumables



MAX200



128380 - Standard body - 2" sleeve



128365 - Stainless steel body

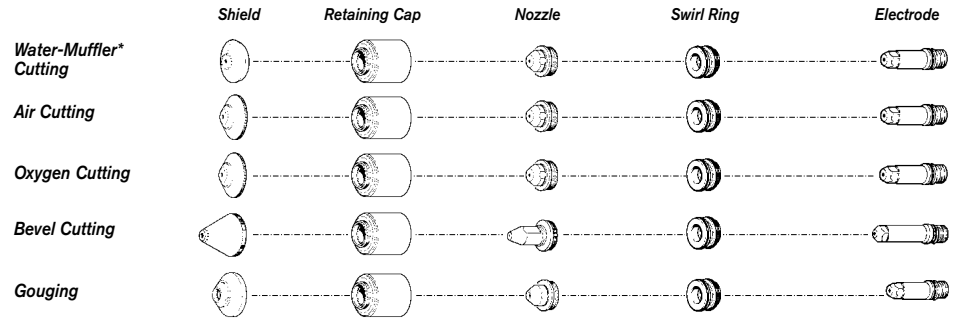

APPLICATION	PLASMA GAS	CONSUMABLE DESCRIPTION	PART NUMBER				QUANTITY PER PACKAGE	
			200 AMP BEVEL	200 AMPS	100 AMPS	40 AMPS		
CUTTING	Oxygen	Electrode-Standard	120258	220021	120547		5	
		Electrode-SilverPlus		220083			5	
		Swirl Ring	120833	020604	020617		1	
		Nozzle	120259	020605	020616		5	
		Retaining Cap	020423	020423	020423		1	
		Retaining Cap, Ohmic	120837	120837	120837		1	
		Shield	120260	020424	020448		1	
		(Water Muffler*)	Shield		020566	020618		1
		Air	Electrode		220021	120547	120667	5
			Swirl Ring		020607	020607	020613	1
	Nozzle			020608	020611	020689	5	
	Retaining Cap			020423	020423	020423	1	
	Retaining Cap, Ohmic			120837	120837	120837	1	
	Shield			020424	020448	020688	1	
	(Water Muffler*)		Shield		020566	020618		1
	Argon/Hydrogen		Electrode		020415	020415		5
			Swirl Ring		020607	020607		1
			Nozzle		020608	020611		5
		Retaining Cap		020423	020423		1	
		Retaining Cap, Ohmic		120837	120837		1	
Shield			020602	020448		1		
Nitrogen	Electrode		020415			5		
	Swirl Ring		020607			1		
	Nozzle		020608			5		
	Retaining Cap		020423			1		
	Retaining Cap, Ohmic		120837			1		
	Shield		020424			1		
(Water Muffler*)	Shield		020566			1		
GOUGING	Air	Electrode		220021			5	
		Swirl Ring		020607			1	
		Nozzle		020615			5	
		Retaining Cap		020423			1	
		Shield		020485			1	
	Argon/Hydrogen	Electrode		020415			5	
		Swirl Ring		020607			1	
		Nozzle		020615			5	
		Retaining Cap		020423			1	
		Shield		020485			1	

* Water muffler cannot be used with 2" 120356 stainless steel torch or with Ohmic height sensing.

MAX200 machine torch assembly

128380 - Standard body - 2" sleeve
 128364 - Optional body - 1 1/4" sleeve

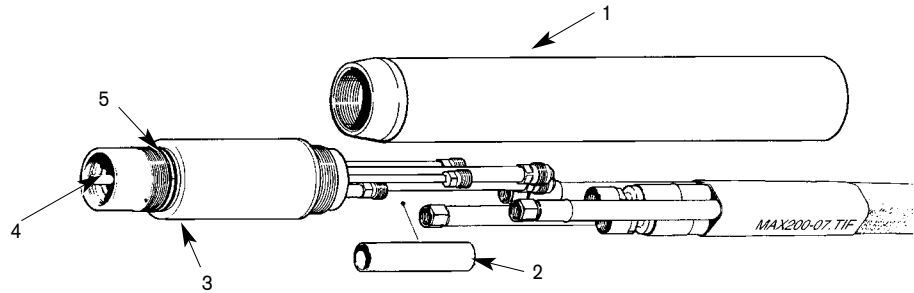

128380 - Standard body - 2" sleeve

ITEM NUMBER	STANDARD BODY (2") PART NO.	DESCRIPTION	OPTIONAL BODY (1 1/4") PART NO.
	128380^	MAX200 Machine Torch Assembly	128364
	028383*	Leads, Torch, 25' / 7.6 m	028383
	028384*	Leads, Torch, 50' / 15.2 m	028384
1	120894	Torch Mounting Sleeve	020431
2	020536	Lead Insulator, 5/8 x 2.5"	020536
3	120584	MAX200/HT2000 Machine Torch Main Body	120584
4	020963	Water Tube, Electrode Cooling, Standard	020963
4	120257	Water Tube, Electrode Cooling, Extended	120257
5	044027	O-Ring: Buna 70 Duro 1.301 x .070	044027^

^ Assembly includes consumables

* Other lead lengths available.
 Consult your Operating Manual.

128365 - Stainless steel body

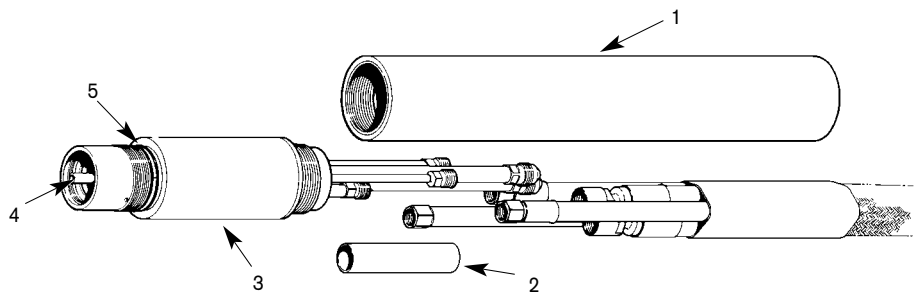

128365 - Stainless steel body

ITEM NUMBER	PART NO.	DESCRIPTION
	128365^	MAX200 Machine Torch Assembly
	120356	MAX200/HT2000 Machine Torch Main Body
	028384*	Leads, Torch, 50' / 15.2 m
1	020041	Torch Mounting Sleeve
2	020536	Lead Insulator, 5/8 x 2.5"
3	028383*	Leads, Torch, 25' / 7.6 m
4	020963	Water Tube, Electrode Cooling, Standard
4	120257	Water Tube, Electrode Cooling, Extended
5	044027	O-Ring: Buna 70 Duro 1.301 x .070

^ Assembly includes consumables

* Other lead lengths available.
 Consult your Operating Manual.